

- Flashing and Static Beacons p11-1
- Xenon Strobe Beacons p11-9
- Rotating Beacons p11-17
- Sounders and Sounder Beacons p11-21
- Speech and Tone Sounders p11-43
- Motor Sirens p11-44
- Buzzers and Horns p11-49
- Bells p11-52
- Hand Operated Sirens and Horns p11-53
- Marine Beacons and Sounders p11-54
- Loud Speakers p11-57
- Traffic Lights and Status Indicators p11-58
- Aircraft Warning Lights p11-62

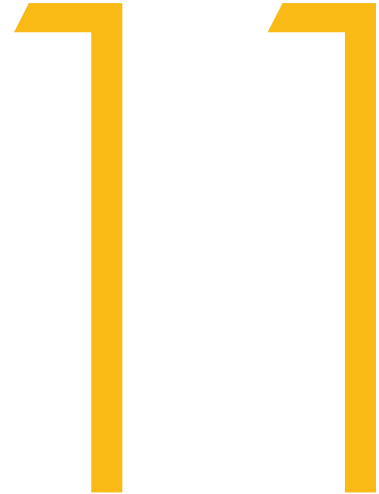

Microlamp

- High output LED or incandescent bulb
- Steady or flashing light
- Audible signal option with continuous or intermittent sound
- Multi-voltage
- Double insulated
- IP54 (IP30 with audible option)



Microlamp



Microlamp A

| Order Code | Voltage | Current | Weight (kg) |
|------------|---------|---------|-------------|
|------------|---------|---------|-------------|

Microlamp LED
continuous or triple flash – selectable by terminals

| | | | |
|-------------|------------------|-------|------|
| SIR15L0240* | 12-24VAC/DC ±10% | 180mA | 0.12 |
| SIR15L0480* | 48VAC/DC ±10% | 115mA | 0.12 |
| SIR15L2400* | 90-240VAC ±10% | 40mA | 0.12 |

Microlamp A LED with audible signal
continuous or pulsing in synchronisation with the light

| | | | |
|-------------|------------------|-------|------|
| SIR603L024* | 12-24VAC/DC ±10% | 180mA | 0.19 |
| SIR603L048* | 48VAC/DC ±10% | 115mA | 0.19 |
| SIR603L240* | 90-240VAC ±10% | 40mA | 0.19 |

Microlamp L MT (bulb must be ordered separately)
Continuous or flashing – selectable by terminals

| | | | |
|-------------|-----------|-----------|------|
| SIR1504840* | 12-48VDC | 420-105mA | 0.12 |
| SIR1524040* | 24-240VAC | 215-20mA | 0.12 |

*Specify colour A = Amber, B = Blue, C = Clear, G = Green, R = Red, Y = Yellow

| Order Code | Voltage | Luminous Intensity |
|------------|---------|--------------------|
|------------|---------|--------------------|

Bulbs – BA15D 5W
Bulb MUST be ordered separately to suit operating voltage

| | | |
|------------|------|---------|
| SIR3906012 | 12V | 25Cd(p) |
| SIR3906024 | 24V | 18Cd(p) |
| SIR3906048 | 48V | 8Cd(p) |
| SIR3906110 | 110V | 3Cd(p) |
| SIR3906240 | 240V | 2Cd(p) |

Microlamp A FCL (supplied with bulb) with audible
continuous or pulsing in synchronisation with the light

| | | | |
|-------------|----------|-------|---------|
| SIR6030121* | 12VAC/DC | 420mA | 25Cd(p) |
| SIR6030241* | 24VAC/DC | 215mA | 18Cd(p) |
| SIR6030481* | 48VAC/DC | 105mA | 8Cd(p) |
| SIR6031105* | 110VAC | 45mA | 3Cd(p) |
| SIR6032405* | 240VAC | 20mA | 2Cd(p) |

*Specify colour A = Amber, B = Blue, C = Clear, G = Green, R = Red, Y = Yellow

Accessories and Spare Parts

| Order Code | Description |
|-------------|----------------------------------|
| SIR3500002* | Microlamp lens (*Specify colour) |

Specifications:

| | |
|-------------------|--|
| Flash rate: | LED – 140fpm ±10 Incandescent bulb -110fpm ±20 |
| Protection: | IP54 IP30 with audible signal |
| Sound output: | 72dB @ 1m |
| Tone: | 2700Hz |
| Duty: | Continuous |
| Temp rating (°C): | -30 to +50 |
| Cable entry: | M16 - side entry |
| Construction: | Polycarbonate base and lens |

Microlamp

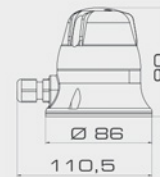

Microlamp A

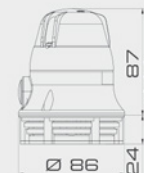

Dimensions in mm

CTL series

- High output LED
- 3 sizes
- Steady or flashing light
- Audible signal option with continuous or intermittent sound
- Multi-voltage
- Double insulated
- IP54 (IP30 with audible option)

Specifications:

| | |
|-------------------|-----------------------------|
| Flash rate: | 140fpm ±10 |
| Sound output: | 72dB @ 1m |
| Tone: | 2700Hz |
| Protection: | IP54 |
| Duty: | IP30 with audible signal |
| Temp rating (°C): | Continuous |
| Cable entry: | -30 to +50 |
| Construction: | Bottom entry terminals |
| | Polycarbonate base and lens |



CTL600



CTL900



CTL1200

| Order Code | Voltage | Current | Weight (kg) |
|--|------------------|---------|-------------|
| CTL600 LED continuous or triple flash – selectable by terminals | | | |
| SIR16L0240* | 12-24VAC/DC ±10% | 170mA | 0.11 |
| SIR16L2400* | 90-240VAC ±10% | 30mA | |
| CTL900 LED continuous or triple flash – selectable by terminals | | | |
| SIR17L0240* | 12-24VAC/DC ±10% | 320mA | 0.19 |
| SIR17L2400* | 90-240VAC ±10% | 75mA | |
| CTL1200 LED continuous or triple flash – selectable by terminals | | | |
| SIR18L0240* | 12-24VAC/DC ±10% | 320mA | 0.32 |
| SIR18L2400* | 90-240VAC ±10% | 75mA | |
| CTL900 A LED with audible signal continuous or pulsing in synchronisation with the light | | | |
| SIR606L024* | 12-24VAC/DC ±10% | 320mA | 0.16 |
| SIR606L240* | 90-240VAC ±10% | 75mA | |

*Specify colour A = Amber, B = Blue, C = Clear, G = Green, R = Red, Y = Yellow

CTL 600



kg 0,08

CTL 900
CTL A 900

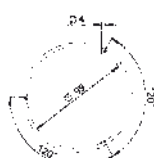
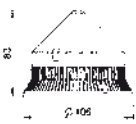

kg 0,16

CTL 1200

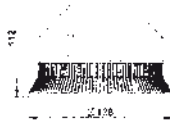

kg 0,24

Dimensions in mm

Accessories and Spare Parts

| Order Code | Description |
|-------------|--------------------------------|
| SIR3160001* | CTL600 lens (*Specify colour) |
| SIR3170001* | CTL900 lens (*Specify colour) |
| SIR3180001* | CTL1200 lens (*Specify colour) |

Ovolux SMD

- High output LED
- 4 functions - steady, single, double or triple flashing light
- Surface mount with cable entry or version to suit mounting accessories
- Multi-voltage
- Double insulated
- IP65



| Order Code | Voltage | Current | Weight (kg) |
|---|------------------|---------|-------------|
| Ovolux R LED (for use with mounting accessories) 4 functions – selectable by DIP switches | | | |
| SIR01L0240* | 12-24VAC/DC ±10% | 180mA | 0.15 |
| SIR01L2400* | 90-240VAC ±10% | 30mA | |
| Ovolux M16 LED 4 functions – selectable by DIP switches | | | |
| SIR01L0241* | 12-24VAC/DC ±10% | 180mA | 0.24 |
| SIR01L2401* | 90-240VAC ±10% | 40mA | |

*Specify colour A = Amber, B = Blue, C = Clear, G = Green, R = Red, Y = Yellow

Accessories and Spare Parts

| Order Code | Description |
|-------------|---|
| SIR00L0090 | AFF female-female adapter Basic adapter to mount all accessories |
| SIR00L0091 | BS foot |
| SIR00L0092 | PR extension stem (stackable) |
| SIR00L0093 | BP1 single wall support |
| SIR00L0094 | BP2 double wall support |
| SIR00L0096 | PG9 mounting box with PG9 cable entry |
| SIR3001001* | Ovolux lens (*Specify colour) |

OVO Mounting Systems

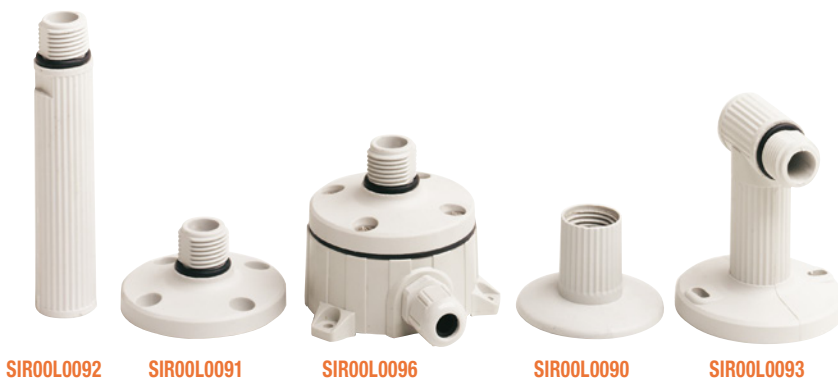

SIR00L0092 SIR00L0091 SIR00L0096 SIR00L0090 SIR00L0093

Specifications:

| | |
|-------------------|---|
| Flash rate: | 1 x 120fpm ±10 2 x 90fpm ±10 3 x 140fpm ±10 |
| Protection: | IP65 |
| Duty: | Continuous |
| Temp rating (°C): | -30 to +50 |
| Cable entry: | M16 side entry or through base |
| Construction: | Polycarbonate base and lens |

Ovolux R

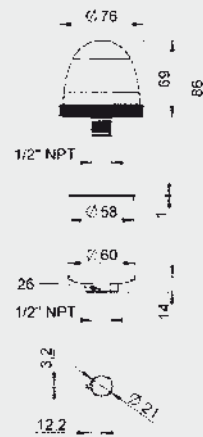

Ovolux M16

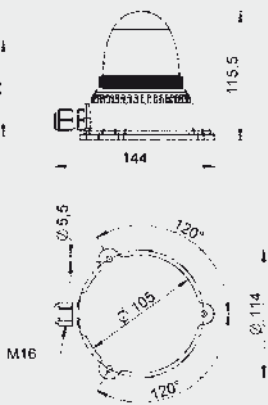

SIR00L0090

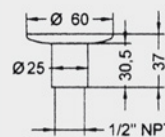

SIR00L0093

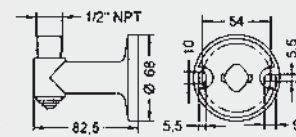

SIR00L0091

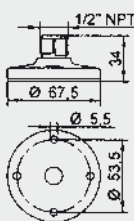

SIR00L0094

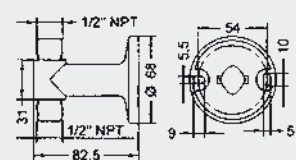

SIR00L0092

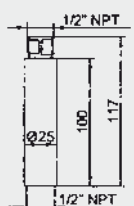

SIR00L0096

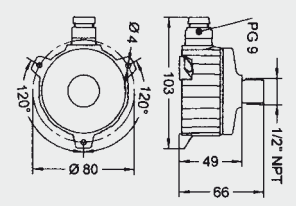

Dimensions in mm

Miniflash

- Incandescent bulb or LED
- Steady or flashing light (LED only)
- Multi-voltage (incandescent only)
- 3 mounting options
- Double insulated
- IP54



Miniflash S



Miniflash P



Miniflash E

Specifications:

| | |
|-------------------|---|
| Flash rate: | Incandescent – 110fpm ±20 LED – 150fpm ±20 |
| Protection: | IP54 |
| Duty: | Continuous |
| Temp rating (°C): | -30 to +50 |
| Cable entry: | M16 or through mounting base |
| Construction: | Polycarbonate base and lens |

| Order Code | Description | Voltage | Current | Weight (kg) |
|---|-------------|----------|---------|-------------|
| Miniflash LED continuous or flashing – selectable by terminals (E27 version is flashing only) | | | | |
| SIR03L0240* | Surface | 24VAC/DC | 180mA | 0.45 |
| SIR03L0480* | | 48VAC/DC | 180mA | |
| SIR03L1100* | | 110VAC | 40mA | |
| SIR03L2400* | | 240VAC | 40mA | |
| SIR03L0241* | Single bolt | 24VAC/DC | 180mA | 0.40 |
| SIR03L0481* | | 48VAC/DC | 180mA | |
| SIR03L1101* | | 110VAC | 40mA | |
| SIR03L2401* | | 240VAC | 40mA | |
| SIR03L0242* | E27 | 24VAC/DC | 180mA | 0.35 |
| SIR03L0482* | | 48VAC/DC | 180mA | |
| SIR03L1102* | | 110VAC | 40mA | |
| SIR03L2402* | | 240VAC | 40mA | |

Miniflash L MT (bulb must be ordered separately) flashing only

| Order Code | Description | Voltage | Current | Weight (kg) |
|-------------|-------------|-----------|-----------|-------------|
| SIR1304840* | Surface | 12-24VDC | 2.2-0.52A | 0.40 |
| SIR1324040* | | 24-240VAC | 1.1-0.1A | |
| SIR1304841* | Single bolt | 12-24VDC | 2.2-0.52A | 0.35 |
| SIR1324041* | | 24-240VAC | 1.1-0.1A | |
| SIR1304842* | E27 | 12-24VDC | 2.2-0.52A | 0.30 |
| SIR1324042* | | 24-240VAC | 1.1-0.1A | |

*Specify colour A = Amber, B = Blue, C = Clear, G = Green, R = Red

| Order Code | Voltage | Luminous Intensity |
|---|---------|--------------------|
| Bulbs – BA15D 25W Bulb MUST be ordered separately to suit operating voltage | | |
| SIR3926012 | 12V | 150Cd(p) |
| SIR3926024 | 24V | 200Cd(p) |
| SIR3926048 | 48V | 270Cd(p) |
| SIR3926110 | 110V | 30Cd(p) |
| SIR3926240 | 240V | 45Cd(p) |

Accessories and Spare Parts

| Order Code | Description |
|-------------|----------------------------------|
| SIR3300001* | Miniflash lens (*Specify colour) |

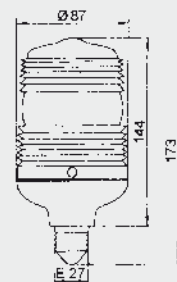
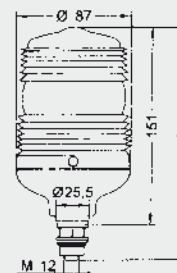
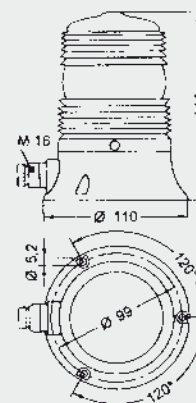

Dimensions in mm

Rotallarm S

- Multi-function high output LED
- Steady or flashing light (LED only)
- Two voltage ranges
- Double insulated
- IP65
- HD heavy duty version with aluminium base



Rotallarm S

Rotallarm HD

| Order Code | Voltage | Current | Weight (kg) |
|---|-------------------|---------|-------------|
| Rotallarm S LED Steady, Flashing or Rotating | | | |
| SIR05L0240* | 12/24V AC/DC ±10% | 180mA | 0.5 |
| SIR05L2400* | 90-240VAC ±10% | 40mA | |
| Rotallarm HD LED Steady, Flashing or Rotating | | | |
| SIR05L0241* | 12/24V AC/DC ±10% | 180mA | 0.85 |
| SIR05L2401* | 90-240VAC ±10% | 40mA | |

*Specify colour A = Amber, B = Blue, C = Clear, G = Green, R = Red, Y = Yellow

Specifications:

| | |
|-------------------|---|
| Light source: | 32 x high output LED's |
| Flash rate: | Flashing - 85 fpm Rotating - 140 rpm |
| Protection: | IP65 |
| Duty: | Continuous |
| Temp rating (°C): | -30 to +50 |
| Cable entry: | M20 |
| Construction: | Polycarbonate base and lens HD version with aluminium base |

Rotallarm S

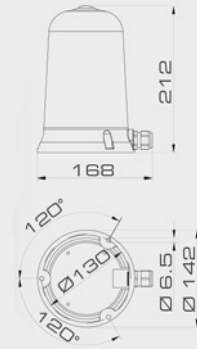

Rotallarm S with Grid and P Base

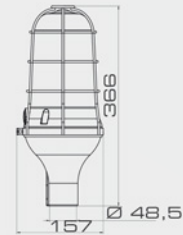

Rotallarm S with P Base

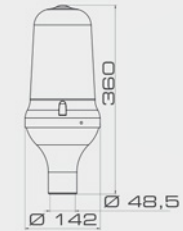

Dimensions in mm

Accessories and Spare Parts

| Order Code | Description |
|-------------|------------------------------------|
| SIR3811004 | BAP Single Bolt Mount |
| SIR3811005 | BP Wall Mount |
| SIR3811006 | AG Tube Mount |
| SIR3812009 | Wire Guard for Rotallarm HD |
| SIR3823011 | Wire Guard for AG tube Mount |
| SIR3200001* | Rotallarm S lens (*Specify colour) |

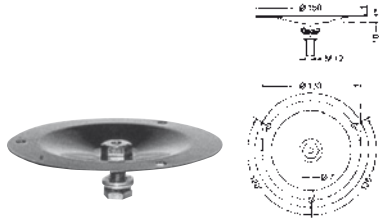

SIR3811004

Dimensions in mm

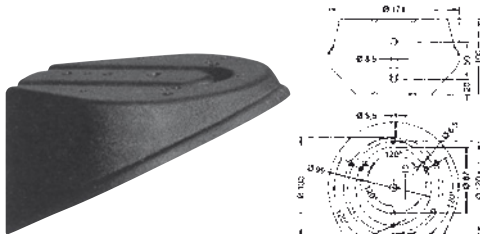

SIR3811005

Dimensions in mm

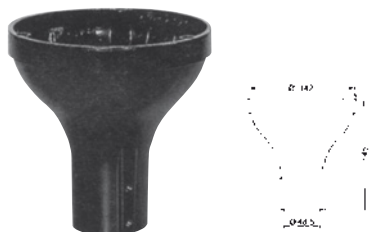

SIR3811006

Dimensions in mm



SIR3823011

B200LDA



- LED static beacon
- Multi-voltage
- IP65

Specifications:

Light intensity: 5.5cd
 Protection: IP65
 Duty: Continuous
 Temp rating (°C): -25 to +50
 Cable entry: through base 8mm grommet
 Construction: Polycarbonate base and lens
 Weight: 78g

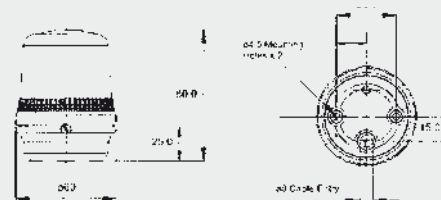

Dimensions in mm

| Order Code | Voltage | Current |
|-----------------|-----------|---------|
| ESSB200LDA030B* | 10-30VDC | 80mA |
| ESSB200LDA230B* | 90-240VAC | 32mA |

*Specify colour A = Amber, B = Blue, C = Clear, G = Green, R = Red, Y = Yellow

B300LDA



- LED multifunction beacon
- 9 flash patterns
- 2 stage alarm , remotely selectable (10-50VDC version only)
- Multi-voltage
- IP65

Specifications:

Light intensity: 19cd
 Protection: IP65
 Duty: Continuous
 Temp rating (°C): -25 to +50
 Cable entry: M20 side entry
 Construction: Polycarbonate base and lens
 Weight: 370g

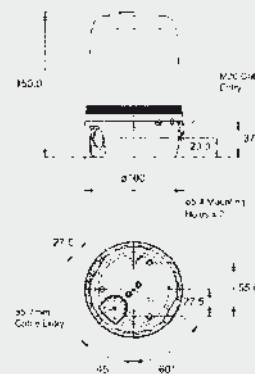

Dimensions in mm

| Flash Patterns | |
|--------------------------|--------------------------|
| Stage 1 | Stage 2 (10-50VDC only) |
| Static | Alternate side flash 2Hz |
| Rotating Slow 1 | Alternate side flash 2Hz |
| Single Flash 2Hz | Rotating Fast 2 |
| Rotating Fast 1 | Single Flash 2Hz |
| Rotating Slow 2 | Double Flash 1Hz |
| Double Flash 1Hz | Rotating Fast 2 |
| Rotating Fast 2 | Double Flash 2Hz |
| Double Flash 2Hz | Alternate side flash 2Hz |
| Alternate side flash 2Hz | Rotating Fast 2 |

| Order Code | Voltage | Current |
|-----------------|-----------|---------------|
| ESSB300LDA050B* | 10-50VDC | 130mA (24VDC) |
| ESSB300LDA230B* | 90-240VAC | 90 - 50mA |

*Specify colour A = Amber, B = Blue, C = Clear, G = Green, R = Red, Y = Yellow

Accessories and Spare Parts

B200 wall mount



B300 wall mount



| Order Code | Description |
|---------------|------------------------------|
| ESSB200RAB001 | B200 wall mount bracket |
| ESSB200TMA001 | B200 tube mount (140mm high) |
| ESSB300RAB001 | B300 wall mount bracket |
| ESSB300TMA001 | B300 tube mount (137mm high) |
| ESS9B200S* | B200 lens (*Specify colour) |
| ESS9B300S* | B300 lens (*Specify colour) |

B200 tube mount



B300 tube mount



STR



- Large industrial LED beacon
- Steady or flashing light
- Heavy duty aluminum base
- Optional wire guard
- IP65

Specifications:

| | |
|-------------------|-----------------------------------|
| Light Source: | 86 x 5mm LED's |
| Flash rate: | 150fpm ± 20 |
| Protection: | IP65 |
| Duty: | Continuous |
| Temp rating (°C): | -30 to +50 |
| Cable entry: | Through mounting base |
| Construction: | Polycarbonate lens, aluminum base |

| Order Code | Mounting | Voltage | Current | Weight (kg) |
|--|----------|----------|---------|-------------|
| STR LED continuous or flashing – selectable by terminals | | | | |
| SIR09L2024* | Surface | 24VAC/DC | 450mA | 1.5 |
| SIR09L2048* | | 48VAC/DC | 180mA | |
| SIR09L2110* | | 110VAC | 60mA | |
| SIR09L2240* | | 240VAC | 60mA | |

*Specify colour A = Amber, B = Blue, C = Clear, G = Green, R = Red, Y = Yellow

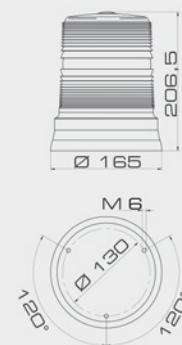

Dimensions in mm

Accessories and Spare Parts

| Order Code | Description |
|-------------|----------------------------|
| SIR3823010 | STR wire guard |
| SIR3600001* | STR lens (*Specify colour) |



SIR3823010

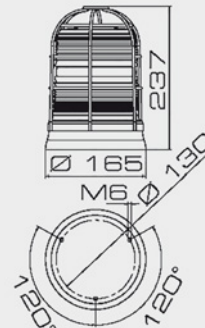

TK86HP

- 3J xenon beacon for fire, security and commercial applications
- High light output



| Order Code | Voltage ¹ | Current | Flash Energy |
|---------------------|----------------------|---------|--------------|
| MXTK86HP012* | 12VDC ±10% | 800mA | 3.15J |
| MXTK86HP024* | 24VDC ±10% | 400mA | 3.15J |
| MXTK86HP240* | 240VAC ±10% | 80mA | 2.2J |

*Specify colour A = Amber, B = Blue, C = Clear, G = Green, R = Red

¹ Note DC units must be supplied from power supply with less than 10% ripple

Specifications:

| | |
|---------------|--------------------------------|
| Flash Rate: | 90 fpm |
| Protection: | IP55 |
| Cable Entry: | Through base with flying leads |
| Construction: | ABS Base, Acrylic Lens |
| Weight: | 0.23Kg |

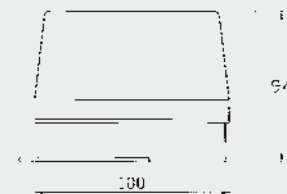
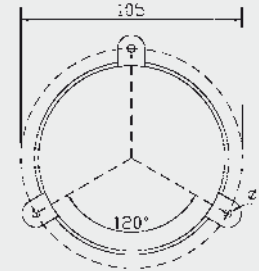

Dimensions in mm

Accessories and Spare Parts

| Order Code | Description |
|-----------------|-------------------------------|
| MX90025* | TK86HP lens (*Specify colour) |

NLXS

- Low power xenon beacon for fire, security and commercial applications
- Low current draw



| Order Code | Voltage ¹ | Current | Weight (kg) |
|--------------------|----------------------|---------|-------------|
| MXNLXS012* | 12VDC ± 10% | 220mA | 0.075 |
| MXNLXS024* | 24VDC ± 10% | 100mA | |
| MXNLXS024A* | 24VAC ± 10% | 250mA | |
| MXNLXS240* | 240VAC ± 5% | 25mA | |

*Specify colour A = Amber, B = Blue, C = Clear, G = Green, R = Red

¹ Note DC units must be supplied from power supply with less than 10% ripple

Mounting is on a panel with rear access and max. thickness of 8mm

Specifications:

| | |
|---------------|--------------------------------|
| Flash Rate: | 100 fpm |
| Protection: | IP55 |
| Cable Entry: | Through base with flying leads |
| Construction: | PC Base, Acrylic Lens |

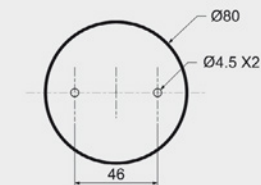
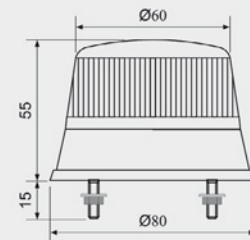

Fixed hole for screw

Dimensions in mm



L101 series



- 5J Xenon strobe or high intensity LED beacon
- Can be stacked to provide multi-signal status lights
- Synchronised 1Hz flash with adjacent beacons connected to the same supply
- Red housing with optional grey or white
- IP66
- UL approved version available



Specifications:

| | |
|-------------------|--|
| Light intensity: | Xenon – 200cd(e) LED – 120cd(e) |
| Protection: | IP66 |
| Duty: | Continuous |
| Temp rating (°C): | -25 to +55 |
| Cable entry: | M20 knockouts |
| Construction: | ABS Base, polycarbonate lens |
| Weight: | 0.20kg |

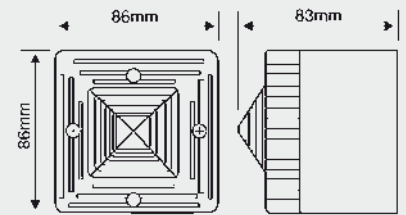

| Order Code | Voltage | Current |
|--|-------------|---------------|
| L101 5J xenon strobe beacon 60fpm (also 90fpm and double strike flash on DC powered versions) | | |
| ESS7005* | 10-14VDC | 500-380mA |
| ESS7010* | 20-28AC/DC | 250-300mA |
| ESS7015* | 42-54VDC | 175-250mA |
| ESS7020* | 115VAC±10% | 70mA |
| ESS7030* | 230VAC±10% | 35mA |
| L101H LED static or flashing beacon 120fpm | | |
| ESS7010H* | 10-30VDC | 155mA (24VDC) |
| ESS7030H* | 90-260AC/DC | 35mA (230VAC) |

*Specify colour A = Amber, B = Blue, C = Clear, G = Green, R = Red, Y = Yellow

B200STR



- 1J Xenon strobe
- Anti tamper locking screw on dome
- IP65

Specifications:

| | |
|-------------------|-----------------------------|
| Light intensity: | 37cd(e) |
| Flash rate: | 45fpm |
| Protection: | IP65 |
| Duty: | Continuous |
| Temp rating (°C): | -25 to +50 |
| Cable entry: | Through base |
| Construction: | Polycarbonate base and lens |
| Weight: | 78g |

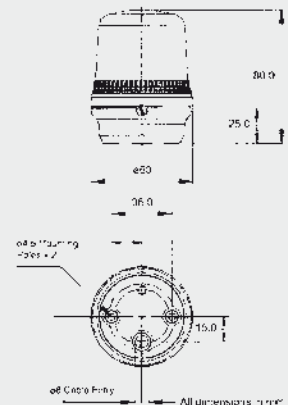

| Order Code | Voltage | Current |
|-----------------|-------------|----------------------------|
| ESSB200STR030B* | 10-30VAC/DC | 82mA (24VDC) 145mA (24VAC) |
| ESSB200STR115B* | 115VAC | 30mA |
| ESSB200STR230B* | 230VAC | 20mA |

*Specify colour A = Amber, B = Blue, C = Clear, G = Green, R = Red, Y = Yellow

Accessories and Spare Parts

| Order Code | Description |
|---------------|------------------------------|
| ESSB200RAB001 | B200 wall mount bracket |
| ESSB200TMA001 | B200 tube mount (140mm high) |
| ESS9001* | L101 lens (*Specify colour) |
| ESS9B200S* | B200 lens (*Specify colour) |

B200 tube mount



B200 wall mount



B300ST



- 5J Xenon strobe
- Synchronised 1Hz flash with adjacent beacons connected to the same supply
- IP65

Specifications:

Light intensity: 125cd(e)
 Flash energy: 5J
 Flash rate: 60fpm (also 90fpm and double strike flash on DC powered versions)
 Protection: IP65
 Duty: Continuous
 Temp rating (°C): -25 to +50
 Cable entry: M20
 Construction: ABS Base, polycarbonate lens
 Weight: 0.37kg

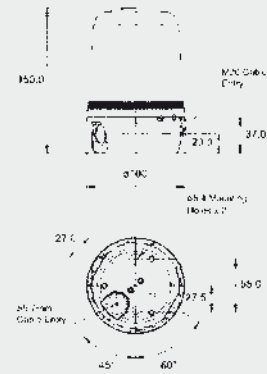

| Order Code | Voltage | Current |
|-----------------|----------|-----------|
| B300STR | | |
| ESSB300STR012B* | 12VAC/DC | 600-500mA |
| ESSB300STR024B* | 24VAC/DC | 300-250mA |
| ESSB300STR048B* | 48VAC/DC | 250-175mA |
| ESSB300STR115B* | 115VAC | 70mA |
| ESSB300STR230B* | 230VAC | 35mA |

*Specify colour A = Amber, B = Blue, C = Clear, G = Green, R = Red, Y = Yellow

B400ST



- 15J xenon strobe
- 3 flash patterns selectable on board
- Synchronised 1Hz flash with adjacent beacons connected to the same supply
- IP65

Specifications:

Light intensity: 500cd(e)
 Flash energy: 15J
 Flash rate: 1) double flash 45fpm
 2) single flash 60fpm (synchronised)
 3) triple flash 30fpm
 Protection: IP65
 Duty: Continuous
 Temp rating (°C): -25 to +50
 Cable entry: M20
 Construction: ABS Base, polycarbonate lens
 Weight: 0.54kg

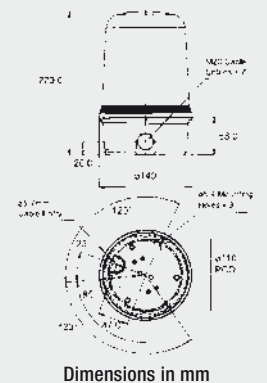

| Order Code | Voltage | Current |
|-----------------|----------|---------|
| B400STR | | |
| ESSB400STR024B* | 24VAC/DC | 870mA |
| ESSB400STR048B* | 48VAC/DC | 480mA |
| ESSB400STR115B* | 115VAC | 400mA |
| ESSB400STR230B* | 230VAC | 225mA |

*Specify colour A = Amber, B = Blue, C = Clear, G = Green, R = Red, Y = Yellow

Accessories and Spare Parts

B300 wall mount



B400 wall mount



| Order Code | Description |
|---------------|------------------------------|
| ESSB300RAB001 | B300 wall mount bracket |
| ESSB300TMA001 | B300 tube mount (137mm high) |
| ESSB400RAB001 | B400 wall mount bracket |
| ESSB400TMA001 | B400 tube mount (137mm high) |
| ESS9B300S* | B300 lens (*Specify colour) |
| ESS9B400S* | B400 lens (*Specify colour) |

B300 tube mount



B400 tube mount



LP-LT series

- 2W and 5W xenon strobe beacons
- Low and high profile design
- Multi-voltage options
- IP67 (dependent on installation method)



| Order Code | Model | Voltage | Current | Flash rate |
|---|-----------|-----------------------|----------|------------|
| LP1 xenon strobe beacon 2W (LP4xMV/5 – 5W) low profile | | | | |
| DLP401002* | LP1XMV/2 | 10 -100VDC 20 - 72VAC | 130-37mA | 75 fpm |
| DLP401005* | LP1XMV/5 | 10 -100VDC 20 - 72VAC | 250-60mA | 75 fpm |
| DLP111002* | LP1X110/2 | 110VAC (90-125V) | 30mA | 60 fpm |
| DLP124002* | LP1X230/2 | 240VAC (207-253V) | 15mA | 60 fpm |
| LT3 xenon strobe beacon 5W high profile | | | | |
| DLT401005* | LT4XMV/5 | 10 -100VDC 20 - 72VAC | 255-70mA | 75 fpm |
| DLT311005* | LT3X110/5 | 110VAC (90-125V) | 50mA | 90 fpm |
| DLT324005* | LT3X230/5 | 240VAC (207-264V) | 40mA | 90 fpm |

*Specify colour A = Amber, B = Blue, C = Clear, G = Green, R = Red

Note: mounting bases are required unless mounting on a panel with rear access and max. thicknesses of 8mm.

Specifications:

| | |
|-------------------|---|
| Protection: | IP67 (dependent on installation method) |
| Duty: | Continuous |
| Temp rating (°C): | -25 to +50 |
| Cable entry: | M20 |
| Construction: | Polycarbonate base and lens |

LP series

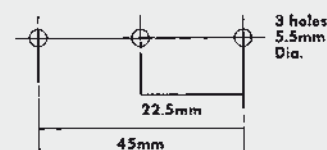
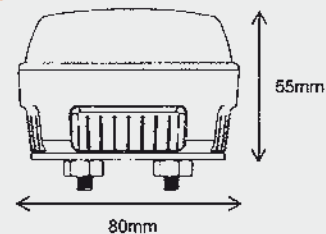

Drilling for panel mounting
2 x M5 x 15mm studs

LT series

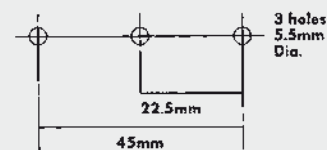
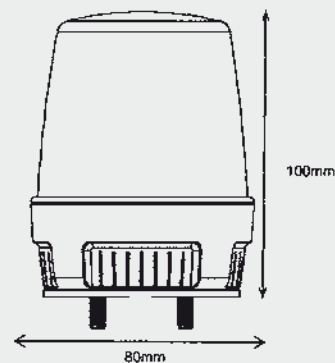

Drilling for panel mounting
2 x M5 x 15mm studs

Accessories and Spare Parts

| Order Code | Description |
|------------|----------------------------|
| DLFX2 | FX2 surface mounting base |
| DLFX40 | FX40 wall mounting bracket |

FX2



FX40



RB series



- Xenon strobe beacons up to 15W
- Multi-voltage options
- Wide choice of mounting accessories
- IP65

Specifications:

| | |
|-------------------|------------------------------|
| Protection: | IP65 |
| Duty: | Continuous |
| Temp rating (°C): | -20 to +55 |
| Mounting: | Surface mounting |
| Cable entry: | Through base |
| Construction: | Polycarbonate lens, ABS base |
| Weight: | 0.4kg |
| Mounting: | Vertical dome on top |

| Order Code | Model | Voltage | Current | Power | Candela | Flash rate |
|------------|------------|--------------------|-----------|-------|---------|------------|
| DLR201215* | RB2XDV/15 | 10-33VDC | 1.5-0.75A | 15W | 60Cd | 125fpm |
| DLR401206* | RB4XDV/6 | 10-32VDC | 600-300mA | 6W | 50Cd | 75fpm |
| DLR401002* | RB4XMV/2P | 10-100VDC 20-60VAC | 145-40mA | 2W | 18Cd | 75fpm |
| DLR401005* | RB4XMV/5 | 10-100VDC 30-60VAC | 360-60mA | 5W | 44Cd | 75fpm |
| DLR211010* | RB2X110/10 | 110VAC | 90mA | 10W | 25Cd | 130fpm |
| DLR324010* | RB3X240/10 | 240VAC (207-253V) | 42mA | 10W | 30Cd | 90 fpm |

*Specify colour A = Amber, B = Blue, C = Clear, R = Red

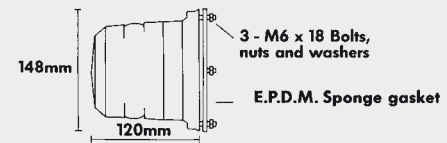
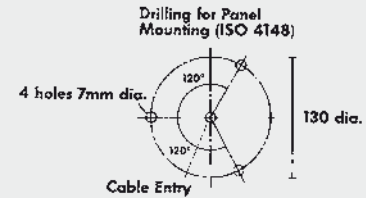

EL series



- Xenon strobe beacons up to 15W
- Double flash on 12/24V model
- Multi-voltage options
- Wide choice of mounting accessories
- IP65

Specifications:

| | |
|---------------------|------------------------------|
| Power output: | 15W |
| Luminous Intensity: | 100 Cd(e) |
| Flash rate: | 120fpm |
| Protection: | IP65 |
| Duty: | Continuous |
| Temp rating (°C): | -20 to +55 |
| Mounting: | Surface mounting |
| Cable entry: | Through base |
| Construction: | Polycarbonate lens, ABS base |
| Weight: | 0.45kg |
| Mounting: | Vertical only |

| Order Code | Model | Voltage | Current |
|------------|-------------|-------------------|-----------|
| DLE201215* | ELB2DXDV/15 | 10-33VDC | 1.25-0.6A |
| DLE224015* | EL2SX240/15 | 240VAC (207-253V) | 140mA |

*Specify colour A = Amber, B = Blue, C = Clear, G = Green, R = Red

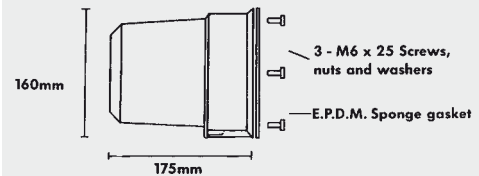

Accessories and Spare Parts

| Order Code | Description |
|------------|--|
| DLFX7 | FX7 single bolt mount RB series |
| DLFX9 | FX9 steel guard for RB series |
| DLFX10 | FX10 steel guard for EL series |
| DLFX12 | FX12 single bolt mount EL series |
| DLFX14 | FX14 wall mount bracket RB - EL series |
| DLFX17 | FX17 mounting clip kit EL series |
| DLFX28 | FX28 cable entry plinth RB - EL series |
| DL900030* | RB lens (*Specify colour) |
| DL900040* | EL lens (*Specify colour) |
| DL900050 | RB2XDV/15 xenon tube kit |
| DL900051 | RB4XMV/5 xenon tube kit |
| DL900060 | ELB2DXDV/15 xenon tube kit |

Note: steel guards cannot be used in combination with other mounting accessories.

FX9



FX14



FX28

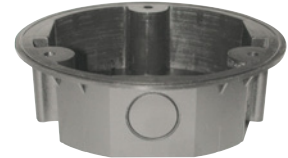

FX10



FX7



FX12



FX17



Xenoflash

- 2J xenon strobe
- 3 mounting options
- Double insulated
- IP54



Specifications:

| | |
|-------------------|------------------------------|
| Flash rate: | 65fpm ±10 |
| Flash energy: | 2J |
| Protection: | IP54 |
| Duty: | Continuous |
| Temp rating (°C): | -30 to +40 |
| Cable entry: | M16 or through mounting base |
| Construction: | Polycarbonate base and lens |

Xenoflash S

Xenoflash P

Xenoflash E

| Order Code | Mounting | Voltage | Current | Candela | Weight (kg) |
|-------------|-------------|-------------|-----------|-------------|-------------|
| SIR2102430* | Surface | 12-24VAC/DC | 400-350mA | 700-1000(p) | 0.30 |
| SIR2111030* | | 110VAC | 65mA | 1300(p) | |
| SIR2124030* | | 240VAC | 40mA | 1450(p) | |
| SIR2102431* | Single bolt | 12-24VAC/DC | 400-350mA | 700-1000(p) | 0.31 |
| SIR2111031* | | 110VAC | 65mA | 1300(p) | |
| SIR2124031* | | 240VAC | 40mA | 1450(p) | |
| SIR2102432* | E27 | 12-24VAC/DC | 400-350mA | 700-1000(p) | 0.26 |
| SIR2111032* | | 110VAC | 65mA | 1300(p) | |
| SIR2124032* | | 240VAC | 40mA | 1450(p) | |

*Specify colour A = Amber, B = Blue, C = Clear, G = Green, R = Red

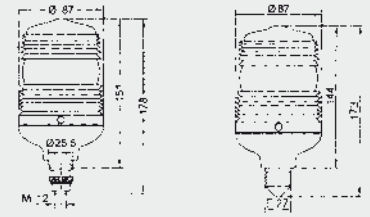
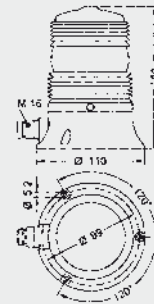

Dimensions in mm

CTLX1200

- 6J xenon strobe
- Low profile
- High output
- Double insulated
- IP54



Specifications:

| | |
|-------------------|-----------------------------|
| Flash rate: | 65fpm ±10 |
| Flash energy: | 6J |
| Protection: | IP54 |
| Duty: | Continuous |
| Temp rating (°C): | -10 to +40 |
| Cable entry: | Through mounting base |
| Construction: | Polycarbonate base and lens |

| Order Code | Voltage | Current | Candela | Weight (kg) |
|-------------|-------------|---------|--------------|-------------|
| SIR2002440* | 12-24VAC/DC | 1-0.75A | 3150-3450(p) | 0.30 |
| SIR2011040* | 110VAC | 100mA | 2700(p) | |
| SIR2024040* | 240VAC | 90mA | 3500(p) | |

*Specify colour A = Amber, B = Blue, C = Clear, G = Green, R = Red

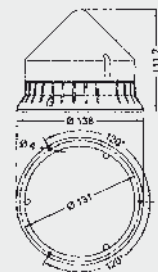

Dimensions in mm

Accessories and Spare Parts

| Order Code | Description |
|-------------|--------------------------------------|
| SIR3300001* | Xenoflash lens (*Specify colour) |
| SIR3180001* | CTLX1200 lens (*Specify colour) |
| SIR3999020 | 2 Joule xenon tube to suit xenoflash |
| SIR3999060 | 6 Joule xenon tube to suit CTLX1200 |

Maxi-Xenoflash

- 6J xenon strobe
- Double insulated
- IP54



Specifications:

Flash rate: 65fpm \pm 10
 Flash energy: 6J
 Protection: IP54
 Duty: Continuous
 Temp rating ($^{\circ}$ C): -30 to +40
 Cable entry: M16
 Construction: Polycarbonate base and lens

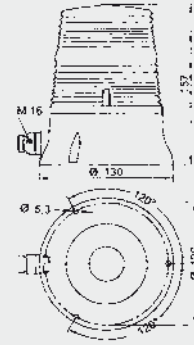

Dimensions in mm

| Order Code | Voltage | Current | Candela | Weight (kg) |
|----------------------|-------------|---------|---------|-------------|
| 6J xenon tube | | | | |
| SIR2202440* | 12-24VAC/DC | 1-0.75A | 2600(p) | 0.31 |
| SIR2211040* | 110VAC | 100mA | 2000(p) | |
| SIR2224040* | 240VAC | 90mA | 2650(p) | |

*Specify colour A = Amber, B = Blue, C = Clear, G = Green, R = Red

Blindo Lampalarm Xeno

- 6J xenon strobe
- Aluminium base
- Protective cage
- IP65



Specifications:

Flash rate: 65fpm \pm 10
 Flash energy: 6J
 Protection: IP65
 Duty: Continuous
 Temp rating ($^{\circ}$ C): -30 to +40
 Cable entry: M16
 Construction: Aluminium base, polycarbonate lens, steel guard



Dimensions in mm

| Order Code | Voltage | Current | Candela | Weight (kg) |
|-------------|-------------|---------|--------------|-------------|
| SIR2902440* | 12-24VAC/DC | 1-0.75A | 3150-3500(p) | 0.95 |
| SIR2911040* | 110VAC | 100mA | 2600(p) | |
| SIR2924040* | 240VAC | 90mA | 3250(p) | |

*Specify colour A = Amber, B = Blue, C = Clear, G = Green, R = Red

Accessories and Spare Parts

| Order Code | Description |
|-------------|---------------------------------------|
| SIR3400001* | Maxi-xenoflash lens (*Specify colour) |
| SIR3200001* | Lampalarm lens (*Specify colour) |
| SIR3999060 | 6 joule xenon tube |

Stroboflash

- 15J xenon strobe
- Aluminium base
- Surface or tube mounting
- IP65



Specifications:

| | |
|-------------------|------------------------------------|
| Flash rate: | 65rpm ±10 |
| Flash energy: | 15J |
| Protection: | IP65 |
| Duty: | Continuous |
| Temp rating (°C): | -30 to +40 |
| Cable entry: | Through base |
| Construction: | Aluminium base, polycarbonate lens |

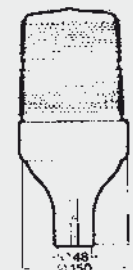
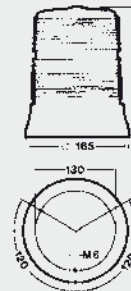

Dimensions in mm

| Order Code | Mounting | Voltage | Current | Candela | Weight (kg) |
|-------------|-------------|-------------|----------|----------|-------------|
| SIR2302450* | Surface (N) | 12-24VAC/DC | 2.5-1.2A | 21500(p) | 1.5 |
| SIR2311060* | | 110VAC | 130mA | 4600(p) | |
| SIR2324060* | | 240VAC | 150mA | 16500(p) | |
| SIR2302455* | Tube (AG) | 12-24VAC/DC | 2.5-1.2A | 21500(p) | 1.66 |
| SIR2311065* | | 110VAC | 130mA | 4600(p) | |
| SIR2324065* | | 240VAC | 150mA | 16500(p) | |

*Specify colour A = Amber, B = Blue, C = Clear, G = Green, R = Red

Accessories and Spare Parts



SIR3823010

| Order Code | Description |
|-------------|------------------------------------|
| SIR3600001* | Stroboflash lens (*Specify colour) |
| SIR3823010 | Stroboflash N wire guard |
| SIR3999200 | 15 joule xenon tube |

Model RM

- 10W rotating beacon for fire, security and commercial applications
- Low voltage lamps for longer life
- Supplied with spare lamp



| Order Code | Voltage | Current | Bulb | Weight (kg) |
|------------|-------------|---------|---------|-------------|
| MXRM012* | 12VDC ±10% | 850mA | 12V 10W | 0.6 |
| MXRM024* | 24VDC ±10% | 425mA | 24V 10W | |
| MXRM240* | 240VAC ±10% | 40mA | 12V 8W | 0.75 |

*Specify colour A = Amber, B = Blue, G = Green, R = Red

Specifications:

Flash Rate: 150 rpm
 Protection: IP44
 Cable Entry: Through Base
 Construction: ABS Base, Acrylic Lens
 Mounting: Within 30° of Vertical

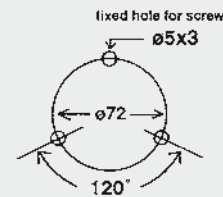
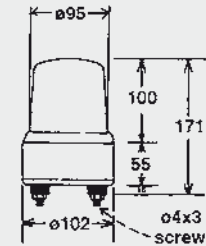

Dimensions in mm

Model RA

- 20W rotating beacon for fire, security and commercial applications
- Low voltage lamps for longer life
- Supplied with spare lamp



| Order Code | Voltage | Current | Bulb | Weight (kg) |
|------------|-------------|---------|---------|-------------|
| MXRA012* | 12VDC ±10% | 1.7A | 12V 20W | 0.65 |
| MXRA024* | 24VDC ±10% | 0.85A | 24V 20W | |
| MXRA240* | 240VAC ±10% | 90mA | 12V 20W | 1.1 |

*Specify colour A = Amber, B = Blue, G = Green, R = Red

Specifications:

Flash Rate: 150 rpm
 Protection: IP44
 Cable Entry: Through Base
 Construction: ABS Base, Acrylic Lens
 Mounting: Within 30° of Vertical

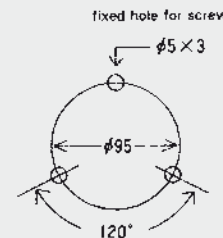
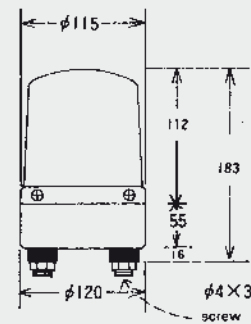

Dimensions in mm

Accessories and Spare Parts

| Order Code | Description |
|------------|--------------------------------|
| MX90120 | 12V 8W bulb (RM 240V) |
| MX90121 | 12V 10W bulb (RM 12V) |
| MX90122 | 24V 10W bulb (RM 24V) |
| MX90131 | 12V 20W bulb (RA 12V and 240V) |
| MX90132 | 24V 20W bulb (RA 24V) |
| MX90016* | RM lens (*Specify colour) |
| MX90014* | RA lens (*Specify colour) |



EH series

- 148 or 220mm Ø base
- Low voltage bulbs
- Worm gear drive
- Metal base
- IP55



EHS



EHB

Specifications:

Flash rate: 180rpm
 Protection: IP55
 Duty: Continuous
 Temp rating (°C): -10 to +50
 Cable entry: Through base
 Construction: Painted steel base, acrylic lens
 Mounting: Surface mounting within 30° of vertical

| Order Code | Voltage | Current | Bulb | Weight (kg) |
|--------------------|---------|---------|---------------|-------------|
| EHS 148mm Ø | | | | |
| MXEHS012* | 12VDC | 4.2A | 12V 55W H1 | 1.25 |
| MXEHS024* | 24VDC | 2.6A | 24V 70W H1 | |
| MXEHS110* | 110VAC | 0.3A | 12V 35W Ba15S | 2.0 |
| MXEHS240* | 240VAC | 0.18A | | |
| EHB 220mm Ø | | | | |
| MXEHB012* | 12VDC | 4.2A | 12V 55W H1 | 2.5 |
| MXEHB024* | 24VDC | 2.6A | 24V 70W H1 | |
| MXEHB110* | 110VAC | 0.5A | 12V 55W H1 | 3.45 |
| MXEHB240* | 240VAC | 0.25A | | |

*Specify colour A = Amber, B = Blue, C = Clear, G = Green, R = Red

Accessories and Spare Parts

| Order Code | Description |
|------------|----------------------------|
| MX90010* | EHS lens (*Specify colour) |
| MX90012* | EHB lens (*Specify colour) |
| SIR3955012 | 12V 55W H1 bulb |
| SIR3970024 | 24V 70W H1 bulb |
| MX90110 | 12V 35W Ba15s bulb |

EHS

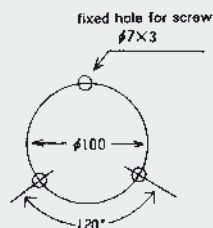
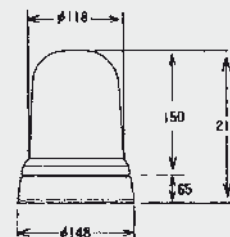

EHB

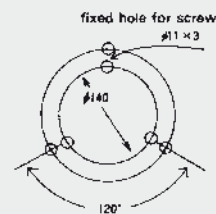
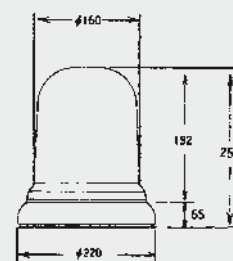

Dimensions in mm

B300RTH



- 20/25W rotating beacon
- Halogen bulbs
- Horizontal or vertical mounting (inverted)
- IP65

Specifications:

Light intensity: 125cd(e)
Flash rate: 180rpm ±30
Protection: IP65
Duty: Continuous
Temp rating (°C): -25 to +50
Cable entry: M20
Construction: ABS Base, polycarbonate lens
Weight: 0.37kg

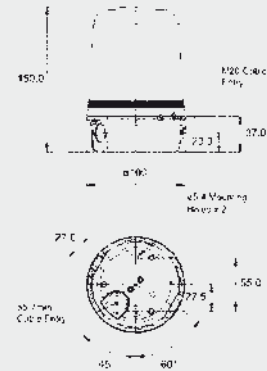

Dimensions in mm

| Order Code | Voltage | Current | Bulb |
|-----------------|---------|---------|-----------|
| ESSB300RTH012B* | 12VDC | 1.72A | 20W G6,35 |
| ESSB300RTH024B* | 24VDC | 0.91A | |
| ESSB300RTH115B* | 115VAC | 216mA | 25W G6,35 |
| ESSB300RTH230B* | 230VAC | 117mA | |

*Specify colour A = Amber, B = Blue, C = Clear, G = Green, R = Red

B400RTH



- 35/40W rotating beacon
- Halogen bulbs
- Horizontal or vertical mounting (inverted)
- IP65

Specifications:

Light intensity: 325cd(e)
Flash rate: 180rpm ±30
Protection: IP65
Duty: Continuous
Temp rating (°C): -25 to +50
Cable entry: 2 x M20
Construction: ABS Base, polycarbonate lens
Weight: 0.58kg

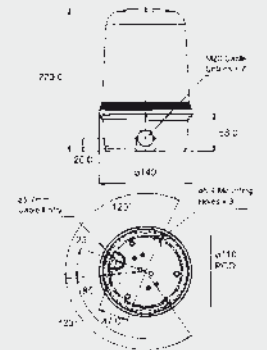

Dimensions in mm

| Order Code | Voltage | Current | Bulb |
|-----------------|---------|---------|-----------|
| ESSB400RTH012B* | 12VDC | 3.0A | 35W G6,35 |
| ESSB400RTH024B* | 24VDC | 1.54A | |
| ESSB400RTH115B* | 115VAC | 338mA | 40W G6,35 |
| ESSB400RTH230B* | 230VAC | 186mA | |

*Specify colour A = Amber, B = Blue, C = Clear, G = Green, R = Red

Accessories and Spare Parts

| Order Code | Description |
|---------------|--|
| ESSB300RAB001 | B300 wall mount bracket |
| ESSB300TMA001 | B300 tube mount (137mm high) |
| ESSB400RAB001 | B400 wall mount bracket |
| ESSB400TMA001 | B400 tube mount (137mm high) |
| ESS9B300R* | B300RTH lens (*Specify colour) |
| ESS9B400R* | B400RTH lens (*Specify colour) |
| ESS9B1020*** | 20 W G6,35 bulb (*Specify voltage 012 or 024) |
| ESS9B1025*** | 25 W G6,35 bulb (*Specify voltage 115 or 230) |
| ESS9B1035*** | 35 W G6,35 bulb (*Specify voltage 012 or 024) |
| ESS9B1040*** | 40 W G6,35 bulb (*Specify voltage 115 or 230) |

B300 tube mount

B400 tube mount

B300 wall mount

B400 wall mount

Rotalarm

- Incandescent or halogen bulbs
- Heavy Duty version with aluminium base and protective cage
- Gear drive
- IP65



Specifications:

| | |
|-------------------|---|
| Flash rate: | 160rpm +_ 30 |
| Protection: | IP65 |
| Duty: | Continuous |
| Temp rating (°C): | -30 to +50 |
| Cable entry: | M16 |
| Weight: | 0.56kg (Blindo 1.4kg) |
| Construction: | Polycarbonate (aluminium) base and lens |

| Order Code | Order Code | Voltage | Current | Bulb | Candela |
|---------------------|--------------------------------|---------|---------|-----------|----------|
| Plastic base | Aluminium base and cage | | | | |
| SIR1101210* | SIR1901210* | 12VDC | 4A | Ba15s 45W | 6500(p) |
| SIR1101230* | SIR1901230* | 12VAC | | | |
| SIR1101220* | SIR1901220* | 12VDC | 4.8A | H1 55W | 10000(p) |
| SIR1102410* | SIR1902410* | 24VDC | 2.1A | Ba15s 45W | 6500(p) |
| SIR1102430* | SIR1902430* | 24VAC | | | |
| SIR1102420* | SIR1902420* | 24VDC | 3.1A | H1 70W | 10000(p) |
| SIR1102440* | SIR1902440* | 24VAC | | | |
| SIR1104810* | SIR1904810* | 48VDC | 1.0A | Ba15s 45W | 6500(p) |
| SIR1104830* | SIR1904830* | 48VAC | 0.74A | E14T 25W | 600(p) |
| SIR1111030* | SIR1911030* | 110VAC | 0.31A | | 400(p) |
| SIR1124030* | SIR1924030* | 240VAC | 0.15A | | |

*Specify colour A = Amber, B = Blue, C = Clear, G = Green, R = Red

Rotalarm



Blindo Rotalarm

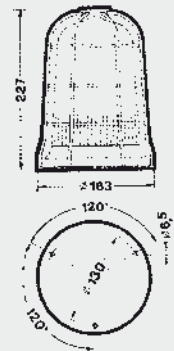

Dimensions in mm

Accessories and Spare Parts

| Order Code | Description |
|-------------|-----------------------------------|
| SIR3811004 | BAP Single Bolt Mount |
| SIR3811005 | BP Wall Mount |
| SIR3811006 | AG Tube Mount |
| SIR3100001* | Rotalarm lens (*Specify colour) |
| SIR3955012 | H1 bulb 55W 12V |
| SIR3970012 | H1 bulb 70W 24V |
| SIR39450** | 45W BA15s bulb (*Specify voltage) |
| SIR3930*** | 25W E14T bulb (*Specify voltage) |



SIR3811004



SIR3811005



SIR3811006

SIR3811004



SIR3811005



SIR3811006



Dimensions in mm

M-Line Modular Signaling System



The M-Line modular signaling system consists of a range of LED multifunction beacons, electronic sounders and sounders with integrated LED beacon all with operating voltage of 12-24VAC/DC. The signaling units must be combined with a mounting base with or without built in power supplies to build a complete signaling device. The mounting base units and sounder units are available in a choice of four colours (Red, White, Grey or Black) and all signaling devices feature independently selectable functions via external contacts to provide different levels of alarm in a single device. All mounting base units are available with a choice of three voltage ranges (12-24VAC/DC, 30-80VAC/DC and 120-240VAC).

An economy range of sounders and sounders with integrated LED's supplied complete with a surface mount base is also available.

General characteristics:

FLR S Multi-function LED Beacon

With a choice of 3 light effects (steady, flashing or rotating) selected via external contacts. Available with choice of coloured lens or clear lens (with colour LED's). Colours available – Amber, Red, Blue and Green.

SLR S High Output Multi-function LED Beacon

With a choice of 3 light effects (flashing, strobe light or super bright random effect) selected via external contacts. Available with choice of coloured lens or clear lens (with colour LED's). Colours available – Amber, Red, Blue, Green and White.

XLF S Low Profile Multi-function LED Beacon

With a choice of 3 light effects (steady, flashing or strobe) selected via external contacts. Available with choice of coloured lens or clear lens (with colour LED's) and with either proximity lens for use close to personnel or with directional lens for longer distance signaling. Colours available – Amber, Red, Blue and Green.

XLF RGA Low Profile Multi-colour LED Beacon

With 3 colours in one beacon (Red, Amber and Green) selected via external contacts and a choice of steady or flashing light selected by DIP switches.

SIR-E S

Electronic sounder with 2 stage alarm selected by external contacts and choice of 32 tones for each stage. 105dB sound output with volume adjustment (65-105dB). Housing available in 4 colours (Red, White, Grey and Black)

SIR-E Max

High output electronic sounder with 2 stage alarm selected by external contacts and choice of 32 tones for each stage. 115dB sound output with volume adjustment (65-115dB). Housing available in 4 colours (Red, White, Grey and Black)

SIR-EJ

Electronic sounder with 2 stage alarm selected by external contacts and choice of 8 tones for each stage. Includes Australian standard alert and evacuation tones. 100dB sound output. Housing available in 2 colours (Red and White).

SIR-E LED S

Electronic sounder/beacon with 3 stage alarm selected by external contacts, with flashing light for stage 1, flashing light and sounder for stage 2 and steady light with sounder for stage 3 and choice of 32 tones for stages 2 and 3. 105dB sound output with volume adjustment (65-105dB). LED colours available - Amber, Red, Blue and Green.

SIR-E LED MAX

Electronic sounder/beacon with 3 stage alarm selected by external contacts, with flashing light for stage 1, flashing light and sounder for stage 2 and steady light with sounder for stage 3 and choice of 32 tones for stages 2 and 3. 115dB sound output with volume adjustment (65-115dB). LED colours available - Amber, Red, Blue and Green.

SIR-EJ LED

Electronic sounder/beacon with 3 stage alarm selected by external contacts, with flashing light for stage 1, flashing light and sounder for stage 2 and steady light with sounder for stage 3 and choice of 8 tones for stages 2 and 3. 100dB sound output. Includes Australian standard alert and evacuation tones. LED colours available - Amber, Red, Blue and Green.

Mounting Bases

Quick connect mounting bases surface mount (shallow and deep version with cable entries), wall mount, double wall mount, ceiling mount and pole mount. Three voltage ranges available (12-24VAC/DC, 30-80VAC/DC and 120-240VAC) Bases available in 4 colours (Red, White, Grey and Black)

Common specifications:

| | |
|-------------------|--|
| Duty: | Continuous |
| Temp rating (°C): | -30 to +50 |
| Cable entry: | 2 x M20 on deep surface mount and wall mount bases |
| Construction: | Polycarbonate |

Compliance and standards:

Certifications obtained: CE, UL, PCT

M-Line Modular Signaling System



FLR S LED Beacon

| Colour | Order Code (Beacon only) | | Weight (kg) |
|--------|--------------------------|-------------------------|-------------|
| | Coloured Lens | Clear Lens Coloured LED | |
| Blue | SIR01M90351 | SIR01M90121 | 0.2 |
| Amber | SIR01M90352 | SIR01M90122 | 0.2 |
| Red | SIR01M90353 | SIR01M90123 | 0.2 |
| Green | SIR01M90354 | SIR01M90124 | 0.2 |



SLR S High Output LED Beacon

| Colour | Order Code (Beacon only) | | Weight (kg) |
|--------|--------------------------|-------------------------|-------------|
| | Coloured Lens | Clear Lens Coloured LED | |
| Blue | SIR01M90851 | SIR01M90861 | 0.2 |
| Amber | SIR01M90852 | SIR01M90862 | 0.2 |
| Red | SIR01M90853 | SIR01M90863 | 0.2 |
| Green | SIR01M90854 | SIR01M90864 | 0.2 |
| White | SIR01M90856 | - | 0.2 |



XLF Proximity

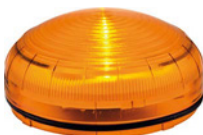

XLF Directional

XLF S Low Profile LED Beacon

| Colour | Order Code (Beacon only) | | Weight (kg) |
|--------|--------------------------|------------------|-------------|
| | Proximity Lens | Directional Lens | |
| Blue | SIR01M90501 | SIR01M90821 | 0.11 |
| Amber | SIR01M90502 | SIR01M90822 | 0.11 |
| Red | SIR01M90503 | SIR01M90823 | 0.11 |
| Green | SIR01M90504 | SIR01M90824 | 0.11 |



XLF RGA Proximity



XLF RGA Directional

XLF RGA Low Profile Multi-colour LED Beacon

| Colour | Order Code (Beacon only) | | Weight (kg) |
|--------|--------------------------|------------------|-------------|
| | Proximity Lens | Directional Lens | |
| Red | SIR01M90507 | SIR01M90847 | 0.11 |
| Amber | | | |
| Green | | | |

Specifications:

FLR S LED Beacon

Flash Patterns: Steady, flashing (85fprm), rotating (140rpm)
 Current: 12-24VAC/DC – 510-360mA
 30-80VAC/DC – 300-110mA
 90-240VAC – 100-70mA
 Protection: IP66

SLR S High Output LED Beacon

Flash Patterns: Flashing (150fprm), strobe (5 x 72fprm), random
 Current: 12-24VAC/DC – 450-700mA
 30-80VAC/DC – 800-250mA
 90-240VAC – 150-40mA
 Protection: IP66

FLR-SLR

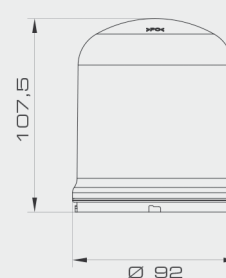

Dimensions in mm

XLF S Low Profile LED Beacon

Flash Patterns: Steady, flashing (150fprm), strobe (5 x 72fprm)
 Current: 12-24VAC/DC – 300-270mA
 30-80VAC/DC – 240-100mA
 90-240VAC – 80-50mA
 Protection: IP66

XLF RGA Low Profile Multi-colour LED Beacon

Flash Patterns: Steady, flashing (150fprm)
 Current: 12-24VAC/DC – 370-310mA
 30-80VAC/DC – 250-100mA
 90-240VAC – 90-55mA
 Protection: IP66

XLF - XLF RGA



Dimensions in mm

M-Line Modular Signaling System



SIR-E S

SIR-E S Sounder (with volume control)

| Order Code | Body Colour | Weight (Kg) |
|-------------|-------------|-------------|
| SIR05M90358 | Red | 0.22 |
| SIR05M90359 | White | 0.22 |
| SIR05M90360 | Grey | 0.22 |
| SIR05M90357 | Black | 0.22 |



SIR-E MAX

SIR-E MAX Sounder (with volume control)

| Order Code | Body Colour | Weight (Kg) |
|-------------|-------------|-------------|
| SIR05M90410 | Red | 0.54 |
| SIR05M90409 | White | 0.54 |
| SIR05M90407 | Grey | 0.54 |
| SIR05M90408 | Black | 0.54 |



SIR-EJ

SIR-EJ Sounder (without volume control)

| Order Code | Body Colour | Weight (Kg) |
|-------------|-------------|-------------|
| SIR05M90389 | Red | 0.22 |
| SIR05M90388 | White | 0.22 |
| SIR05M90387 | Grey | 0.22 |
| SIR05M90390 | Black | 0.22 |

Specifications:

SIR-E S Sounder

Maximum Sound Output: 105dB @ 1m – actual sound output depends on tone and voltage

Nominal Sound Output: 12-24V – 101.5-103dB
40-80V – 100dB
90-240V – 100dB

Tones: 2 x 32 tones in 2 channels – see tone table on page 11-27

Current: 12-24VAC/DC – 215-250 mA
30-80VAC/DC – 55-155mA
90-240VAC – 60-35mA

Protection: IP65

SIR-E S



Dimensions in mm

SIR-E MAX Sounder

Maximum Sound Output: 115dB @ 1m – actual sound output depends on tone and voltage

Nominal Sound Output: 12-24V – 103-115dB
40-80V – 101-113dB
90-240V – 99-111dB

Tones: 2 x 32 tones in 2 channels – see tone table on page 11-27

Current: 12-24VAC/DC – 3-0.5A
30-80VAC/DC – 0.6-0.12A
90-240VAC – 150-50mA

Protection: IP65

SIR-E MAX



Dimensions in mm

SIR-E MAX Sounder

Maximum Sound Output: 100dB @ 1m

Tones: 2 x 8 tones in 2 channels – see tone table on page 11-27

Current: 12-24VAC/DC – 200-300mA
30-80VAC/DC – 220-90mA
90-240VAC – 75-30mA

Protection: IP65

SIR-EJ

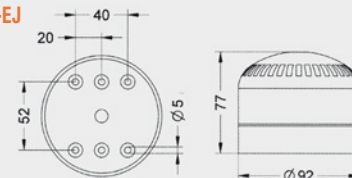

Dimensions in mm

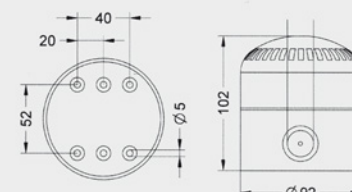

M-Line Modular Signaling System



SIR-E LED S

SIR-E LED S Sounder-Beacon (with volume control)

| Order Code | LED Colour | Weight (kg) |
|-------------|------------|-------------|
| SIR05M90361 | Blue | 0.22 |
| SIR05M90362 | Amber | 0.22 |
| SIR05M90363 | Red | 0.22 |
| SIR05M90364 | Green | 0.22 |



SIR-E LED MAX

SIR-E LED MAX Sounder-Beacon (with volume control)

| Order Code | LED Colour | Weight (kg) |
|-------------|------------|-------------|
| SIR05M90561 | Blue | 0.54 |
| SIR05M90562 | Amber | 0.54 |
| SIR05M90563 | Red | 0.54 |
| SIR05M90564 | Green | 0.54 |



SIR-EJ LED

SIR-EJ LED Sounder-Beacon (without volume control)

| Order Code | LED Colour | Weight (kg) |
|-------------|------------|-------------|
| SIR05M90421 | Blue | 0.22 |
| SIR05M90422 | Amber | 0.22 |
| SIR05M90423 | Red | 0.22 |
| SIR05M90424 | Green | 0.22 |

Specifications:

SIR-E LED S Sounder-Beacon

Maximum Sound Output: 105dB @ 1m – actual sound output depends on tone and voltage

Nominal Sound Output: 12-24V – 101.5-103dB
40-80V – 100dB
90-240V – 100dB

Tones: 2 x 32 tones in 2 channels – see tone table on page 11-27

Current: 12-24VAC/DC – 300-350mA
30-80VAC/DC – 80-265mA
90-240VAC – 95-60mA

Protection: IP65

SIR-E LED S



Dimensions in mm

SIR-E LED MAX Sounder-Beacon

Maximum Sound Output: 115dB @ 1m – actual sound output depends on tone and voltage

Nominal Sound Output: 12-24V – 103 - 115dB
40-80V – 101 - 113dB
90-240V – 99 - 111dB

Tones: 2 x 32 tones in 2 channels – see tone table on page 11-27

Current: 12-24VAC/DC – 3 - 0.5A
30-80VAC/DC – 0.6 - 0.12A
90-240VAC – 150 - 50mA

Protection: IP65

SIR-E LED MAX

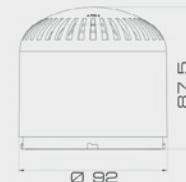

Dimensions in mm

SIR-EJ LED Sounder-Beacon

Maximum Sound Output: 100dB @ 1m

Tones: 2 x 8 tones in 2 channels – see tone table on page 11-27

Current: 12-24VAC/DC – 250 - 340 mA
30-80VAC/DC – 250-100mA
120-240VAC – 80-35mA

Protection: IP65

SIR-EJ LED



Dimensions in mm

M-Line Modular Signaling System



Shallow Base



Deep Base



Wall Base



Double Base



Ceiling Base



Pole Base

Mounting Bases

| Order Code | Mounting | Colour | Voltage | Weight (kg) |
|-------------|-------------------------------|--------|-------------|-------------|
| SIR01M90343 | Surface mounting shallow base | Red | 12-24VAC/DC | 0.06 |
| SIR01M90344 | Surface mounting shallow base | White | | |
| SIR01M90367 | Surface mounting shallow base | Grey | | |
| SIR01M90451 | Surface mounting shallow base | Black | | |
| SIR01M90345 | Surface mounting deep base | Red | 12-24VAC/DC | 0.12 |
| SIR01M90346 | Surface mounting deep base | White | | |
| SIR01M90368 | Surface mounting deep base | Grey | | |
| SIR01M90452 | Surface mounting deep base | Black | | |
| SIR01M90442 | Surface mounting deep base | Red | 30-80VAC/DC | 0.17 |
| SIR01M90437 | Surface mounting deep base | White | | |
| SIR01M90432 | Surface mounting deep base | Grey | | |
| SIR01M90455 | Surface mounting deep base | Black | | |
| SIR01M90508 | Surface mounting deep base | Red | 90-240VAC | 0.17 |
| SIR01M90509 | Surface mounting deep base | White | | |
| SIR01M90369 | Surface mounting deep base | Grey | | |
| SIR01M90458 | Surface mounting deep base | Black | | |
| SIR01M90347 | Wall mounting base | Red | 12-24VAC/DC | 0.19 |
| SIR01M90348 | Wall mounting base | White | | |
| SIR01M90370 | Wall mounting base | Grey | | |
| SIR01M90453 | Wall mounting base | Black | | |
| SIR01M90443 | Wall mounting base | Red | 30-80VAC/DC | 0.24 |
| SIR01M90438 | Wall mounting base | White | | |
| SIR01M90433 | Wall mounting base | Grey | | |
| SIR01M90456 | Wall mounting base | Black | | |
| SIR01M90510 | Wall mounting base | Red | 90-240VAC | 0.24 |
| SIR01M90511 | Wall mounting base | White | | |
| SIR01M90371 | Wall mounting base | Grey | | |
| SIR01M90459 | Wall mounting base | Black | | |
| SIR01M90373 | Double wall mounting base | Red | 12-24VAC/DC | 0.26 |
| SIR01M90374 | Double wall mounting base | White | | |
| SIR01M90372 | Double wall mounting base | Grey | | |
| SIR01M90454 | Double wall mounting base | Black | | |
| SIR01M90445 | Double wall mounting base | Red | 30-80VAC/DC | 0.35 |
| SIR01M90440 | Double wall mounting base | White | | |
| SIR01M90435 | Double wall mounting base | Grey | | |
| SIR01M90457 | Double wall mounting base | Black | | |
| SIR01M90513 | Double wall mounting base | Red | 90-240VAC | 0.35 |
| SIR01M90514 | Double wall mounting base | White | | |
| SIR01M90512 | Double wall mounting base | Grey | | |
| SIR01M90460 | Double wall mounting base | Black | | |
| SIR01M90349 | Ceiling flush mounting base* | Red | 12-24VAC/DC | 0.22 |
| SIR01M90375 | Ceiling flush mounting base* | White | 30-80VAC/DC | 0.27 |
| SIR01M90444 | Ceiling flush mounting base* | Red | | |
| SIR01M90439 | Ceiling flush mounting base* | White | | |
| SIR01M90446 | Ceiling flush mounting base* | Red | 90-240VAC | 0.27 |
| SIR01M90376 | Ceiling flush mounting base* | White | | |
| SIR01M90610 | Pole (1½" NPT) mounting base | Grey | 12-24VAC/DC | 0.15 |
| SIR01M90613 | Pole (1½" NPT) mounting base | Black | 30-80VAC/DC | 0.19 |
| SIR01M90611 | Pole (1½" NPT) mounting base | Grey | | |
| SIR01M90614 | Pole (1½" NPT) mounting base | Black | | |
| SIR01M90612 | Pole (1½" NPT) mounting base | Grey | 90-240VAC | 0.19 |
| SIR01M90615 | Pole (1½" NPT) mounting base | Black | | |

* For indoor use only

Shallow Base

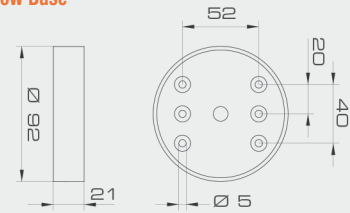

Deep Base

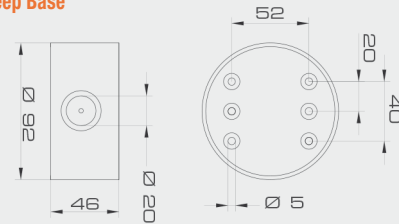

Wall Base

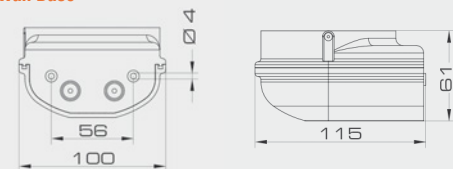

Double Base

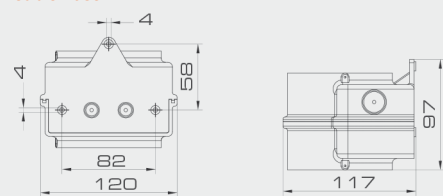

Ceiling Base

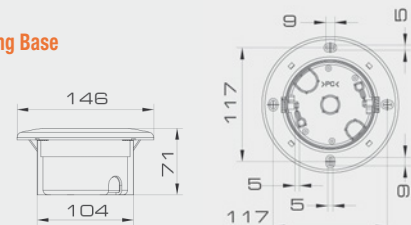

Pole Base

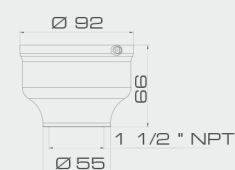

Dimensions in mm

M-Line Modular Signaling System



SIR-E Red



SIR-E LED Red

Economy Sounder and Sounder-Beacon complete with bases
SIR-EJ Sounder and SIR-EJ LED Sounder (without volume control, 2 x 8 tones)

| Order Code | Description | Voltage | Current | Weight (kg) |
|-------------|----------------------------------|--------------|-----------|-------------|
| SIR05M90391 | Sounder shallow base red | 12-24 VAC/DC | 200-300mA | 0.28 |
| SIR05M90392 | Sounder shallow base white | | | |
| SIR05M90393 | Sounder deep base red | 12-24 VAC/DC | 200-300mA | 0.34 |
| SIR05M90394 | Sounder deep base white | | | |
| SIR05M90395 | Sounder deep base red | 90-240 VAC | 75-30mA | 0.37 |
| SIR05M90396 | Sounder deep base white | | | |
| SIR05M90397 | Sounder/LED shallow base red/red | 12-24 VAC/DC | 250-340mA | 0.28 |
| SIR05M90398 | Sounder/LED deep base red/red | | | 0.34 |
| SIR05M90399 | Sounder/LED deep base red/red | 90-240 VAC | 80-35mA | 0.37 |

SIR-E

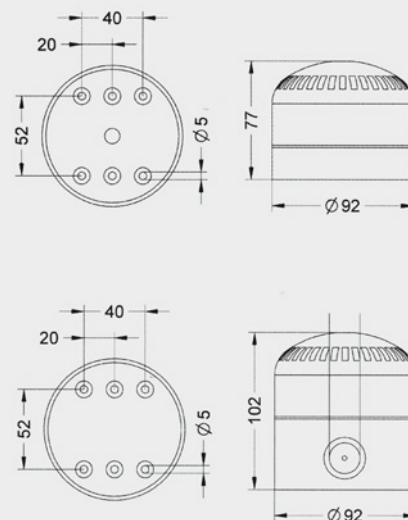

Dimensions in mm

Accessories



| Order Code | Description | Suitable Models | Weight (kg) |
|-------------|------------------------------|---|-------------|
| SIR01M90557 | Stainless steel guard size 0 | XLF with shallow base | 0.07 |
| SIR01M90551 | Stainless steel guard size 1 | SIR-E, SIR-E LED with shallow base XLF with deep base | 0.08 |
| SIR01M90552 | Stainless steel guard size 2 | SIR-E, SIR-E LED with deep base SIR-E MAX, SIR-E LED MAX with shallow base | 0.10 |
| SIR01M90553 | Stainless steel guard size 3 | FLR, SLR with shallow base SIR-E MAX, SIR-E LED MAX with deep base | 0.13 |
| SIR01M90554 | Stainless steel guard size 4 | FLR, SLR with deep base | 0.14 |

Size 0



Size 1



Size 2



Size 3



Size 4

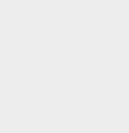

M-Line Modular Signaling System Sounder Tones



SIR-EJ and SIR-EJ LED – stage 1 and 2 tones can be selected independently

| Tone | Stage 1 | Stage 2 |
|------|---|---|
| 1 | 420Hz 0.625s ON / 0.625Hz OFF (Australia AS1670 Alert tone) | 420Hz 0.625s ON / 0.625Hz OFF (Australia AS1670 Alert tone) |
| 2 | 1000-2500Hz 0.5s ON / 0.5s OFF x 3/1.5s OFF (AS1670 Evacuation) | 1000-2500Hz 0.5s ON / 0.5s OFF x 3/1.5s OFF (AS1670 Evacuation) |
| 3 | 500-1200Hz 0.5s ON / 0.5s OFF x 3/1.5s OFF (AS1670 Evacuation) | 500-1200Hz 0.5s ON / 0.5s OFF x 3/1.5s OFF (AS1670 Evacuation) |
| 4 | 500-1200Hz 3.75s ON / 0.25s OFF (AS2220 Evacuation) | 500-1200Hz 3.75s ON / 0.25s OFF (AS2220 Evacuation) |
| 5 | Simulated bell | Simulated bell |
| 6 | Bi-tone 800 and 970Hz, 250ms on, 250ms off | Linear 970Hz |
| 7 | Linear 2850Hz | Modulated 1000-1700Hz |
| 8 | Intermittent 970Hz 1s on, 1s off | Bi Tone 2400-2850Hz 0.465s/0.465s |

SIR-E and SIR-E LED – stage 1 and 2 tones can be selected independently

| | | |
|----|--|--|
| 1 | Bi-tone 600 – 700hz 0.5s/0.5s | Warning 490Hz 0.5s on/1s off |
| 2 | Multi-tone 1000 – 1700hz cycle 0.25s | Evacuation 1 480 – 610Hz 0.5s/0.5s |
| 3 | Modulated 1000 – 1700 cycle 0.8s | Evacuation 2 610Hz |
| 4 | Evacuation 440 – 560hz 565s/565s | Linear 500Hz |
| 5 | Linear 300hz | Linear 970Hz BS5839-1 |
| 6 | linear 660hz | Sweep 500 – 1200Hz cycle 3.75s/0.25s off AS2220 |
| 7 | Linear 750hz | Sweep 1400 – 1600Hz cycle 1.5s NF 48-265 |
| 8 | Linear 2850 | Sweep 1200 – 500Hz cycle 1s DIN 33 404 |
| 9 | Sweep 500 – 1200hz 3.5s on/0.5s off | Intermittent 544Hz 0.625s on/0.625s off |
| 10 | Sweep 500 – 1200Hz 0.5s on/0.5s off x 3 1.5 s off Australia AS1670 | Intermittent 660Hz 6.5s on/ 13s off |
| 11 | Sweep 800-970hz 0.5s on/0.5s off x 3 1.5s off ISO 8201 | Intermittent 970Hz 1s on/1s off Apollo fire system BS5839 |
| 12 | Intermittent 420Hz 0.625s on/0.625s off Australia AS1670 alert tone | Intermittent 2850Hz 0.5s on/0.5s off x 3 1.5s off ISO 8201 high tone |
| 13 | Intermittent 660Hz 0.15s on/0.15s off | Bi-tone 970 – 630Hz 0.5s/0.5s Apollo fire system BS5839 |
| 14 | Intermittent 660Hz 1.8s on/1.8s off | Bi-tone 554 – 440Hz 0.1s/0.4s |
| 15 | Intermittent 660Hz 0.5s on/0.5s off | Bi-tone 440 – 554Hz 0.5s/0.5s |
| 16 | Intermittent 720Hz 0.7s on/0.3s off | Bi-tone 510 – 610Hz 0.5s/0.5s |
| 17 | Intermittent 750Hz 0.33s on/0.5s off | Bi-tone 510 – 610Hz 1s/1s |
| 18 | Intermittent 800Hz 0.25s on/1s off | Bi-tone 600 – 700Hz 1s/1s |
| 19 | Intermittent 970 -800Hz 0.35s /0.35s/0.35s off x 3 1.5s off ISO 8201 | Bi-tone 550 – 1000Hz 0.5s/0.5s |
| 20 | Intermittent 970Hz 0.25s on/0.25s off | Bi-tone 550 – 1000Hz 1s/1s |
| 21 | Intermittent 2850Hz 1s on/1s off | Bi-tone 800 – 1000Hz 0.5s/0.5s |
| 22 | Intermittent 2850Hz 0.25s on/0.25s off | Bi-tone 800 – 1000Hz 1s/1s |
| 23 | Bi-tone 600 – 700Hz 0.5s/0.5s | Bi-tone 1000 – 2000Hz 0.5s/0.5s |
| 24 | Bi-tone 800 – 970Hz 0.25s/0.25s BS5839-1:2002 | Bi-tone 2400 – 2850Hz 0.265s/0.265s |
| 25 | Bi-tone 800 – 970Hz 0.800s/0.800s | Bi-tone 2400 – 2850Hz 0.465s/0.465s |
| 26 | Bi-tone 1000 – 2000Hz 1s/1s | Bi-tone 640 – 970Hz 0.5s/0.5s |
| 27 | Chime 1 single 700-600Hz 0.4s/0.7s single shot ding dong | Bi-tone 490 – 610Hz 0.25s/0.25s |
| 28 | Chime 1 repeating 700-600Hz 0.4s/0.7s off repeating ding dong | Chime 2 single 554-440Hz 0.35s/0.7s single shot ding dong |
| 29 | Chime 1 repeating 700-600 0.25s/0.4 off repeating ding dong | Chime 2 rep 554-440Hz 0.35s/0.7s /0.5s off repeating ding dong |
| 30 | Hooter repeating - 3s on/2s off | Chime 3 single 1300-944Hz 0.5s/1s single shot ding dong |
| 31 | Simulated bell 1850Hz | Chime 3 rep 1300-944Hz 0.5s/1s/0.5s off repeating ding dong |

SONF1

- Electronic sounder up to 100dB
- 10 tones (includes ISO tones to Australian Standards)
- Automatic synchronisation on multi-sounder systems*
- Volume control
- Two stage alarm (DC voltage only) by reversing polarity
- Available in red or white
- Volume control
- IP66



| Order Code | Colour | Voltage | Current |
|------------|--------|-------------|--------------|
| ESS0015RX | Red | 10-30VDC | 25mA @ 24VDC |
| ESS0015WX | White | | |
| ESS0016RX | Red | 24VAC ±10% | 40mA |
| ESS0016WX | White | | |
| ESS0017RX | Red | 115VAC ±10% | 13mA |
| ESS0017WX | White | | |
| ESS0018RX | Red | 230VAC ±10% | 13mA |
| ESS0018WX | White | | |

*Synchronisation requires sounders to be connected to the same power supply

Specifications:

Sound output: 100dB @ 1m
 Sound frequency: 10 tones see tone list on page 11-37
 Protection: IP66
 Temp rating (°C): -25 to +55
 Cable entry: 4 x M20 knockouts
 Rating: Continuous
 Construction: Flame Retardant ABS
 Weight: 0.30Kg

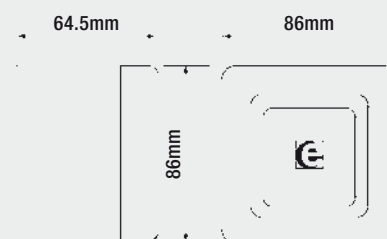

SON2

- Electronic sounder up to 104dB
- 32 tones (includes ISO tones to Australian Standards)
- Automatic synchronisation on multi-sounder systems*
- Three stage alarm
- Available in red or white
- 3 volume levels (reverse polarity stage switching on DC units)
- IP66



| Order Code | Colour | Voltage | Current |
|------------|--------|-------------|---------|
| ESS0020RX | Red | 10-30VDC | 20-80mA |
| ESS0020WX | White | | |
| ESS0022RX | Red | 24VAC ±10% | 25-90mA |
| ESS0022WX | White | | |
| ESS0024RX | Red | 115VAC ±10% | 24mA |
| ESS0024WX | White | | |
| ESS0025RX | Red | 230VAC ±10% | 12mA |
| ESS0025WX | White | | |

*Synchronisation requires sounders to be connected to the same power supply

Specifications:

Sound output: 104dB @ 1m
 Sound frequency: 32 tones see tone list on page 11-37
 Protection: IP66
 Temp rating (°C): -25 to +55
 Cable entry: 4 x M20 knockouts
 Rating: Continuous
 Construction: Flame Retardant ABS
 Weight: 0.30Kg (DC), 0.40kg (AC)

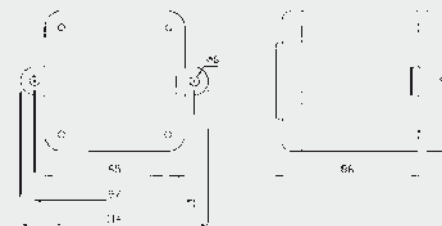

Dimensions in mm

SONFL1



- Electronic sounder with xenon or LED beacon
- 10 tones (includes ISO tones to Australian Standards)
- Automatic synchronisation on multi-sounder systems**
- Sounder and beacon controlled independently
- Volume control
- Two stage alarm (DC voltage only) by reversing polarity
- Available in red or white housing
- IP66

Specifications:

| | |
|-------------------|--------------------------------------|
| Sound output: | 100dB @ 1m |
| Sound frequency: | 10 tones see tone list on page 11-37 |
| Flash energy: | 5J (xenon version) |
| Light output: | Xenon 200cd(e) LED 120cd(e) |
| Flash rate: | Xenon 60fpm LED 120fpm or steady |
| Protection: | IP66 |
| Temp rating (°C): | -25 to +55 |
| Cable entry: | 4 x M20 knockouts |
| Rating: | Continuous |
| Construction: | Flame Retardant ABS |
| Weight: | 0.50Kg |

| Order Code | Housing Colour | Voltage | Current Sounder | Current Beacon |
|-----------------------------------|----------------|-------------|-----------------|----------------|
| SONFL1 – with xenon beacon | | | | |
| ESS0050R* | Red | 12VDC | 25mA | 500mA |
| ESS0050W* | White | | | |
| ESS0051R* | Red | 24VDC | 25mA | 250mA |
| ESS0051W* | White | | | |
| ESS0052R* | Red | 24VAC ±10% | 40mA | 300mA |
| ESS0052W* | White | | | |
| ESS0054R* | Red | 115VAC ±10% | 13mA | 70mA |
| ESS0054W* | White | | | |
| ESS0053R* | Red | 230VAC ±10% | 13mA | 35mA |
| ESS0053W* | White | | | |

*Specify colour A = Amber, B = Blue, C = Clear, G = Green, R = Red

| Order Code | Housing Colour | Voltage | Current Sounder | Current Beacon |
|-----------------------------------|----------------|-------------|-----------------|----------------|
| SONFL1 – with H LED beacon | | | | |
| ESS0051R*LED | Red | 10-30VDC | 25mA @ 24VDC | 115mA @ 24VDC |
| ESS0051W*LED | White | | | |
| ESS0054R*LED | Red | 115VAC ±10% | 13mA | 70mA |
| ESS0054W*LED | White | | | |
| ESS0053R*LED | Red | 230VAC ±10% | 13mA | 35mA |
| ESS0053W*LED | White | | | |

*Specify colour A = Amber, B = Blue, G = Green, R = Red
Note lens colour on LED beacon is clear

**Synchronisation requires sounders to be connected to the same power supply

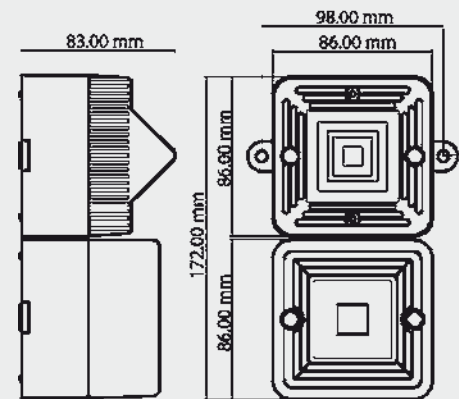

SON4

- Electronic sounder with xenon or LED beacon
- 10 tones (LED) or 32 tones (xenon), includes ISO tones to Australian Standards
- Automatic synchronisation on multi-sounder systems**
- Volume control (3 volume levels on xenon version)
- Three stage alarm (reverse polarity stage switching on DC units)
- Available in red or white housing
- IP66



Specifications:

| | |
|-------------------|--|
| Sound output: | SON4L 100dB @ 1m SON4 104dB @ 1m |
| Sound frequency: | LED 10 tones see tone list on page 11-38 Xenon 32 tones see tone list on page 11-37 |
| Light output: | LED 3cd(e) Xenon 11cd(e) |
| Flash rate: | LED 120fpm Xenon 60fpm |
| Protection: | IP66 |
| Temp rating (°C): | -25 to +55 |
| Cable entry: | 4 x M20 knockouts |
| Rating: | Continuous |
| Construction: | Flame Retardant ABS |
| Weight: | 0.30kg (DC), 0.40kg (AC) |

| Order Code | Housing Colour | Voltage | Current |
|---------------------------------|----------------|-------------|----------|
| SON4 – with xenon beacon | | | |
| ESS0040R*X | Red | 18-30VDC | 80-110mA |
| ESS0040W*X | White | | |
| ESS0042R*X | Red | 115VAC ±10% | 35mA |
| ESS0042W*X | White | | |
| ESS0043R*X | Red | 230VAC ±10% | 20mA |
| ESS0043W*X | White | | |

*Specify colour A = Amber, B = Blue, G = Green, R = Red

| | | | |
|----------------------------------|-------|-------------|------|
| SON4L – with H LED beacon | | | |
| ESS0045LR* | Red | 24VDC ±25% | 50mA |
| ESS0045LW* | White | | |
| ESS0046LR* | Red | 115VAC ±10% | 25mA |
| ESS0046LW* | White | | |
| ESS0048LR* | Red | 230VAC ±10% | 20mA |
| ESS0048LW* | White | | |

*Specify colour A = Amber, R = Red

**Synchronisation requires sounders to be connected to the same power supply

SON4

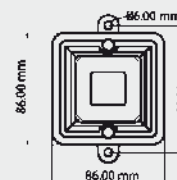
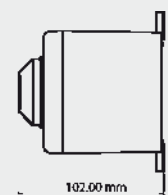

SON4L AC

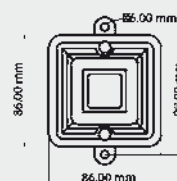
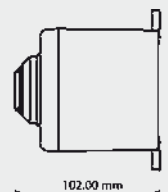

SON4L DC

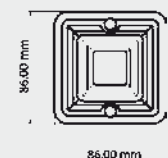
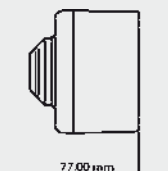

A100-AL100

- Electronic sounder and sounder beacon
- 32 tones, includes ISO tones to Australian Standards
- Automatic synchronisation on multi-sounder systems**
- Sounder and beacon controlled independently
- Volume control (100db max - 90dB min on tone 2)
- Three stage alarm (reverse polarity stage switching on DC units)
- IP66



Specifications:

Sound output: Max 104dB @ 1m
Sound frequency: 32 tones see tone list on page 11-38
Flash energy: 5J (xenon version)
Light output: Xenon 200cd(e)
 LED 120cd(e)
Flash rate: Xenon 60fpm
 LED 120fpm or steady
Protection: IP66
Temp rating (°C): -25 to +55
Cable entry: 3 x M20 knockouts
Rating: Continuous
Construction: Flame Retardant ABS

| Order Code | Voltage | Current Sounder | Current Beacon | Weight (kg) |
|---|-------------|-----------------|----------------|-------------|
| A100 sounder | | | | |
| ESS1010 | 10-30VDC | 25mA @ 24VDC | - | 0.26 |
| ESS1012 | 24VAC ±10% | 40mA | - | 0.37 |
| ESS1015 | 35-60VDC | 50mA @ 48VDC | - | 0.26 |
| ESS1020 | 115VAC ±10% | 20mA | - | 0.37 |
| ESS1030 | 230VAC ±10% | 15mA | - | |
| AL100 sounder-beacon – with xenon beacon | | | | |
| ESS1105* | 10-14VDC | 25mA | 500mA | 0.46 |
| ESS1110* | 20-28VDC | 25mA | 250mA | |
| ESS1112* | 24VAC ±10% | 40mA | 300mA | 0.57 |
| ESS1115* | 42-54VDC | 50mA | 175mA | 0.46 |
| ESS1120* | 115VAC ±10% | 20mA | 70mA | 0.57 |
| ESS1130* | 230VAC ±10% | 15mA | 35mA | |

*Specify colour A = Amber, B = Blue, C = Clear, G = Green, R = Red

| Order Code | Voltage | Current Sounder | Current Beacon | Weight (kg) |
|---|-------------|-----------------|----------------|-------------|
| AL100 sounder-beacon – with H LED beacon | | | | |
| ESS1110*LED | 10-30VDC | 25mA @ 24VDC | 115mA @ 24VDC | 0.46 |
| ESS1120*LED | 115VAC ±10% | 20mA | 70mA | 0.57 |
| ESS1130*LED | 230VAC ±10% | 15mA | 35mA | |

*Specify colour A = Amber, B = Blue, G = Green, R = Red
 Note lens colour on LED beacon is clear

**Synchronisation requires sounders to be connected to the same power supply

A100

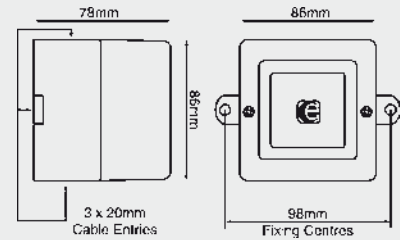

AL100

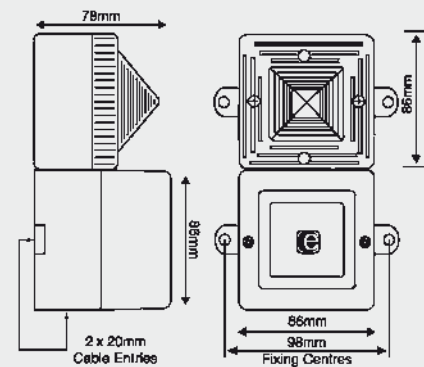

A105N-AL105N-AB105LDA

- Electronic sounder and sounder beacon
- 32 tones, includes ISO tones to Australian Standards
- Automatic synchronisation on multi-sounder systems**
- Sounder and beacon controlled independently
- Volume control (105dB max. - 96dB min on tone 2)
- Three stage alarm (reverse polarity stage switching on DC units)
- IP66



Specifications:

Sound output: Max 112dB @ 1m
Sound frequency: 32 tones see tone list on page 11-38
Flash energy: 5J (xenon version)
Light output: Xenon 200cd(e)
 LDA LED 19cd(e)
Flash rate: Xenon 60fpm
 LDA LED – multi-function see list on page 11-6
Protection: IP66 (IP65 on AB105LDA)
Temp rating (°C): -25 to +55
Cable entry: 2 x M20 knockouts
Rating: Continuous
Construction: Flame Retardant ABS

| Order Code | Voltage | Current Sounder | Current Beacon | Weight (kg) |
|------------|---------|-----------------|----------------|-------------|
|------------|---------|-----------------|----------------|-------------|

A105N sounder

| | | | | |
|----------|-------------|--------------|---|------|
| ESS2010N | 10-30VDC | 25mA @ 24VDC | - | 0.75 |
| ESS2012N | 24VAC ±10% | 40mA | - | 1.00 |
| ESS2015N | 35-60VDC | 50mA @ 48VDC | - | 0.75 |
| ESS2020N | 115VAC ±10% | 20mA | - | 1.00 |
| ESS2030N | 230VAC ±10% | 15mA | - | |

AL105N sounder-beacon – with xenon beacon

| | | | | |
|-----------|-------------|------|-------|------|
| ESS2105N* | 10-14VDC | 25mA | 500mA | 0.95 |
| ESS2110N* | 20-28VDC | 25mA | 250mA | |
| ESS2112N* | 24VAC ±10% | 40mA | 300mA | 1.20 |
| ESS2115N* | 42-54VDC | 50mA | 175mA | 0.95 |
| ESS2120N* | 115VAC ±10% | 20mA | 70mA | 1.20 |
| ESS2130N* | 230VAC ±10% | 15mA | 35mA | |

*Specify colour A = Amber, B = Blue, C = Clear, G = Green, R = Red

AB105LDA sounder-beacon – with multi-function LED beacon

| | | | | |
|-------------|-------------|--------------|---------------|------|
| ESSAB2110L* | 10-30VDC | 25mA @ 24VDC | 130mA @ 24VDC | 1.00 |
| ESSAB2115L* | 35-60VDC | 50mA @ 48VDC | 80mA @ 48VDC | |
| ESSAB2120L* | 115VAC ±10% | 20mA | 90mA | 1.25 |
| ESSAB2130L* | 230VAC ±10% | 15mA | 50mA | |

*Specify colour A = Amber, B = Blue, G = Green, R = Red

**Synchronisation requires sounders to be connected to the same power supply

A105N

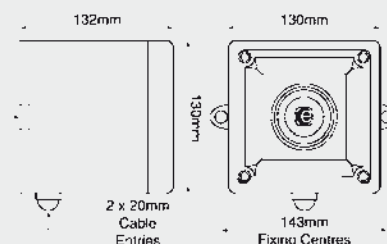

AL105N

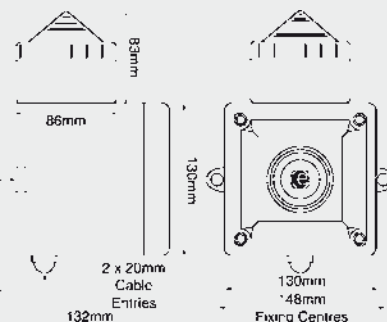

AB105LDA

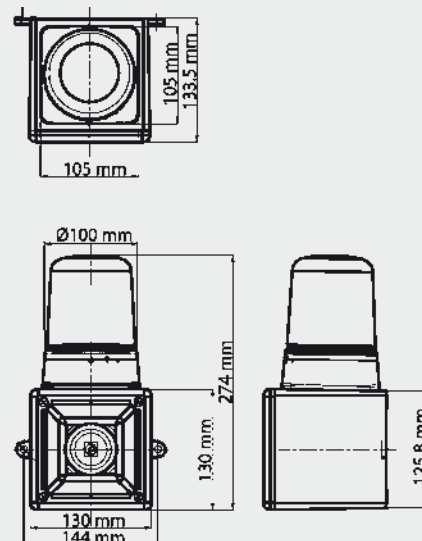

A112N-AL112N-AB112LDA

- Electronic sounder and sounder beacon
- 45 tones, includes ISO tones to Australian Standards
- Automatic synchronisation on multi-sounder systems**
- Sounder and beacon controlled independently
- Volume control (112dB max. - 100dB min. on tone 2)
- Three stage alarm (reverse polarity stage switching on DC units)***
- IP66



Specifications:

Sound output: Max 119dB @ 1m
Sound frequency: 45 tones see tone list on page 11-39
Flash energy: 5J (xenon version)
Light output: Xenon 200cd(e)
 LDA LED 19cd(e)
Flash rate: Xenon 60fpm
 LDA LED – multifunction see list on page 11-6
Protection: IP66 (IP65 on AB112LDA)
Temp rating (°C): -25 to +55
Cable entry: 2 x M20 knockouts
Rating: Continuous
Construction: Flame Retardant ABS

| Order Code | Voltage | Current Sounder | Current Beacon | Weight (kg) |
|------------|---------|-----------------|----------------|-------------|
|------------|---------|-----------------|----------------|-------------|

A112N sounder

| | | | | |
|----------|-------------|---------------|---|------|
| ESS3012N | 10-30VDC | 200mA @ 24VDC | - | 1.80 |
| ESS3013N | 24VAC ±10% | 500mA | - | 2.10 |
| ESS3016N | 35-60VDC | 120mA @ 48VDC | - | 1.80 |
| ESS3021N | 115VAC ±10% | 100mA | - | 2.10 |
| ESS3031N | 230VAC ±10% | 60mA | - | |

AL112N sounder-beacon – with xenon beacon

| | | | | |
|-----------|-------------|-------|-------|------|
| ESS3106N* | 10-14VDC | 200mA | 500mA | 2.00 |
| ESS3112N* | 20-28VDC | 200mA | 250mA | |
| ESS3113N* | 24VAC ±10% | 500mA | 300mA | 2.30 |
| ESS3116N* | 42-54VDC | 120mA | 175mA | 2.00 |
| ESS3121N* | 115VAC ±10% | 100mA | 70mA | 2.30 |
| ESS3131N* | 230VAC ±10% | 60mA | 35mA | |

*Specify colour A = Amber, B = Blue, C = Clear, G = Green, R = Red

AB112LDA sounder-beacon – with multi-function LED beacon

| | | | | |
|-------------|-------------|---------------|---------------|------|
| ESSAB3112L* | 10-30VDC | 200mA @ 24VDC | 130mA @ 24VDC | 2.10 |
| ESSAB3116L* | 35-60VDC | 120mA @ 48VDC | 80mA @ 48VDC | |
| ESSAB3121L* | 115VAC ±10% | 100mA | 90mA | 2.70 |
| ESSAB3131L* | 230VAC ±10% | 60mA | 50mA | |

*Specify colour A = Amber, B = Blue, G = Green, R = Red

**Synchronisation requires sounders to be connected to the same power supply

***AB112LDA also features remote switching of 2nd and 3rd stage flash patterns on DC units

A112N

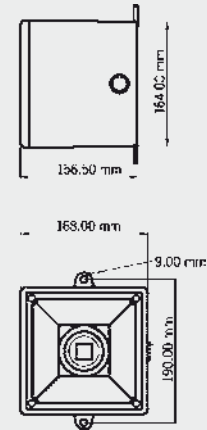

AL112N

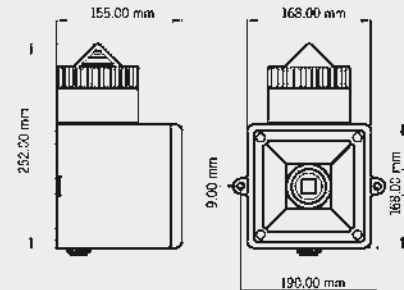

AB112LDA

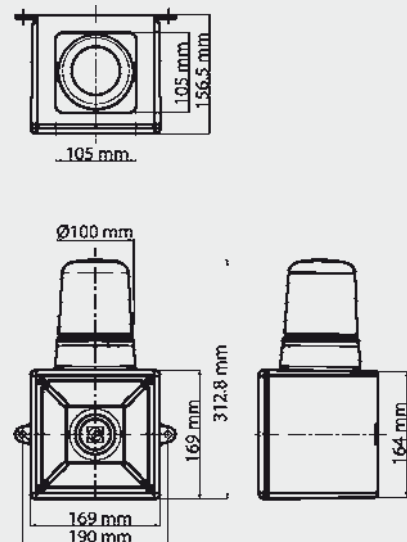

A121-AL121-AB121LDA-AB121STR

- Electronic sounder and sounder beacon
- 45 tones, includes ISO tones to Australian Standards
- Automatic synchronisation on multi-sounder systems**
- Sounder and beacon controlled independently
- Volume control (121dB max. - 112dB min. on tone 2)
- Three stage alarm (reverse polarity stage switching on DC units)***
- IP66



Specifications:

| | |
|-------------------|--|
| Sound output: | Max 126dB @ 1m |
| Sound frequency: | 45 tones see tone list on page 11-39 |
| Flash energy: | 5J (AL121N) 15J (AB121STR) |
| Light output: | Xenon 200cd(e) (AL121) 500cd(e) (AB121STR) LDA LED 30cd(e) |
| Flash rate: | Xenon 60fpm (AB121STR has 3 flash patterns selectable on board) LDA LED – multifunction see list on page 11-7 |
| Protection: | IP66 (IP65 on AB121LDA and AB121STR) |
| Temp rating (°C): | -25 to +55 |
| Cable entry: | 2 x M20 knockouts |
| Rating: | Continuous |
| Construction: | Flame Retardant ABS |

| Order Code | Voltage | Current Sounder | Current Beacon | Weight (kg) |
|--|-------------|-----------------|----------------|-------------|
| A121 sounder | | | | |
| ESS5012 | 10-30VDC | 950mA @ 24VDC | - | 2.10 |
| ESS5013 | 24VAC ±10% | 1.0A | - | 2.70 |
| ESS5016 | 35-60VDC | 600mA @ 48VDC | - | 2.10 |
| ESS5021 | 115VAC ±10% | 240mA | - | 2.70 |
| ESS5031 | 230VAC ±10% | 120mA | - | 2.70 |
| AL121 sounder-beacon – with 5J xenon beacon | | | | |
| ESS5112* | 20-28VDC | 950mA | 250mA | 2.30 |
| ESS5113* | 24VAC ±10% | 1.0A | 300mA | 2.90 |
| ESS5116* | 42-54VDC | 600mA @ 48VDC | 175mA | 2.30 |
| ESS5121* | 115VAC ±10% | 240mA | 70mA | 2.90 |
| ESS5131* | 230VAC ±10% | 120mA | 35mA | 2.90 |
| AB121STR sounder-beacon – with 15J xenon beacon | | | | |
| ESSAB5112S* | 20-28VDC | 950mA | 870mA | 2.65 |
| ESSAB5116S* | 42-54VDC | 600mA @ 48VDC | 480mA | 3.25 |
| ESSAB5121S* | 115VAC ±10% | 240mA | 400mA | 3.25 |
| ESSAB5131S* | 230VAC ±10% | 120mA | 225mA | 3.25 |

*Specify colour A = Amber, B = Blue, C = Clear, G = Green, R = Red

| Order Code | Voltage | Current Sounder | Current Beacon | Weight (kg) |
|---|-------------|-----------------|----------------|-------------|
| AB121LDA sounder-beacon – with multi-function LED beacon | | | | |
| ESSAB5112L* | 10-30VDC | 200mA @ 24VDC | 400mA @ 24VDC | 2.65 |
| ESSAB5116L* | 35-60VDC | 120mA @ 48VDC | 400mA @ 48VDC | 3.25 |
| ESSAB5121L* | 115VAC ±10% | 100mA | 140mA | 3.25 |
| ESSAB5131L* | 230VAC ±10% | 60mA | 70mA | 3.25 |

*Specify colour A = Amber, B = Blue, G = Green, R = Red

**Synchronisation requires sounders to be connected to the same power supply
 ***AB121LDA also features remote switching of 2nd and 3rd stage flash patterns on DC units

A121

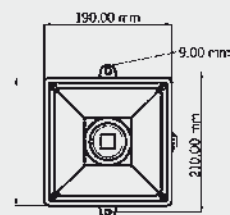
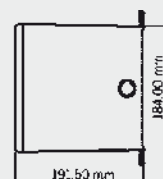

AB121LDA

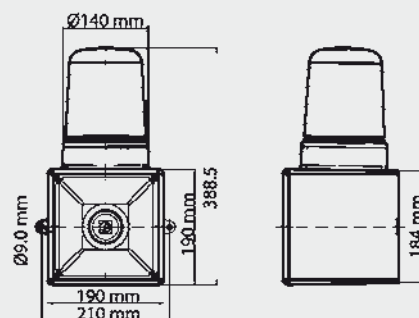
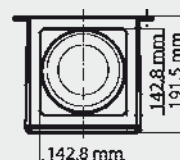

AL121

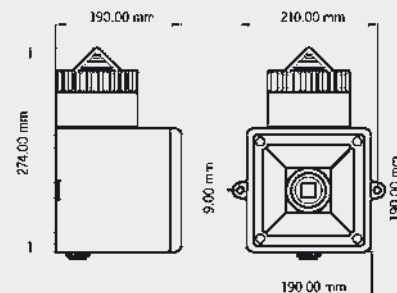

D105-DL105X-DL105H

- Heavy duty marine grade aluminium housing
- Electronic sounder and sounder beacon with choice of xenon or LED
- 32 tones, includes ISO tones to Australian Standards
- Automatic synchronisation on multi-sounder systems**
- Sounder and beacon controlled independently
- Volume control
- Three stage alarm (reverse polarity stage switching on DC units)
- IP66



| Order Code | Voltage | Current Sounder | Current Beacon | Weight (kg) |
|------------------------------------|--------------|-----------------|----------------|-------------|
| D105 sounder red housing*** | | | | |
| ESSD2010 | 10-30VDC | 25mA @ 24VDC | - | 1.6 |
| ESSD2012 | 24VAC ±10% | 40mA | - | 1.85 |
| ESSD2015 | 35-60VDC | 50mA @ 48VDC | - | 1.6 |
| ESSD2020 | 115VAC ±10% | 20mA | - | 1.85 |
| ESSD2030 | 230VAC ± 10% | 15mA | - | |

| | | | | |
|---|--------------|------|-------|------|
| DL105X sounder-beacon – with xenon beacon red housing*** | | | | |
| ESSD2105* | 10-14VDC | 25mA | 380mA | 2.10 |
| ESSD2110* | 20-28VDC | 25mA | 250mA | |
| ESSD2112* | 24VAC ±10% | 40mA | 300mA | 2.35 |
| ESSD2115* | 42-54VDC | 50mA | 175mA | 2.10 |
| ESSD2120* | 115VAC ±10% | 20mA | 70mA | 2.35 |
| ESSD2130* | 230VAC ± 10% | 15mA | 35mA | |

*Specify lens colour A = Amber, B = Blue, C = Clear, G = Green, R = Red

| | | | | |
|---|--------------|--------------|---------------|------|
| DL105H sounder-beacon – with LED beacon red housing*** | | | | |
| ESSD2210* | 10-30VDC | 25mA @ 24VDC | 157mA @ 24VDC | 2.10 |
| ESSD2215* | 35-60VDC | 50mA @ 48VDC | 55mA @ 48VDC | |
| ESSD2220* | 115VAC ±10% | 20mA | 60mA | 2.35 |
| ESSD2230* | 230VAC ± 10% | 15mA | 35mA | |

*Specify LED colour A = Amber, B = Blue, G = Green, R = Red

**Synchronisation requires sounders to be connected to the same power supply

***Grey (RAL7038) housing available on request

Specifications:

Maximum sound output: 112dB @ 1m
Nominal sound output: 105dB @ 1m (105dB max. - 65dB min. on tone 2 with volume control)
Sound frequency: 3 stages -32 tones see tone list on page 11-38
Flash energy: 5J (xenon version)
Light output: Xenon 200cd(e)
LED 176cd(e) (LED versions have clear lens with coloured LED's)
Xenon 60fpm
LED – steady or flashing 120fpm
Protection: IP66
Temp rating (°C): -25 to +55
Cable entry: 2 x M20 x 1.5mm threaded cable entries
Rating: Continuous
Construction: Marine grade aluminium A1 Si12 Cu

D105

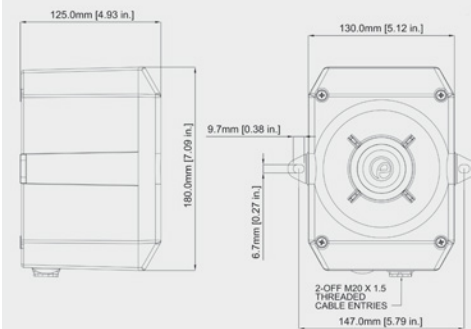

DL105

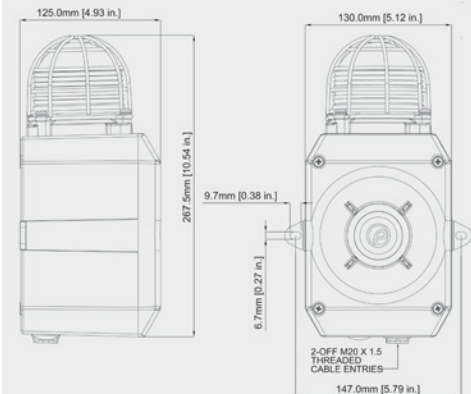

D112-DL112X-DL112H

- Heavy duty marine grade aluminium housing
- Electronic sounder and sounder beacon with choice of xenon or LED
- 45 tones, includes ISO tones to Australian Standards
- Automatic synchronisation on multi-sounder systems**
- Sounder and beacon controlled independently
- Volume control
- Three stage alarm (reverse polarity stage switching on DC units)
- IP66



Specifications:

Maximum sound output: 119dB @ 1m
Nominal sound output: 112dB @ 1m 112dB max. - 100dB min. on tone 2 with volume control)
Sound frequency: 3 stages -45 tones see tone list on page 11-39
Flash energy: 5J (xenon version)
Light output: Xenon 200cd(e)
LED 176cd(e) (LED versions have clear lens with coloured LED's)
Xenon 60fpm
LED – steady or flashing 120fpm
Protection: IP66
Temp rating (°C): -25 to +55
Cable entry: 2 x M20 x 1.5mm threaded cable entries
Rating: Continuous
Construction: Marine grade aluminium A1 Si12 Cu

| Order Code | Voltage | Current Sounder | Current Beacon | Weight (kg) |
|------------------------------------|--------------|-----------------|----------------|-------------|
| D112 sounder red housing*** | | | | |
| ESSD3010 | 10-30VDC | 200mA @ 24VDC | - | 1.6 |
| ESSD3012 | 24VAC ±10% | 500mA | - | 1.85 |
| ESSD3015 | 35-60VDC | 120mA @ 48VDC | - | 1.6 |
| ESSD3020 | 115VAC ±10% | 100mA | - | 1.85 |
| ESSD3030 | 230VAC ± 10% | 60mA | - | 1.85 |

| | | | | |
|---|--------------|-------|-------|------|
| DL112X sounder-beacon – with xenon beacon red housing*** | | | | |
| ESSD3105* | 10-14VDC | 200mA | 380mA | 2.80 |
| ESSD3110* | 20-28VDC | 200mA | 250mA | 2.80 |
| ESSD3112* | 24VAC ±10% | 500mA | 300mA | 3.10 |
| ESSD3115* | 42-54VDC | 120mA | 175mA | 2.80 |
| ESSD3120* | 115VAC ±10% | 100mA | 70mA | 3.10 |
| ESSD3130* | 230VAC ± 10% | 60mA | 35mA | 3.10 |

*Specify lens colour A = Amber, B = Blue, C = Clear, G = Green, R = Red

| | | | | |
|---|--------------|---------------|---------------|------|
| DL112H sounder-beacon – with LED beacon red housing*** | | | | |
| ESSD3210* | 10-30VDC | 200mA @ 24VDC | 157mA @ 24VDC | 2.80 |
| ESSD3215* | 35-60VDC | 120mA @ 48VDC | 55mA @ 48VDC | 2.80 |
| ESSD3220* | 115VAC ±10% | 100mA | 60mA | 3.10 |
| ESSD3230* | 230VAC ± 10% | 60mA | 35mA | 3.10 |

*Specify LED colour A = Amber, B = Blue, G = Green, R = Red

**Synchronisation requires sounders to be connected to the same power supply

***Grey (RAL7038) housing available on request

D112

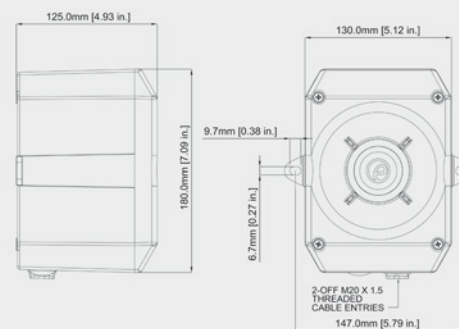

DL112

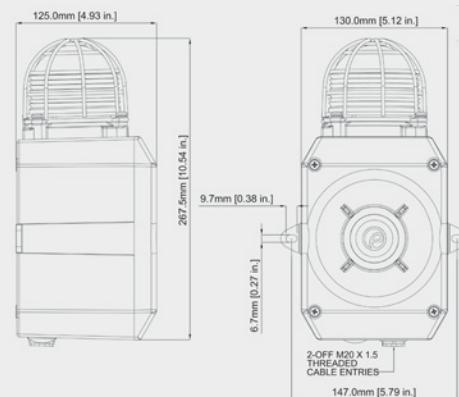

SONF1 DC Tones (SONFL1)

| Stage 1 | Description | Sound Output db@1m | Stage 2 |
|---------|--|--------------------|---------|
| Tone 1 | 500/1200Hz @ 0.3Hz 0.5 sec Slow Whoop | 99dB | Tone 8 |
| Tone 2 | Slow whoop 500/1200Hz at 0.3Hz with 0.5 second gap repeated | 100dB | Tone 1 |
| Tone 3 | 1200/500Hz @ 1Hz - DIN / PFEER P.T.A.P | 99dB | Tone 8 |
| Tone 4 | AS2220: 420Hz repeating 0.625 sec on, 0.625 sec off. | 97dB | Tone 9 |
| Tone 5 | Bell | 95dB | Tone 1 |
| Tone 6 | 800/1000Hz @ 7Hz Sweeping | 99dB | Tone 8 |
| Tone 7 | AS1670: 500-1200Hz Sweeping 2 sec on 1 sec off | 100dB | Tone 10 |
| Tone 8 | 1000Hz Continuous - PFEER Toxic Gas. | 100dB | - |
| Tone 9 | AS2220: 500-1200Hz Sweeping 3.75 sec on 0.25 sec off (15 cycles/min) | 100dB | - |
| Tone 10 | AS1670: 1500-500Hz 0.5 sec on 0.5 sec off x 3 with 1.5 sec gap | 100dB | - |

SONF1 AC Tones (SONFL1)

| Stage 1 | Description | Sound Output db@1m | Stage 2 |
|---------|--|--------------------|---------|
| Tone 1 | 800/1000Hz @ 0.25 sec Alternating | 99dB | - |
| Tone 2 | 500/1200Hz @ 0.3Hz 0.5 sec Slow Whoop | 100dB | - |
| Tone 3 | 1200/500Hz @ 1Hz - DIN / PFEER P.T.A.P. | 99dB | - |
| Tone 4 | AS1670: 1500-500Hz 0.5 sec on 0.5 sec off x 3 with 1.5 sec gap | 100dB | - |
| Tone 5 | 1000Hz Continuous - PFEER Toxic Gas | 100dB | - |
| Tone 6 | Bell | 95dB | - |
| Tone 7 | AS1670: 500-1200Hz Sweeping 2 sec on 1 sec off | 100dB | - |
| Tone 8 | 2400/2900Hz @ 50Hz Sweeping | 100dB | - |
| Tone 9 | AS2220: 420Hz repeating 0.625 sec on, 0.625 sec off. | 97dB | - |
| Tone 10 | AS2220: 500-1200Hz Sweeping 3.75 sec on 0.25 sec off (15 cycles/min) | 100dB | - |

SON2 – SON4 xenon Tones

| Stage 1 | Description | Sound Output db@1m | Stage 2 | Stage 3 |
|---------|--|--------------------|---------|---------|
| Tone 1 | 340 Hz Continuous | 93dB | Tone 2 | Tone 5 |
| Tone 2 | 800/1000Hz @ 0.25 sec Alternating | 101dB | Tone 17 | Tone 5 |
| Tone 3 | 500/1200Hz @ 0.3Hz 0.5 sec Slow Whoop | 101dB | Tone 2 | Tone 5 |
| Tone 4 | 800/1000Hz @ 1Hz Sweeping | 101dB | Tone 6 | Tone 5 |
| Tone 5 | 2400Hz Continuous | 103dB | Tone 3 | Tone 26 |
| Tone 6 | 2400/2900Hz @ 7Hz Sweeping | 100dB | Tone 7 | Tone 5 |
| Tone 7 | 2400/2900Hz @ 1Hz Sweeping | 101dB | Tone 10 | Tone 5 |
| Tone 8 | 500/1200/500Hz @ 0.3Hz Sweeping | 100dB | Tone 2 | Tone 5 |
| Tone 9 | 1200/500Hz @ 1Hz - DIN / PFEER P.T.A.P. | 101dB | Tone 15 | Tone 2 |
| Tone 10 | 2400/2900Hz @ 2Hz Alternating | 104dB | Tone 7 | Tone 5 |
| Tone 11 | 1000Hz @ 1Hz Intermittent | 101dB | Tone 2 | Tone 5 |
| Tone 12 | 800/1000Hz @ 0.875Hz Alternating | 101dB | Tone 4 | Tone 5 |
| Tone 13 | 2400Hz @ 1Hz Intermittent | 103dB | Tone 15 | Tone 5 |
| Tone 14 | 800Hz 0.25 sec on, 1 sec off Intermittent | 103dB | Tone 4 | Tone 5 |
| Tone 15 | 800Hz Continuous | 103dB | Tone 2 | Tone 5 |
| Tone 16 | AS2220: 420Hz repeating 0.625 sec on, 0.625 sec off. | 91dB | Tone 18 | Tone 5 |
| Tone 17 | 544Hz (100mS)/440Hz (400mS) - NF S 32-001 | 100dB | Tone 2 | Tone 27 |
| Tone 18 | AS2220: 500-1200Hz Sweeping 3.75 sec on 0.25 sec off (15 cycles/min) | 100dB | Tone 16 | Tone 5 |
| Tone 19 | 1.4KHz-1.6KHz 1s, 1.6KHz-1.4KHz 0.5s -NFC48-265 | 98dB | Tone 2 | Tone 5 |
| Tone 20 | 660Hz Continuous | 96dB | Tone 2 | Tone 5 |
| Tone 21 | 554Hz/440Hz @ 1Hz Alternating | 100dB | Tone 2 | Tone 5 |
| Tone 22 | 544Hz @ 0.875 sec. Intermittent | 100dB | Tone 2 | Tone 5 |
| Tone 23 | 800Hz @ 2Hz Intermittent | 97dB | Tone 6 | Tone 5 |
| Tone 24 | 800/1000Hz @ 50Hz Sweeping | 101dB | Tone 29 | Tone 5 |
| Tone 25 | 2400/2900Hz @ 50Hz Sweeping | 101dB | Tone 29 | Tone 5 |
| Tone 26 | 1000Hz @ 1Hz Intermittent | 101dB | Tone 5 | Tone 15 |
| Tone 27 | 554Hz Continuous | 101dB | Tone 26 | Tone 5 |
| Tone 28 | 440Hz Continuous | 97dB | Tone 2 | Tone 5 |
| Tone 29 | 800/1000Hz @ 7Hz Sweeping | 101dB | Tone 7 | Tone 5 |
| Tone 30 | AS1670: 1500-500Hz 0.5 sec on 0.5 sec off x 3 with 1.5 sec gap | 100dB | Tone 32 | Tone 26 |
| Tone 31 | 660/1200Hz @ 1Hz Sweeping | 101dB | Tone 26 | Tone 5 |
| Tone 32 | AS1670: 500-1200Hz Sweeping 2 sec on 1 sec off | 100dB | Tone 30 | Tone 26 |

SON4L LED Tones

| Stage 1 | Description | Sound Output db@1m | Stage 2 | Stage 3 |
|---------|--|--------------------|---------|---------|
| Tone 1 | 800/1000Hz @ 0.25 sec Alternating | 99dB | Tone 8 | Tone 5 |
| Tone 2 | 500/1200Hz @ 0.3Hz 0.5 sec Slow Whoop | 100dB | Tone 1 | Tone 8 |
| Tone 3 | 1200/500Hz @ 1Hz - DIN / PFEER P.T.A.P. | 99dB | Tone 1 | Tone 8 |
| Tone 4 | AS1670: 1500-500Hz 0.5 sec on 0.5 sec off x 3 with 1.5 sec gap | 100dB | Tone 7 | Tone 2 |
| Tone 5 | 1000Hz Continuous - PFEER Toxic Gas | 100dB | Tone 1 | Tone 6 |
| Tone 6 | Bell | 95dB | Tone 1 | Tone 8 |
| Tone 7 | AS1670: 500-1200Hz Sweeping 2 sec on 1 sec off | 100dB | Tone 4 | Tone 1 |
| Tone 8 | 2400/2900Hz @ 50Hz Sweeping | 100dB | Tone 5 | Tone 1 |
| Tone 9 | AS2220: 420Hz repeating 0.625 sec on, 0.625 sec off. | 97dB | Tone 10 | Tone 5 |
| Tone 10 | AS2220: 500-1200Hz Sweeping 3.75 sec on 0.25 sec off (15 cycles/min) | 100dB | Tone 6 | Tone 5 |

A100-A105N Tones

| | | | | |
|---------|--|-----------|---------|---------|
| Tone 1 | 340 Hz Continuous | 93/102dB | Tone 2 | Tone 5 |
| Tone 2 | 800/1000Hz @ 0.25 sec Alternating | 101/106dB | Tone 17 | Tone 5 |
| Tone 3 | 500/1200Hz @ 0.3Hz 0.5 sec Slow Whoop | 101/106B | Tone 2 | Tone 5 |
| Tone 4 | 800/1000Hz @ 1Hz Sweeping | 101/106dB | Tone 6 | Tone 5 |
| Tone 5 | 2400Hz Continuous | 103/112dB | Tone 3 | Tone 20 |
| Tone 6 | 2400/2900Hz @ 7Hz Sweeping | 100/108dB | Tone 7 | Tone 5 |
| Tone 7 | 2400/2900Hz @ 1Hz Sweeping | 101/108dB | Tone 10 | Tone 5 |
| Tone 8 | 500/1200/500Hz @ 0.3Hz Sweeping | 100/106dB | Tone 2 | Tone 5 |
| Tone 9 | 1200/500Hz @ 1Hz - DIN / PFEER P.T.A.P. | 101/106dB | Tone 15 | Tone 2 |
| Tone 10 | 2400/2900Hz @ 2Hz Alternating | 104/110dB | Tone 7 | Tone 5 |
| Tone 11 | 1000Hz @ 1Hz Intermittent | 101/106dB | Tone 2 | Tone 5 |
| Tone 12 | 800/1000Hz @ 0.875Hz Alternating | 101/106dB | Tone 4 | Tone 5 |
| Tone 13 | 2400Hz @ 1Hz Intermittent | 103/112dB | Tone 15 | Tone 5 |
| Tone 14 | 800Hz 0.25 sec on, 1 sec off Intermittent | 103/108dB | Tone 4 | Tone 5 |
| Tone 15 | 800Hz Continuous | 103/108dB | Tone 2 | Tone 5 |
| Tone 16 | AS2220: 420Hz repeating 0.625 sec on, 0.625 sec off. | 91//103dB | Tone 18 | Tone 5 |
| Tone 17 | 544Hz (100mS)/440Hz (400mS) - NF S 32-001 | 100/104dB | Tone 2 | Tone 27 |
| Tone 18 | AS2220: 500-1200Hz Sweeping 3.75 sec on 0.25 sec off (15 cycles/min) | 100/106dB | Tone 16 | Tone 5 |
| Tone 19 | 1.4KHz-1.6KHz 1s, 1.6KHz-1.4KHz 0.5s -NFC48-265 | 98/106dB | Tone 2 | Tone 5 |
| Tone 20 | 660Hz Continuous | 96/104dB | Tone 2 | Tone 5 |
| Tone 21 | 554Hz/440Hz @ 1Hz Alternating | 100/104dB | Tone 2 | Tone 5 |
| Tone 22 | 544Hz @ 0.875 sec. Intermittent | 100/104dB | Tone 2 | Tone 5 |
| Tone 23 | 800Hz @ 2Hz Intermittent | 97/108dB | Tone 6 | Tone 5 |
| Tone 24 | 800/1000Hz @ 50Hz Sweeping | 101/108dB | Tone 29 | Tone 5 |
| Tone 25 | 2400/2900Hz @ 50Hz Sweeping | 101/108dB | Tone 29 | Tone 5 |
| Tone 26 | 1000Hz @ 1Hz Intermittent | 101/106dB | Tone 5 | Tone 15 |
| Tone 27 | 554Hz Continuous | 101/104dB | Tone 11 | Tone 5 |
| Tone 28 | 440Hz Continuous | 97/103dB | Tone 2 | Tone 5 |
| Tone 29 | 800/1000Hz @ 7Hz Sweeping | 101/105dB | Tone 7 | Tone 5 |
| Tone 30 | AS1670: 1500-500Hz 0.5 sec on 0.5 sec off x 3 with 1.5 sec gap | 100/106dB | Tone 32 | Tone 26 |
| Tone 31 | 660/1200Hz @ 1Hz Sweeping | 101/105dB | Tone 26 | Tone 5 |
| Tone 32 | AS1670: 500-1200Hz Sweeping 2 sec on 1 sec off | 100/105dB | Tone 30 | Tone 15 |

A112N - A121 - A131 - A141 - A105NAX - A121AX - MA112 - MA121 - MCA112-05 - D105 - D112 Tones

| Stage 1 | Description | Sound Output db@1m | Stage 2 | Stage 3 |
|---------|--|--------------------|---------|---------|
| Tone 1 | 340 Hz Continuous | 107/113dB | Tone 2 | Tone 5 |
| Tone 2 | 800/1000Hz @ 0.25 sec Alternating | 112/121dB | Tone 17 | Tone 5 |
| Tone 3 | 500/1200Hz @ 0.3Hz 0.5 sec Slow Whoop | 113/121dB | Tone 2 | Tone 5 |
| Tone 4 | 800/1000Hz @ 1Hz Sweeping | 113/121dB | Tone 6 | Tone 5 |
| Tone 5 | 2400Hz Continuous | 119/125dB | Tone 3 | Tone 20 |
| Tone 6 | 2400/2900Hz @ 7Hz Sweeping | 116/123dB | Tone 7 | Tone 5 |
| Tone 7 | 2400/2900Hz @ 1Hz Sweeping | 116/125dB | Tone 10 | Tone 5 |
| Tone 8 | 500/1200/500Hz @ 0.3Hz Sweeping | 113/121dB | Tone 2 | Tone 5 |
| Tone 9 | 1200/500Hz @ 1Hz - DIN / PFEER P.T.A.P. | 113/121dB | Tone 15 | Tone 2 |
| Tone 10 | 2400/2900Hz @ 2Hz Alternating | 119/126dB | Tone 7 | Tone 5 |
| Tone 11 | 1000Hz @ 1Hz Intermittent | 112/121dB | Tone 2 | Tone 5 |
| Tone 12 | 800/1000Hz @ 0.875Hz Alternating | 112/121dB | Tone 4 | Tone 5 |
| Tone 13 | 2400Hz @ 1Hz Intermittent | 119/125dB | Tone 15 | Tone 5 |
| Tone 14 | 800Hz 0.25 sec on, 1 sec off Intermittent | 113/120dB | Tone 4 | Tone 5 |
| Tone 15 | 800Hz Continuous | 113/120dB | Tone 2 | Tone 5 |
| Tone 16 | AS1670: 500-1200Hz Sweeping 2 sec on 1 sec off | 113/121dB | Tone 18 | Tone 5 |
| Tone 17 | 544Hz (100mS)/440Hz (400mS) - NF S 32-001 | 109/118dB | Tone 2 | Tone 27 |
| Tone 18 | AS1670: 1500-500Hz 0.5 sec on 0.5 sec off x 3 with 1.5 sec gap | 113/121dB | Tone 16 | Tone 5 |
| Tone 19 | 1.4KHz-1.6KHz 1s, 1.6KHz-1.4KHz 0.5s -NFC48-265 | 114/126dB | Tone 2 | Tone 5 |
| Tone 20 | 660Hz Continuous | 109/118dB | Tone 2 | Tone 5 |
| Tone 21 | 554Hz/440Hz @ 1Hz Alternating | 109/118dB | Tone 2 | Tone 5 |
| Tone 22 | 544Hz @ 0.875 sec. Intermittent | 109/118dB | Tone 2 | Tone 5 |
| Tone 23 | 800Hz @ 2Hz Intermittent | 113/120dB | Tone 6 | Tone 5 |
| Tone 24 | 800/1000Hz @ 50Hz Sweeping | 112/120dB | Tone 29 | Tone 5 |
| Tone 25 | 2400/2900Hz @ 50Hz Sweeping | 116/124dB | Tone 29 | Tone 5 |
| Tone 26 | Bell | 108/118dB | Tone 2 | Tone 15 |
| Tone 27 | 554Hz Continuous | 109/117dB | Tone 26 | Tone 5 |
| Tone 28 | 440Hz Continuous | 106/117dB | Tone 2 | Tone 5 |
| Tone 29 | 800/1000Hz @ 7Hz Sweeping | 112/121dB | Tone 7 | Tone 5 |
| Tone 30 | 300Hz Continuous | 107/114dB | Tone 2 | Tone 5 |
| Tone 31 | 660/1200Hz @ 1Hz Sweeping | 112/121dB | Tone 26 | Tone 5 |
| Tone 32 | Two tone chime. | 108/118dB | Tone 26 | Tone 15 |
| Tone 33 | 745Hz @ 1Hz Intermittent | 109/116dB | Tone 2 | Tone 5 |
| Tone 34 | 1000 & 2000Hz @ 0.5 sec Alternating - Singapore | 109/121dB | Tone 38 | Tone 45 |
| Tone 35 | AS2220: 420Hz @ 0.625 sec Australian Alert | 106/117dB | Tone 36 | Tone 5 |
| Tone 36 | AS2220: 500-1200Hz 3.75 sec /0.25 sec. Australian Evac. | 113/121dB | Tone 35 | Tone 5 |
| Tone 37 | 1000Hz Continuous - PFEER Toxic Gas | 113/121dB | Tone 9 | Tone 45 |
| Tone 38 | 2000Hz Continuous | 112/120dB | Tone 34 | Tone 45 |
| Tone 39 | 800Hz 0.25 sec on, 1 sec off Intermittent | 116/120dB | Tone 23 | Tone 17 |
| Tone 40 | 544Hz (100mS)/440Hz (400mS) - NF S 32-001 | 113/121dB | Tone 31 | Tone 27 |
| Tone 41 | Motor Siren - slow rise to 1200 Hz | 112/122dB | Tone 2 | Tone 5 |
| Tone 42 | Motor Siren - slow rise to 800 Hz | 114/121dB | Tone 2 | Tone 5 |
| Tone 43 | 1200 Hz Continuous | 113/122dB | Tone 2 | Tone 5 |
| Tone 44 | Motor Siren - slow rise to 2400 Hz | 118/124dB | Tone 2 | Tone 5 |
| Tone 45 | 1KHz 1s on, 1s off Intermittent - PFEER Gen. Alarm | 112/121dB | Tone 38 | Tone 34 |

Y03



- Electronic sounder
- 32 tones
- 2 stage alarm
- Volume control (-18dB adjustment)
- IP65

| Order Code | Voltage | Current | Weight (kg) |
|------------|-------------|---------|-------------|
| YOD3021 | 12-35VDC | 20-67mA | 0.32 |
| YOD3041 | 48VDC | 35mA | |
| YOD3071 | 115VAC ±10% | 25mA | 0.39 |
| YOD3081 | 230VAC ±10% | 20mA | |

Specifications:

Sound output*: Max 100dB @1m
 Sound frequency: 32 Tones see tone list on page 11-42
 Protection: IP65
 Temp rating (°C): -25 to +55
 Rating: Continuous
 Cable entry: 2 x 20mm
 Construction: Flame retardant ABS

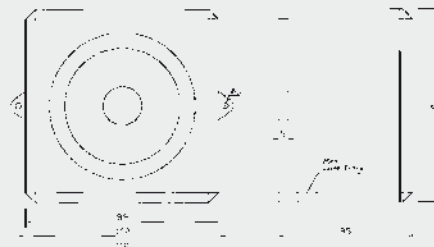

Dimensions in mm

Y04 – YL4-V4

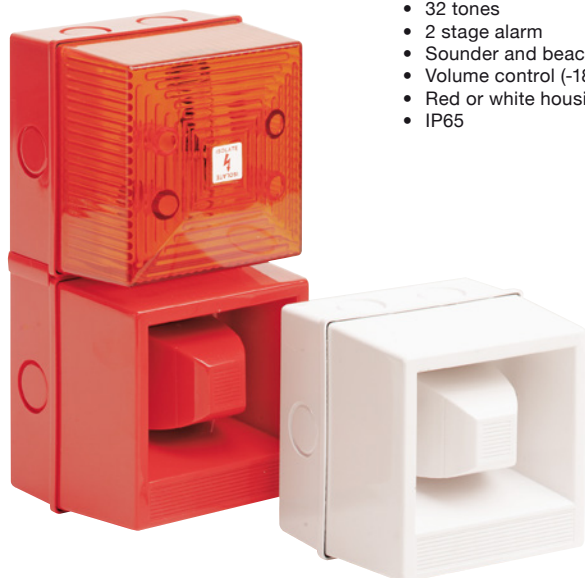

- Electronic sounder, beacon or sounder/beacon combination
- 32 tones
- 2 stage alarm
- Sounder and beacon controlled independently
- Volume control (-18dB adjustment)
- Red or white housing
- IP65

Specifications:

Sound output*: Max 106dB @1m
 Sound frequency: 32 Tones see tone list on page 11-42
 Flash energy: 5J
 Light output: 72cd(e) (with clear lens)
 Flash rate: 60fpm
 Protection: IP65
 Temp rating (°C): -25 to +55
 Rating: Continuous
 Cable entry: 2 x 20mm
 Construction: Flame retardant ABS

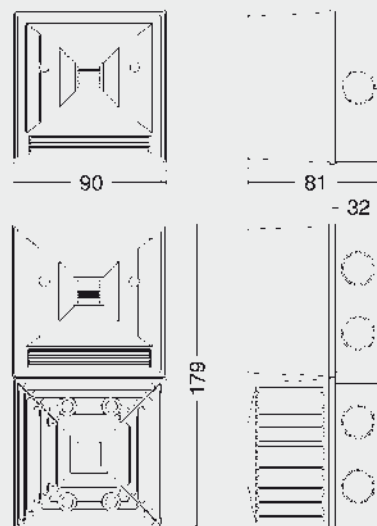

Dimensions in mm

| Order Code | Voltage | Current Sounder | Current Beacon | Weight (kg) |
|----------------------------------|-------------|-----------------|----------------|-------------|
| Y04 (YA40) sounder | | | | |
| YOD1800# | 24VDC | 37mA | - | 0.25 |
| YOD1801# | 115VAC ±10% | 27mA | - | 0.35 |
| YOD1802# | 230VAC ±10% | 21mA | - | |
| YL4 (YL40) sounder-beacon | | | | |
| YOD1810#* | 24VDC | 35mA | 306mA | 0.51 |
| YOD1811#* | 115VAC ±10% | 25mA | 100mA | 0.57 |
| YOD1812#* | 230VAC ±10% | 13mA | 98mA | |

#Specify housing colour R = Red, W = White

*Specify lens colour A = Amber, B = Blue, C = Clear, G = Green, R = Red

V4 (FL40) beacon red housing

| Order Code | Voltage | Current Sounder | Current Beacon | Weight (kg) |
|------------|--------------|-----------------|----------------|-------------|
| YOD2020* | 24VDC | - | 306mA | 0.26 |
| YOD2030* | 50VDC | - | 157mA | |
| YOD2040* | 115VAC ±10% | - | 100mA | 0.25 |
| YOD2050* | 230VAC ± 10% | - | 98mA | |

*Specify lens colour A = Amber, B = Blue, C = Clear, G = Green, R = Red



Y05 – YL5

- Electronic sounder or sounder/beacon combination
- 32 tones
- 2 stage alarm
- Sounder and beacon controlled independently
- Volume control (-18dB adjustment)
- IP65

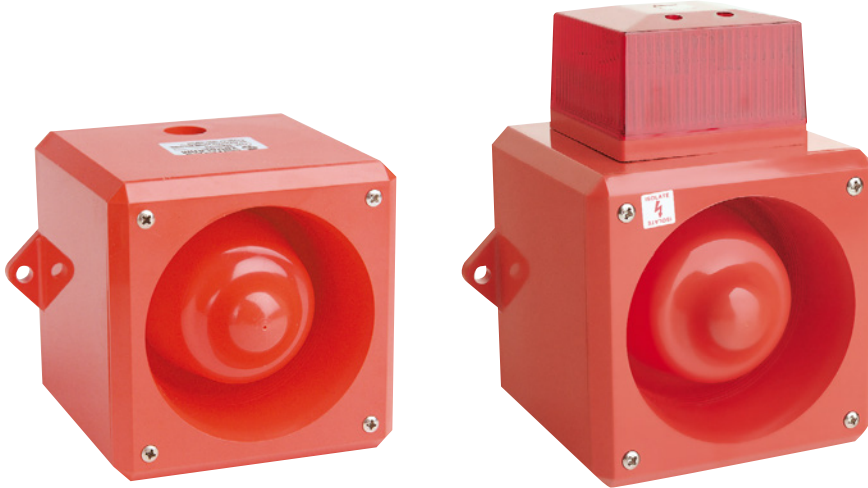

Specifications:

| | |
|-------------------|--------------------------------------|
| Sound output*: | Max 110dB @1m |
| Sound frequency: | 32 Tones see tone list on page 11-42 |
| Flash energy: | 5J |
| Light output: | 14cd(e) |
| Flash rate: | 60fpm |
| Protection: | IP65 |
| Temp rating (°C): | -25 to +55 |
| Rating: | Continuous |
| Cable entry: | 2 x 20mm |
| Construction: | Flame retardant ABS |

| Order Code | Voltage | Current Sounder | Current Beacon | Weight (kg) |
|----------------------------------|-------------|-----------------|----------------|-------------|
| Y05 (YA50) sounder | | | | |
| Y0D5021 | 12-35VDC | 20-67mA | - | 0.71 |
| Y0D5041 | 48VDC | 35mA | - | |
| Y0D5071 | 115VAC ±10% | 25mA | - | 0.81 |
| Y0D5081 | 230VAC ±10% | 20mA | - | |
| YL5 (YL50) sounder-beacon | | | | |
| Y0D5121* | 24VDC | 67mA | 250mA | 1.010 |
| Y0D5131* | 48VDC | 35mA | 135mA | |
| Y0D5141* | 115VAC ±10% | 25mA | 130mA | 1.090 |
| Y0D5151* | 230VAC ±10% | 20mA | 70mA | |

*Specify lens colour A = Amber, B = Blue, C = Clear, G = Green, R = Red

Y05

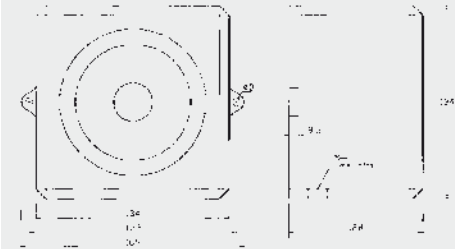

Dimensions in mm

YL5

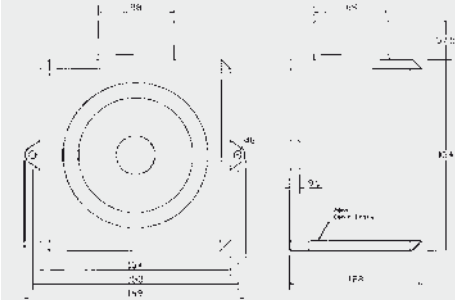

Dimensions in mm



Y08 – YL8

- Electronic sounder or sounder/beacon combination
- 32 tones
- 2 stage alarm
- Sounder and beacon controlled independently
- IP65

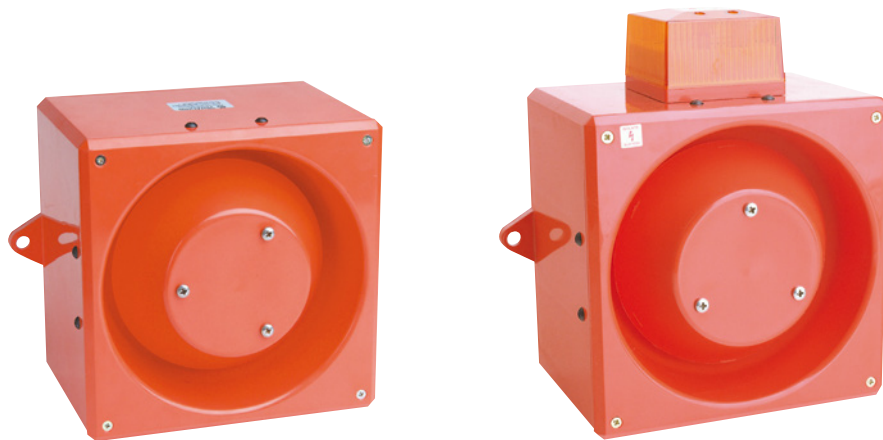

Specifications:

| | |
|-------------------|------------------------------|
| Sound output*: | Max 116dB @1m |
| Sound frequency: | 32 Tones see tone list below |
| Flash energy: | 5J |
| Light output: | 14cd(e) |
| Flash rate: | 60fpm |
| Protection: | IP65 |
| Temp rating (°C): | -25 to +55 |
| Rating: | Continuous |
| Cable entry: | 2 x 20mm |
| Construction: | Flame retardant ABS |

Y08

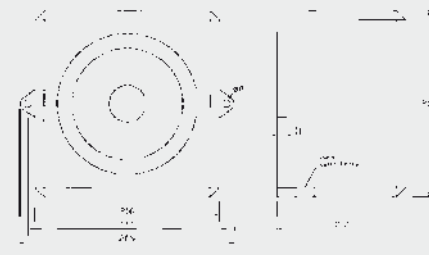

Dimensions in mm

YL8

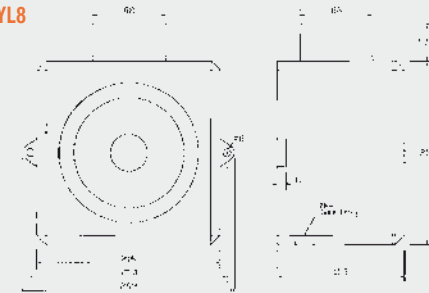

Dimensions in mm

| Order Code | Voltage | Current Sounder | Current Beacon | Weight (kg) |
|----------------------------------|-------------|-----------------|----------------|-------------|
| Y08 (YA80) sounder | | | | |
| Y0D8021 | 12-35VDC | 300-330mA | - | 2.90 |
| Y0D8041 | 48VDC | 300mA | - | |
| Y0D8071 | 115VAC ±10% | 102mA | - | 3.280 |
| Y0D8081 | 230VAC ±10% | 45mA | - | |
| YL8 (YL80) sounder-beacon | | | | |
| Y0D8121* | 24VDC | 300mA | 250mA | 3.210 |
| Y0D8131* | 48VDC | 300mA | 135mA | |
| Y0D8141* | 115VAC ±10% | 282mA | 130mA | 3.580 |
| Y0D8151* | 230VAC ±10% | 225mA | 70mA | |

*Specify lens colour A = Amber, B = Blue, C = Clear, G = Green, R = Red

Y03-Y04-Y05-Y08 Tones

| Stage 1 | Description | Stage 2 | Stage 1 | Description | Stage 2 |
|---------|---------------------------------|---------|---------|--|---------|
| Tone 1 | 800-1000Hz @ 0.25s alternating | Tone 3 | Tone 17 | 1000Hz @ 0.5s intermittent | Tone 1 |
| Tone 2 | 2500-3100Hz @ 0.25s alternating | Tone 4 | Tone 18 | 2500Hz @ 0.25s intermittent | Tone 4 |
| Tone 3 | 800-1000Hz @ 0.25s alternating | Tone 7 | Tone 19 | 2500Hz @ 0.5s intermittent | Tone 2 |
| Tone 4 | 2500-3100Hz @ 0.25s alternating | Tone 8 | Tone 20 | 700Hz 0.6s on, 1.2s off | Tone 10 |
| Tone 5 | 440Hz 0.4s, 0554Hz 0.1s | Tone 14 | Tone 21 | 1000Hz @ 1s intermittent | Tone 32 |
| Tone 6 | 430-470Hz @ 1s alternating | Tone 14 | Tone 22 | 700Hz @ 4s intermittent | Tone 10 |
| Tone 7 | 800-1000Hz @ 0.13s alternating | Tone 12 | Tone 23 | 700Hz @ 0.25s intermittent | Tone 10 |
| Tone 8 | 2500-3200Hz @ 0.07s alternating | Tone 13 | Tone 24 | 720Hz 0.7s on, 0.3s off | Tone 10 |
| Tone 9 | 440-554Hz @ 2s alternating | Tone 10 | Tone 25 | 1400Hz @0.25s intermittent fast rising | Tone 26 |
| Tone 10 | 700Hz continuous | Tone 1 | Tone 26 | 250-1200Hz 0.085s fast siren | Tone 11 |
| Tone 11 | 1000Hz continuous | Tone 31 | Tone 27 | 1000Hz rising | Tone 17 |
| Tone 12 | 1000Hz continuous | Tone 7 | Tone 28 | 800-1000Hz ISO8201 evac. | Tone 11 |
| Tone 13 | 2300Hz continuous | Tone 2 | Tone 29 | 500-1000Hz @ 0.15s fast whoop | Tone 32 |
| Tone 14 | 440Hz continuous | Tone 9 | Tone 30 | 500-1200Hz 4.5s slow whoop | Tone 12 |
| Tone 15 | 1000Hz @ 0.25s intermittent | Tone 31 | Tone 31 | 1200-500Hz 1s reverse sweep | Tone 11 |
| Tone 16 | 420Hz @ 1.25s intermittent | Tone 30 | Tone 32 | 500-1200Hz 3s siren | Tone 26 |



A105NAX-A121AX Appello X

- Electronic voice and tone sounder
- Records, stores and plays back user defined voice messages
- 4 x 30s messages
- High voice and music reproduction quality
- Message creation via built in microphone or line-in audio input
- 45 tones
- 4 tone stage
- Independent volume control for tone and message
- For multiple installations it is necessary to record messages only once on a master unit
- Optional LED beacon
- IP66
- Also available in D aluminium housing see p11-35-36

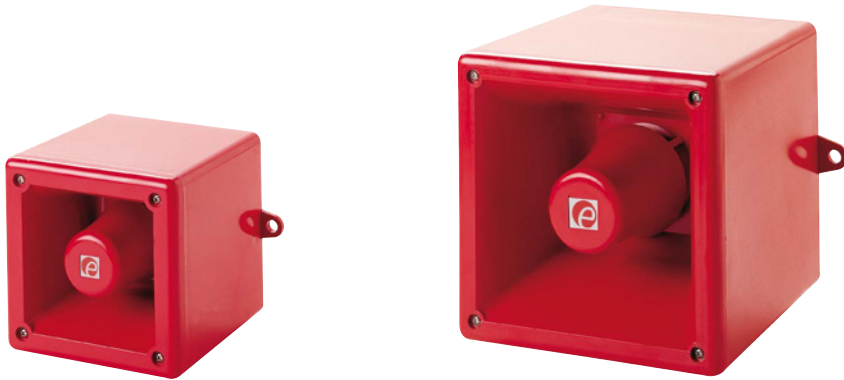

| Order Code | Voltage | Current | Weight (kg) |
|---|-----------|----------------|-------------|
| A105NAX Appello | | | |
| ESS2010NAPX | 10-30VDC | 256mA @ 24VDC | 0.8 |
| ESS2030NAPX | 90-260VAC | 124mA @ 230VAC | 1.0 |
| A121AX Appello | | | |
| ESS5012APX | 14-30VDC | 1.51A @ 24VDC | 2.1 |
| ESS5031APX | 90-260VAC | 517mA | 2.7 |
| AL105NAX Appello with LED beacon** | | | |
| ESS2110NAPX* | 10-30VDC | 413mA @ 24VDC | 1.0 |
| ESS2130NAPX* | 90-260VAC | 159mA @ 230VAC | 1.2 |
| AL121AX Appello with LED beacon** | | | |
| ESS5112APX* | 14-30VDC | 1.67A @ 24VDC | 2.3 |
| ESS5131APX* | 90-260VAC | 567mA | 2.9 |

*Specify colour A = Amber, B = Blue, C = Clear, G = Green, R = Red

**Note: beacon specifications on page 11-10 (L101H)

Specifications:

Sound output:

A105NAX

Tone – Max 110dB @ 1m

Voice – Max 101dB @ 1m

A121AX

Tone – Max 126dB @ 1m

Voice – Max 111dB @ 1m

Sound frequency:

45 tones see tone list on page 11-39 – Note 4th stage tone is tone 29 regardless of 1st stage tone selected

No. messages:

4 (total of 120 seconds)

Protection:

IP66

Temp rating (°C):

-25 to +55

Rating:

Continuous

Cable entry:

2 x M20 knockouts

Rating:

Continuous

Construction:

Flame Retardant ABS

A105NAX

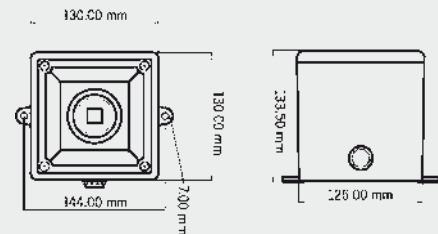

A105NAX

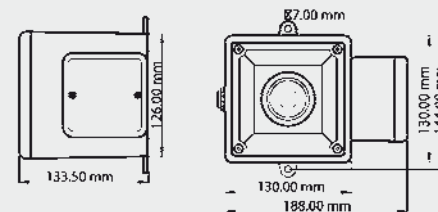

A121

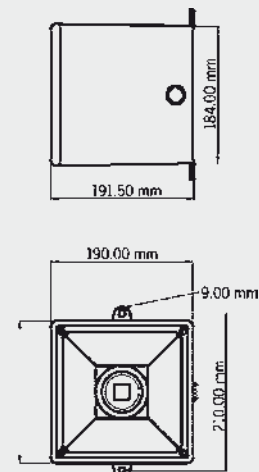

Micro series

- Small motor driven siren
- Surface or panel mount version (low voltage only)
- For indoor applications
- Double insulated
- IP42



Specifications:

| | |
|--------------------|--|
| Duty cycle: | Continuous |
| Voltage tolerance: | ±10% |
| Protection: | IP42 |
| Temp rating (°C): | -30 to +40 |
| Cable entry: | Through base |
| Construction: | Polycarbonate |
| Weight: | 0.15kg (low voltage) 0.60kg (mains voltage) |

| Order Code* | Voltage | Current | Sound Frequency | Sound Output dB@1m |
|--|---------|---------|-----------------|--------------------|
| Micro W10 N – surface mounting | | | | |
| SIR4001210 | 12VDC | 1.1A | 1350Hz | 94dB |
| SIR4001220 | 12VAC | | | |
| SIR4002410 | 24VDC | 650mA | 1500Hz | 96dB |
| SIR4002420 | 24VAC | | | |
| Micro W10 R – panel mounting | | | | |
| SIR4001211 | 12VDC | 1.1A | 1350Hz | 94dB |
| SIR4002411 | 24VDC | 650mA | 1500Hz | 96dB |
| Micro W10 AT – surface mounting | | | | |
| SIR4011020 | 110VAC | 130mA | 1000Hz | 93dB |
| SIR4024020 | 240VAC | 95mA | 1450Hz | |

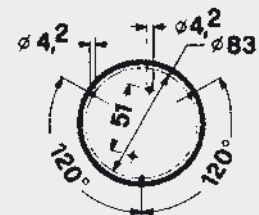
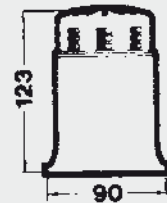
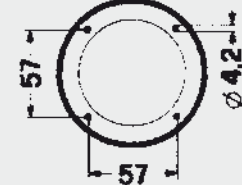
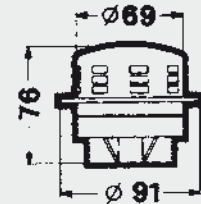
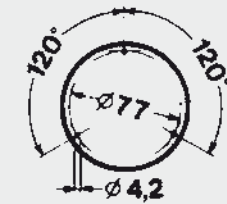
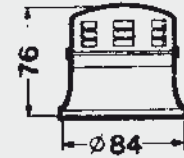

Dimensions in mm

Celere series

- Motor driven sirens up to 114dB
- 3 sizes
- Double insulated
- IP43



| Order Code* | Voltage | Current | Sound Frequency | Sound Output dB@1m | Weight (kg) |
|---|-----------|---------|-----------------|--------------------|-------------|
| Mini Celere (BA) – continuously rated | | | | | |
| SIR4101210 | 12VDC | 1.3A | 1200Hz | 97dB | 0.3 |
| SIR4102410 | 24VDC | 0.55A | 1300Hz | 100dB | |
| Mini Celere | | | | | |
| SIR4101230 | 12VAC/DC | 2.7A | 1020Hz | 88dB | 0.4 |
| SIR4102430 | 24VAC/DC | 1.47A | 1350Hz | 94dB | |
| SIR4104830 | 48VAC/DC | 0.85A | 1520Hz | 100dB | |
| SIR4111030 | 110VAC/DC | 0.37A | 1450Hz | 96dB | |
| SIR4124030 | 240VAC/DC | 0.22A | 1730Hz | 101dB | |
| Celere (BA) – continuously rated | | | | | |
| SIR4301210 | 12VDC | 2.5A | 950Hz | 103dB | 0.6 |
| SIR4302410 | 24VDC | 1.1A | 950Hz | 103dB | |
| Celere | | | | | |
| SIR4301230 | 12VAC/DC | 9.2A | 1020Hz | 100dB | 1.2 |
| SIR4302430 | 24VAC/DC | 7.8A | 1380Hz | 109dB | |
| SIR4304830 | 48VAC/DC | 3.6A | 1410Hz | 108.5dB | |
| SIR4311030 | 110VAC/DC | 0.92A | 1060Hz | 104.5dB | |
| SIR4324030 | 240VAC/DC | 0.65A | 1430Hz | 110dB | |
| Super Celere (BA) – continuously rated | | | | | |
| SIR4501210 | 12VDC | 9.5A | 820Hz | 114dB | 1.5 |
| SIR4502410 | 24VDC | 5.0A | 820Hz | 114dB | |
| Super Celere | | | | | |
| SIR4501230 | 12VAC/DC | 13.5A | 800Hz | 111dB | 1.6 |
| SIR4502430 | 24VAC/DC | 7.0A | 900Hz | 112dB | |
| SIR4504830 | 48VAC/DC | 6.0A | 1060Hz | 113.5dB | |
| SIR4511030 | 110VAC/DC | 1.7A | 970Hz | 111.5dB | |
| SIR4524030 | 240VAC/DC | 1.2A | 1120Hz | 113.5dB | |

Specifications:

| | |
|--------------------|--|
| Duty cycle: | 1 min on. 10 min off (BA versions are continuously rated) |
| Voltage tolerance: | ±10% |
| Protection: | IP43 |
| Temp rating (°C): | -30 to +40 |
| Cable entry: | M12 |
| Construction: | Polycarbonate |

Mini Celere

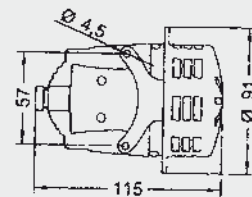
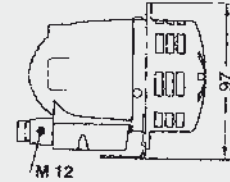

Celere

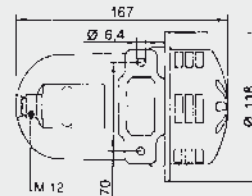
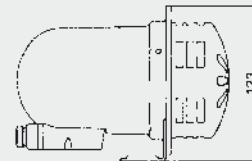

Super Celere

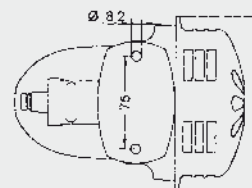
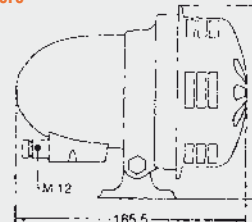

Dimensions in mm

Celerest series

- Motor driven sirens up to 116dB
- 3 sizes
- Vertical mounting with rain hood
- Double insulated
- IP44



Specifications:

| | |
|--------------------|--|
| Duty cycle: | 1 min on. 10 min off (BA versions are continuously rated) |
| Voltage tolerance: | ±10% |
| Protection: | IP44 |
| Temp rating (°C): | -30 to +40 |
| Cable entry: | M16 |
| Construction: | Polycarbonate |

Mini Celerest

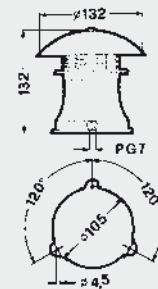

| Order Code* | Voltage | Current | Sound Frequency | Sound Output dB@1m | Weight (kg) |
|---|-----------|---------|-----------------|--------------------|-------------|
| Mini Celerest (BA) – continuously rated | | | | | |
| SIR4701210 | 12VDC | 1.3A | 1200Hz | 92dB | 0.35 |
| SIR4702410 | 24VDC | 0.55A | 1300Hz | 95dB | |
| Mini Celerest | | | | | |
| SIR4701230 | 12VAC/DC | 2.7A | 1600Hz | 96dB | 0.45 |
| SIR4702430 | 24VAC/DC | 1.47A | 1600Hz | 97dB | |
| SIR4704830 | 48VAC/DC | 0.85A | 1650Hz | 97dB | |
| SIR4711030 | 110VAC/DC | 0.37A | 1500Hz | 95dB | |
| SIR4724030 | 240VAC/DC | 0.22A | 1700Hz | 97dB | |
| Celerest (BA) – continuously rated | | | | | |
| SIR4801210 | 12VDC | 2.5A | 950Hz | 100dB | 0.9 |
| SIR4802410 | 24VDC | 1.1A | 950Hz | 100dB | |
| Celerest | | | | | |
| SIR4801230 | 12VAC/DC | 9.2A | 1150Hz | 104dB | 1.5 |
| SIR4802430 | 24VAC/DC | 7.8A | 1250Hz | 106dB | |
| SIR4804830 | 48VAC/DC | 3.6A | 1350Hz | 106dB | |
| SIR4811030 | 110VAC/DC | 0.92A | 1300Hz | 106dB | |
| SIR4824030 | 240VAC/DC | 0.65A | 1400Hz | 107dB | |
| Super Celerest (BA) – continuously rated | | | | | |
| SIR4901210 | 12VDC | 9.5A | 820Hz | 113dB | 1.8 |
| SIR4902410 | 24VDC | 5.0A | 820Hz | 113dB | |
| Super Celerest | | | | | |
| SIR4901230 | 12VAC/DC | 13.5A | 900Hz | 113dB | 1.9 |
| SIR4902430 | 24VAC/DC | 7.0A | 900Hz | 114dB | |
| SIR4904830 | 48VAC/DC | 6.0A | 1000Hz | 115dB | |
| SIR4911030 | 110VAC/DC | 1.7A | 1000Hz | 115dB | |
| SIR4924030 | 240VAC/DC | 1.2A | 1050Hz | 116dB | |

Celerest

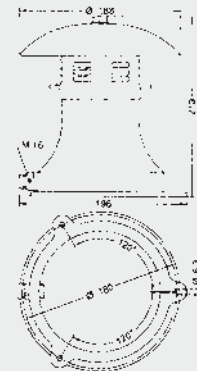

Super Celerest



Dimensions in mm

Super M



- Sound output 127dB @ 1m
- Continuous rating
- Weatherproof (when mounted with rotor end down)

| Order Code | Voltage | Current |
|------------|-----------|---------|
| SECXSM110 | 110VAC/DC | 3.4A |
| SECXSM240 | 240VAC/DC | 2.0A |

Specifications:

Sound output: 127dB @ 1m (240V)
Sound frequency: 1600 Hz
Protection: IP55 (when mounted with rotor end down)
Rating: Continuous
Voltage tolerance: ±10%
Temperature range (°C): -30 to +45
Cable Entry: Through base
Construction: ABS
Weight: 1.8Kg

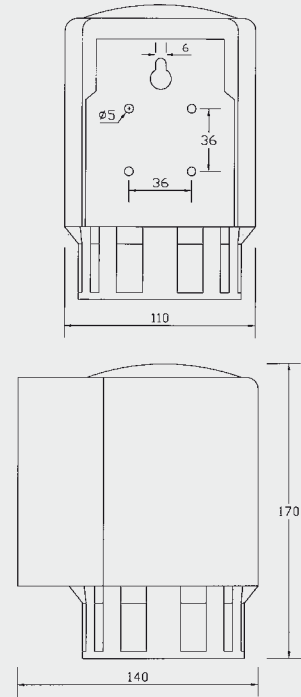

Dimensions in mm

S04



- Sound output 125dB @ 1m
- Low penetrating tone
- Continuous rating
- Weatherproof
- Robust aluminium construction

| Order Code | Voltage | Current | Sound Output |
|------------|-----------|---------|--------------|
| SEC1310 | 110VAC/DC | 3.7A | 125dB @1m |
| SEC1340 | 240VAC/DC | 2.1A | 125dB @1m |

Specifications:

Sound frequency: 900Hz
Protection: IP55
Rating: 20 min
Voltage tolerance: ±10%
Temperature rating (°C): -30 to +45
Cable entry: 20 mm
Construction: Aluminium alloy
Weight: 4.5Kg

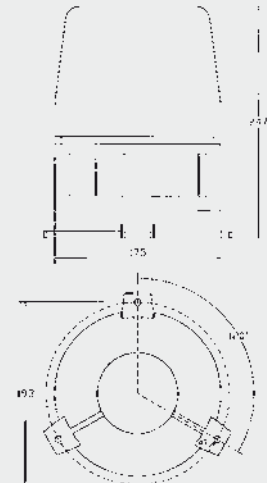

Dimensions in mm

Banshee Mono S



- Sound output up to 123dB @ 1m
- Robust die cast aluminium housing
- Continuous rating
- IP65

| Order Code | Voltage | Current |
|------------|-----------|---------|
| KAMMS012 | 12VDC | 15A |
| KAMMS024 | 24VDC | 10.6A |
| KAMMS110 | 110VAC/DC | 1.5A |
| KAMMS230 | 230VAC/DC | 1.0A |

Specifications:

Sound output: 123dB @ 1m (240V)
Sound frequency: 905-1200 Hz (depending on voltage)
Protection: IP65
Rating: Continuous (with thermal protector)
Voltage tolerance: ±10%
Temperature range (°C): -30 to +45
Cable Entry: 2 x M20
Construction: Powder coated aluminium
Weight: 1.66Kg

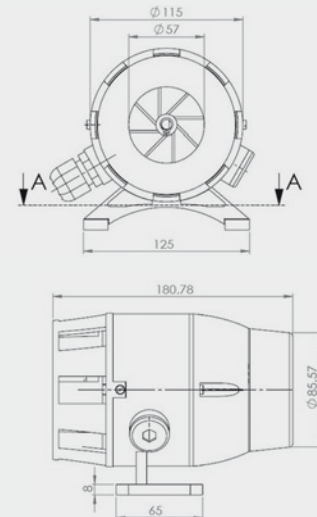

Dimensions in mm

Banshee Duplo S



- Sound output up to 127dB @ 1m
- Robust die cast aluminium housing
- Continuous rating
- IP65

| Order Code | Voltage | Current |
|------------|-----------|---------|
| KAMDS110 | 110VAC/DC | 1.6A |
| KAMDS230 | 230VAC/DC | 1.1A |

Specifications:

Sound output: 127dB @ 1m (240V)
Sound frequency: 1600 Hz
Protection: IP65
Rating: Continuous (with thermal protector)
Voltage tolerance: ±10%
Temperature range (°C): -30 to +45
Cable Entry: 3 x M20
Construction: Powder coated aluminium
Weight: 2.9Kg

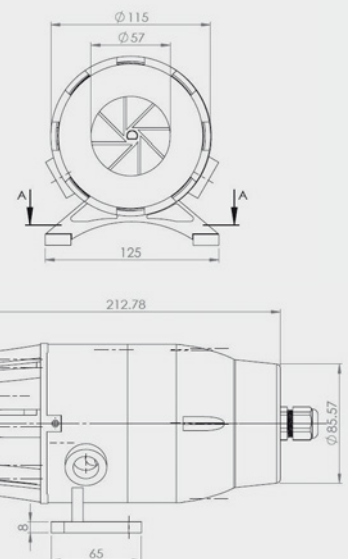

Dimensions in mm

MicroSAI



- High output buzzer
- Continuous or pulsing versions
- Surface or panel mounting versions
- Double insulated
- IP65

| Order Code* | Voltage | Current |
|---|---------|---------|
| MicroSAI continuous sound surface mounting | | |
| SIR8050125 | 12VAC | 830mA |
| SIR8050245 | 24VAC | 415mA |
| SIR8050485 | 48VAC | 210mA |
| SIR8051105 | 110VAC | 90mA |
| SIR8052405 | 240VAC | 42mA |
| MicroSAI pulsing sound surface mounting | | |
| SIR8050126 | 12VAC | 830mA |
| SIR8050246 | 24VAC | 415mA |
| SIR8050486 | 48VAC | 210mA |
| SIR8051106 | 110VAC | 90mA |
| SIR8052406 | 240VAC | 42mA |

* Add P to code for panel mounting version

Sound output: 95dB @ 1m
 Sound frequency: 300-350 Hz
 Duty cycle: Continuous
 Voltage tolerance: ±10%
 Protection: IP65
 Temp rating (°C): -30 to +40
 Cable entry: M16
 Construction: ABS and polycarbonate
 Weight: 0.31-0.42Kg

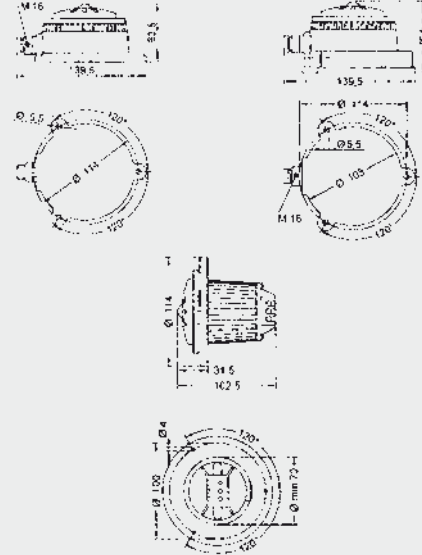

Dimensions in mm

SAI



- High output buzzer
- Continuous or pulsing versions
- Double insulated
- IP54

| Order Code | Voltage | Current |
|-----------------------------|---------|---------|
| SAI continuous sound | | |
| SIR8070121 | 12VDC | 1.7A |
| SIR8070241 | 24VDC | 900mA |
| SIR8070481 | 48VDC | 450mA |
| SIR8070125 | 12VAC | 1.9A |
| SIR8070245 | 24VAC | 1.1A |
| SIR8070485 | 48VAC | 540mA |
| SIR8071105 | 110VAC | 190mA |
| SIR8072405 | 240VAC | 130mA |
| SAI pulsing sound | | |
| SIR8070126 | 12VAC | 1.9A |
| SIR8070246 | 24VAC | 1.1A |
| SIR8070486 | 48VAC | 540mA |
| SIR8071106 | 110VAC | 190mA |
| SIR8072406 | 240VAC | 130mA |

Specifications:
 Sound output: 110dB @ 1m DC voltage, 105dB @1m AC voltage
 Sound frequency: 600-20000 Hz (800-15000Hz on AC supply)
 Duty cycle: Continuous
 Voltage tolerance: ±10%
 Protection: IP54
 Temp rating (°C): -30 to +40
 Cable entry: M16
 Construction: ABS and polycarbonate
 Weight: 0.7Kg

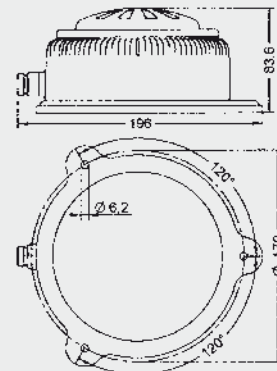

Dimensions in mm

HPT



- Electromechanical horn
- Impact resistant synthetic housing
- Wide choice of voltages in AC and DC
- IP55

| Order Code | Voltage | Current |
|-------------|---------|---------|
| JA712100004 | 12VDC | 1.0A |
| JA712100005 | 24VDC | 600mA |
| JA712100010 | 110VDC | 200mA |
| JA712100013 | 220VDC | 100mA |
| JA712100105 | 24VAC | 1.2A |
| JA712100110 | 110VAC | 200mA |
| JA712100113 | 230VAC | 100mA |

Specifications:

Sound output: 108dB @ 1m
Duty cycle: Continuous
Protection: IP55
Temp rating (°C): -20 to +50
Cable entry: Cable gland 7-10mm
Mounting: with sound outlet down
Construction: ABS
Weight: 0.8Kg

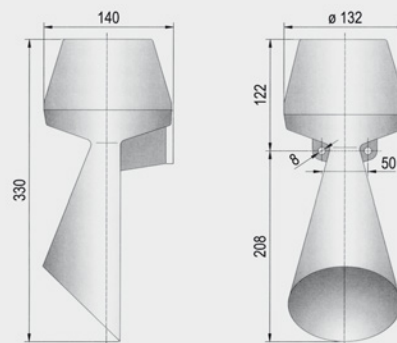

Dimensions in mm

HMA121



- Electronic horn/bell with 5 commonly used electro-mechanical sounds with 3 stage alarm
- Accurately reproduces electro-mechanical horn and bell sounds
- Automatically synchronises on multi-sounder systems.*
- High sound output (up to 121dB @ 1m)
- Volume control (124dB max. - 115dB min.)
- IP66

| Order Code | Voltage | Current | Weight (kg) |
|------------|---------|---------|-------------|
| ESS8210 | 24VDC | 1.0A | 2.5 |
| ESS8220 | 110VAC | 600mA | 3.0 |
| ESS8230 | 230VAC | 500mA | |

*synchronisation only occurs when sounders are connected to the same power supply

Tones

| Tone | Description | Stage 1 | Stage 2 | Stage 3 |
|------|----------------------------|---------|---------|---------|
| 1 | Industrial hooter (klaxon) | Tone 1 | Tone 3 | Tone 5 |
| 2 | Trumpet horn – medium note | Tone 2 | Tone 1 | Tone 5 |
| 3 | Trumpet horn – high note | Tone 3 | Tone 1 | Tone 5 |
| 4 | Buzzer | Tone 4 | Tone 2 | Tone 5 |
| 5 | Bell | Tone 5 | Tone 1 | Tone 2 |

Specifications:

Sound output: 121dB @1m at nominal voltage
Sound frequency: 5 Tones selectable by DIP switches (2nd and 3rd stage by terminals)
Protection: IP66
Temp rating (°C): -25 to +55
Rating: Continuous
Cable entry: 2 x M20
Construction: Flame retardant ABS, UV stabilized

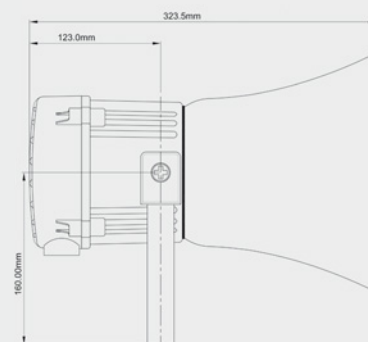
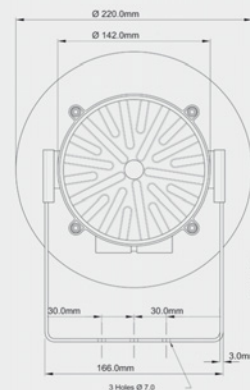

Sireco Air Horns

- Compressed air operated high output horns
- Suitable for hazardous areas
- All metal construction
- Continuously rated



| Order Code | Sound Frequency | Weight (kg) |
|-----------------|-----------------|-------------|
| KAMAH370 | 370Hz | 2.8 |
| KAMAH660 | 660Hz | 2.4 |

Specifications:

Sound output: 138dB @ 1m
 Recommended pressure: 7 Bar (350-1000kpa)
 Air Connection: 19mm
 Construction: Cast aluminium

KAMAH370

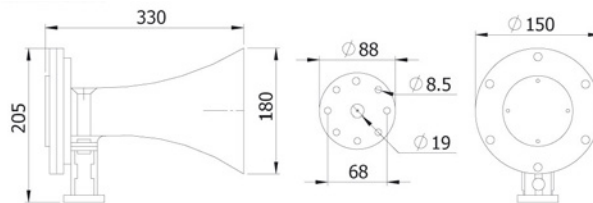

Dimensions in mm

KAMAH660

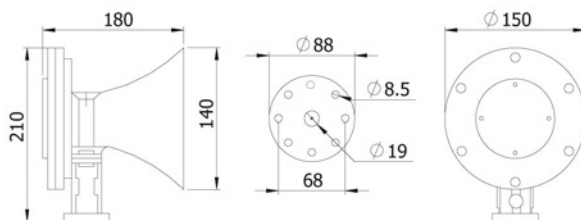

MB series



- Solenoid bell available with 4, 6 and 8 inch gongs (4 inch 12 and 24V bells are motor driven)
- Available in red or grey
- IP55 in 6 and 8 inch sizes when back box is used, 4 inch bells for indoor use only.

| Order Code | Voltage | Current | Sound Output dB@1m | Weight (kg) |
|--------------------|---------|---------|--------------------|-------------|
| 4 inch gong | | | | |
| MB101012D* | 12VDC | 40mA | 83dB | 0.4 |
| MB101024D* | 24VDC | 20mA | | |
| MB100240A* | 240VAC | 35mA | | |
| 6 inch gong | | | | |
| MB150012D* | 12VDC | 110mA | 85dB | 1.0 |
| MB150024D* | 24VDC | 60mA | | |
| MB150240A* | 240VAC | 40mA | | |
| 8 inch gong | | | | |
| MB200012D* | 12VDC | 110mA | 88dB | 1.76 |
| MB200024D* | 24VDC | 60mA | | |
| MB200240A* | 240VAC | 40mA | | |

MBBOX* Back mounting box 110x110x140mm

*Specify colour R = Red, G = Grey

Specifications:

Sound frequency: 2000-12,000Hz
 Protection: IP20 or IP55 in 6 and 8" sizes when installed with back box
 Temp rating (°C): -25 to +55
 Duty cycle: 60min max.
 Cable entry: Side and rear knockouts on back box
 Construction: Steel gong, die cast aluminium housing and back box

Dimensions in mm

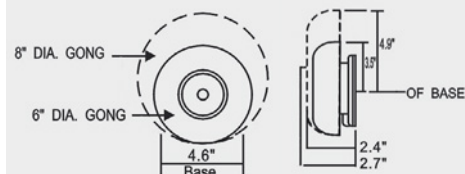
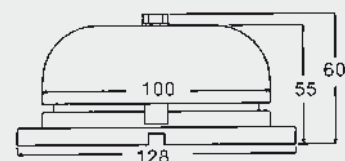

CEAD



- Industrial solenoid bell
- Wide choice of voltages
- Available in red or grey
- Double insulated
- IP66

| Order Code* | Voltage | Current |
|--------------------------------|---------|---------|
| CEAD – for AC voltage | | |
| SIR8040125* | 12VAC | 860mA |
| SIR8040245* | 24VAC | 430mA |
| SIR8040485* | 48VAC | 250mA |
| SIR8040605* | 60VAC | 170mA |
| SIR8041105* | 110VAC | 90mA |
| SIR8042405* | 240VAC | 50mA |
| CEADEL – for DC voltage | | |
| SIR8040121* | 12VDC | 600mA |
| SIR8040241* | 24VDC | 300mA |
| SIR8040481* | 48VDC | 160mA |
| SIR8040601* | 60VDC | 120mA |
| SIR8041101* | 110VDC | 60mA |
| SIR8042401* | 240VDC | 28mA |

*Specify colour R = Red, G = Grey

Specifications:

Sound output: 98dB @ 1m DC versions
 100dB @ 1m AC versions
 Sound frequency: 2000-12000 Hz
 Duty cycle: Continuous
 Voltage tolerance: ±10%
 Protection: IP66
 Temp rating (°C): -30 to +50
 Cable entry: M16
 Construction: ABS and steel

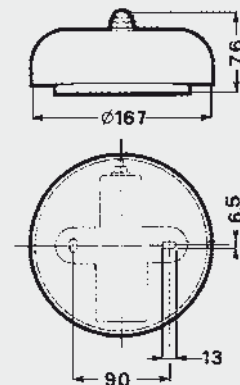

Dimensions in mm

LK100 Hand Operated Siren



- Hand wound siren with output up to 108dB
- Heavy duty aluminium or lightweight plastic versions
- Supplied with carry bag

| Order Code | Description | Weight (kg) |
|------------|------------------------------|-------------|
| LK100 | Hand wound siren - aluminium | 1.2 |
| LK100P | Hand wound siren - ABS | 0.6 |

Specifications:

Sound output: 108dB @ 1m
 Frequency: 550Hz nominal (depends on speed of rotation)
 Construction: Aluminium or ABS
 Weight: 1.2/0.6 Kg

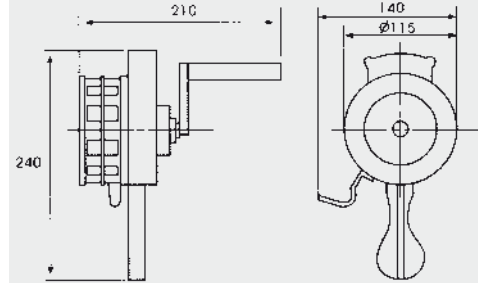

Dimensions in mm

LK120 Hand Operated Siren



- Hand wound siren with output up to 120dB
- Heavy duty aluminium construction
- Portable with stand

| Order Code | Description | Weight (kg) |
|------------|------------------|-------------|
| LK120 | Hand wound siren | 11 |

Specifications:

Sound output: 120dB @ 1m
 Frequency: 600Hz nominal (depends on speed of rotation)
 Construction: Aluminium siren with steel tube stand
 Weight: 1.2/0.6 Kg

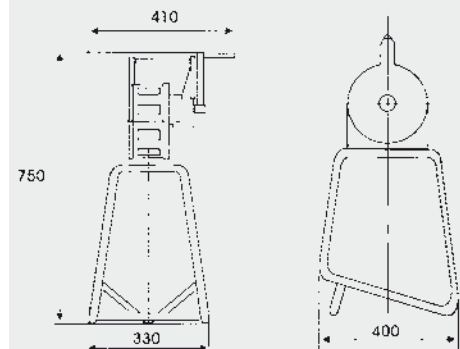

Dimensions in mm

EcoBlast PRO



- Rechargeable air horn
- High sound output up to 115dB
- Rechargeable from air compressor or bike pump etc
- Pressure "fuel" gauge fitted
- Supplied with carry strap
- Optional bracket for wall mounting

| Order Code | Description | Weight (kg) |
|------------|-----------------------|-------------|
| AIZ010 | EcoBlast Pro | 0.95 |
| AIZ900 | Wall mounting bracket | 0.7 |

Specifications:

Operating pressure: Min 5psi to Max 90psi
 Sound output: Max 115dB @ 1m
 Autonomy: Approx. 200 blasts per charge
 Construction: ABS
 Dimensions (L x H x W): 280 x 230 x 160mm

MB010

- 10J Xenon strobe
- Synchronised flash or flip-flop mode on multi-beacon systems**
- IP67
- Stainless steel lens guard as standard



| Order Code | Voltage | Current |
|------------|-------------|---------|
| ESS7202* | 10-14VDC | 1.45A |
| ESS7212* | 20-28VDC | 660mA |
| ESS7217* | 42-54VDC | 340mA |
| ESS7222* | 115VAC ±10% | 250mA |
| ESS7232* | 230VAC ±10% | 110mA |

*Specify colour A = Amber, B = Blue, C = Clear, G = Green, R = Red

Specifications:

| | |
|-------------------|---|
| Light intensity: | 183cd(e) |
| Flash energy: | 10J |
| Flash rate: | 60fpm |
| Protection: | IP67 |
| Duty: | Continuous |
| Temp rating (°C): | -25 to +55 |
| Cable entry: | 2 x M20 |
| Construction: | Flame retardant ABS housing, glass lens |
| Weight: | 1.48kg |

**synchronisation or flip-flop modes on multi-beacon systems on a single supply

MBL1

- Multifunction LED beacon
- 9 flash patterns
- 3 stage alarm, remotely selectable
- IP67
- Stainless steel lens guard as standard



Specifications:

| | |
|-------------------|---|
| Light intensity: | 11cd(e) |
| Flash rate: | Multifunction – see list |
| Protection: | IP67 |
| Duty: | Continuous |
| Temp rating (°C): | -25 to +55 |
| Cable entry: | 2 x M20 |
| Construction: | Flame retardant ABS housing, glass lens |
| Weight: | 1.48kg |

Flash Patterns

| Stage 1: [Selectable on board] | Stage 2: [Remotely selectable] | Stage 3: [Remotely selectable] |
|--------------------------------|--------------------------------|--------------------------------|
| 1 Static | 1 Alternate Side Flash 1:1 2Hz | 1 Double Strike Flash 2Hz |
| 2 Rotating: Fast 1 | 2 Rotating: Fast 2 | 2 Static |
| 3 Rotating: Fast 2 | 3 Double Strike Flash 2Hz | 3 Static |
| 4 Rotating: Slow 1 | 4 Alternate Side Flash 1:1 2Hz | 4 Static |
| 5 Rotating: Slow 2 | 5 Double Strike Flash 1Hz | 5 Static |
| 6 Double Strike Flash 1Hz | 6 Alternate Side Flash 1:1 2Hz | 6 Static |
| 7 Single Strike Flash 2Hz | 7 Rotating: Fast 2 | 7 Static |
| 8 Double Strike Flash 2Hz | 8 Rotating: Fast 2 | 8 Static |
| 9 Alternate Side Flash 1:1 2Hz | 9 Rotating: Fast 2 | 9 Static |

| Order Code | Voltage | Current |
|------------|-------------|--------------|
| ESS7512* | 10-50VDC | 400mA @24VDC |
| ESS7513* | 24VAC ±10% | 380mA |
| ESS7522* | 115VAC ±10% | 140mA |
| ESS7532* | 230VAC ±10% | 70mA |

*Specify colour A = Amber, B = Blue, G = Green, R = Red, Y= Yellow

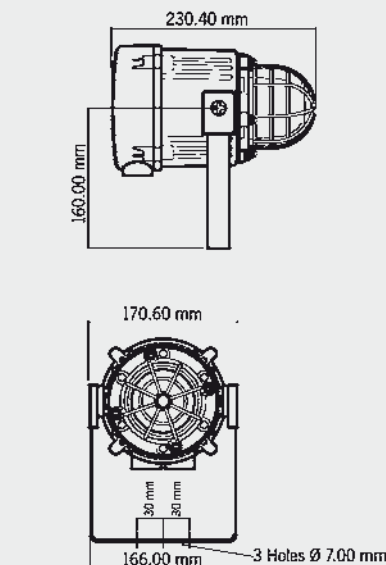

MCA112-05



- Electronic sounder with xenon beacon
- 45 tones, includes ISO tones to Australian Standards
- Automatic synchronisation on multi-sounder systems**
- Automatic synchronised flash or flip-flop alternating mode**
- Sounder and beacon controlled independently
- Volume control (122dB max. - 113dB min.)
- Three stage alarm (reverse polarity stage switching on DC units)
- IP67

Specifications:

| | |
|-------------------|--------------------------------------|
| Sound output: | Max 119dB @ 1m |
| Sound frequency: | 45 tones see tone list on page 11-39 |
| Flash energy: | 5J |
| Light output: | 51cd(e) |
| Flash rate: | 60fpm |
| Protection: | IP67 |
| Temp rating (°C): | -25 to +55 |
| Cable entry: | 2 x M20 |
| Rating: | Continuous |
| Construction: | Flame Retardant ABS |

**Synchronisation requires sounders to be connected to the same supply

| Order Code | Voltage | Current Sounder | Current Beacon | Weight (kg) |
|------------|-------------|-----------------|----------------|-------------|
| ESS5410* | 20-28VDC | 200mA @ 24VDC | 300mA | 3.00 |
| ESS5413* | 24VAC±10% | 500mA | 350mA | 3.50 |
| ESS5415* | 42-54VDC | 120mA @ 48VDC | 180mA | 3.00 |
| ESS5420* | 115VAC ±10% | 100mA | 140mA | 3.50 |
| ESS5430* | 230VAC ±10% | 60mA | 55mA | |

*Specify colour A = Amber, B = Blue, G = Green, R = Red, Y = Yellow

MCA112-L1



- Electronic sounder with multifunction LED beacon
- 45 tones, includes ISO tones to Australian Standards
- Automatic synchronisation on multi-sounder systems**
- Sounder and beacon controlled independently
- Volume control (122dB max. - 113dB min.)
- Three stage alarm (reverse polarity stage switching on DC units)
- IP67

Specifications:

| | |
|-------------------|--|
| Sound output: | Max 119dB @ 1m |
| Sound frequency: | 45 tones see tone list on page 11-39 |
| Light output: | 11cd(e) |
| Flash rate: | Multifunction - see list on page 11-54 |
| Protection: | IP67 |
| Temp rating (°C): | -25 to +55 |
| Cable entry: | 2 x M20 |
| Rating: | Continuous |
| Construction: | Flame Retardant ABS |

**Synchronisation requires sounders to be connected to the same supply

| Order Code | Voltage | Current Sounder | Current Beacon | Weight (kg) |
|------------|-------------|-----------------|----------------|-------------|
| ESS5412* | 10-30VDC | 200mA @ 24VDC | 400mA @ 24VDC | 3.00 |
| ESS5414* | 24VAC±10% | 500mA | 380mA | 3.50 |
| ESS5416* | 35-60VDC | 120mA @ 48VDC | 210mA | 3.00 |
| ESS5422* | 115VAC ±10% | 100mA | 135mA | 3.50 |
| ESS5432* | 230VAC ±10% | 60mA | 65mA | |

*Specify colour A = Amber, B = Blue, G = Green, R = Red, Y = Yellow

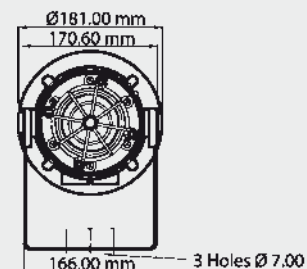
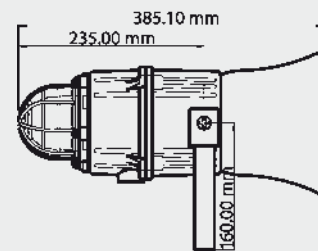

MA112



- Electronic sounder up to 119dB
- 45 tones, includes ISO tones to Australian Standards
- Automatic synchronisation on multi-sounder systems*
- Volume control (112dB max. - 100dB min on tone 2)
- Three stage alarm (reverse polarity stage switching on DC units)**
- IP67

| Order Code | Voltage | Current | Weight (kg) |
|------------|-------------|---------------|-------------|
| ESS5312 | 10-30VDC | 200mA @ 24VDC | 2.50 |
| ESS5313 | 24VAC±10% | 500mA | 3.00 |
| ESS5316 | 35-60VDC | 120mA @ 48VDC | 2.50 |
| ESS5321 | 115VAC ±10% | 100mA | 3.00 |
| ESS5331 | 230VAC ±10% | 60mA | |

Specifications:

Sound output: Max 119dB @ 1m
 Sound frequency: 45 tones see tone list on page 11-39
 Protection: IP67
 Temp rating (°C): -25 to +55
 Cable entry: 2 x M20
 Rating: Continuous
 Construction: Flame retardant ABS

*Synchronisation requires sounders to be connected to the same supply

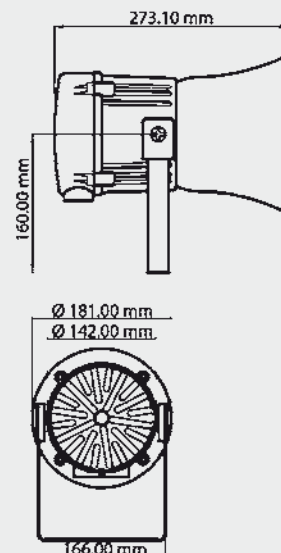

MA121



- Electronic sounder up to 126dB
- 45 tones, includes ISO tones to Australian Standards
- Automatic synchronisation on multi-sounder systems*
- Volume control (121dB Max. - 112dB min. on tone 2)
- Three stage alarm (reverse polarity stage switching on DC units)**
- IP67

| Order Code | Voltage | Current | Weight (kg) |
|------------|-------------|---------------|-------------|
| ESS5212 | 10-30VDC | 950mA @ 24VDC | 2.50 |
| ESS5213 | 24VAC±10% | 1.00A | 3.00 |
| ESS5216 | 35-60VDC | 600mA @ 48VDC | 2.50 |
| ESS5221 | 115VAC ±10% | 240mA | 3.00 |
| ESS5231 | 230VAC ±10% | 120mA | |

Specifications:

Sound output: Max 126dB @ 1m
 Sound frequency: 45 tones see tone list on page 11-39
 Protection: IP67
 Temp rating (°C): -25 to +55
 Cable entry: 2 x M20
 Rating: Continuous
 Construction: Flame retardant ABS

*Synchronisation requires sounders to be connected to the same supply

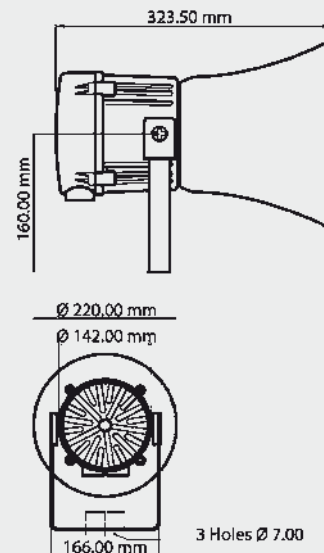

ML15

- 15W loud speaker
- Available with 8Ω or 16Ω coil or with 100V line transformer
- 100V line tapplings
- IP67



| Order Code | Impedance | Weight (kg) |
|------------|-----------|-------------|
| ESS5608 | 8 ohm | 2.20 |
| ESS5616 | 16 ohm | |
| ESS5620 | 100V line | 2.60 |

Specifications:

Power: 15W RMS
Sound output: Max 118dB @ 15W @1m
Low impedance: 8 ohm or 16 ohm
100V line tapplings: 15W/7.5W/3W/1W
Dispersion: 120° @ 1kHz, 32° @4kHz
Frequency range: 400Hz to 8kHz
Line monitoring: 2.2uF (transformer version)
 470uF (impedance version)

Protection: IP67
Temp rating (°C): -25 to +55
Cable entry: 2 x M20
Rating: Continuous
Construction: Flame retardant ABS

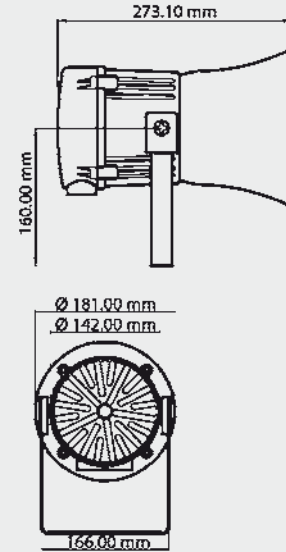

ML25

- 25W loud speaker
- Available with 8Ω or 16Ω coil or with 100V line transformer
- 100V line tapplings
- IP67



| Order Code | Impedance | Weight (kg) |
|------------|-----------|-------------|
| ESS5708 | 8 ohm | 2.50 |
| ESS5716 | 16 ohm | |
| ESS5720 | 100V line | 3.00 |

Specifications:

Power: 25W RMS
Sound output: Max 121dB @ 15W @1m
Low impedance: 8 ohm or 16 ohm
100V line tapplings: 25W/12.5W/6W/2W
Dispersion: 130° @ 1kHz, 32° @4kHz
Frequency range: 300Hz to 8kHz
Line monitoring: 2.2uF (transformer version)
 470uF (impedance version)

Protection: IP67
Temp rating (°C): -25 to +55
Cable entry: 2 x M20
Rating: Continuous
Construction: Flame retardant ABS

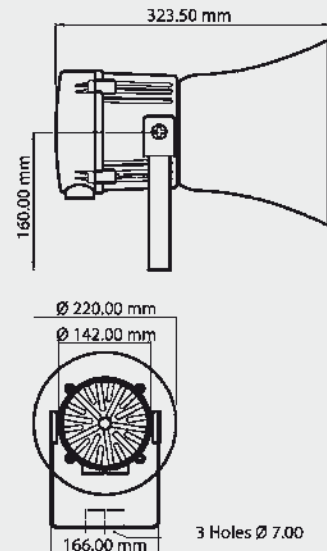

B450

- Traffic control, for loading bays, doors and gates
- Filament or LED bulbs, and LED array versions
- Supplied as individual units or in sets of 2 or 3
- Customised control options available
- IP65



Specifications:

| | |
|-------------------|--|
| Protection: | IP65 |
| Duty: | Continuous |
| Temp rating (°C): | -25 to +50 |
| Cable entry: | 2 x M20 |
| Construction: | Polycarbonate (powder coated steel boxes) |
| Weight: | 0.37kg (individual units) |

| Order Code | Voltage | Current |
|------------------------------------|--------------------------------------|---------|
| B450TLA – LED array 89cd(e) | | |
| ESSB450TLA030B* | 10-30VDC | 130mA |
| ESSB450TLA230B* | 90-230VAC | 10-30mA |
| ESSB450B2TLA030B** | 2 x 10-30VDC signals mounted on box | |
| ESSB450B2TLA230B** | 2 x 90-230VAC signals mounted on box | |
| ESSB450B3TLA030B*** | 3 x 10-30VDC signals mounted on box | |
| ESSB450B3TLA230B*** | 3 x 90-230VAC signals mounted on box | |

*Specify colour A = Amber, G = Green, R = Red (top to bottom)

B450TSB – filament or LED bulbs 32cd(e) E27 25W max**

| | | |
|---------------------|----------------------------|---------|
| ESSB450TSB250B* | 12-240VAC/DC | 25W max |
| ESSB450B2TSB250B** | 2 x signals mounted on box | |
| ESSB450B3TSB250B*** | 3 x signals mounted on box | |

B450TDB – filament 24cd(e) 2 x E14 15W max**

| | | |
|---------------------|----------------------------|-------------|
| ESSB450TDB250B* | 12-240VAC/DC | 2 x 15W max |
| ESSB450B2TDB250B** | 2 x signals mounted on box | |
| ESSB450B3TDB250B*** | 3 x signals mounted on box | |

*Specify colour A = Amber, B = Blue, C = Clear, G = Green, R = Red (top to bottom)

**Bulbs must be ordered separately

Note: Box dimensions – 2 light 400h x 200w x 120d
3 light 500h x 200w x 120d

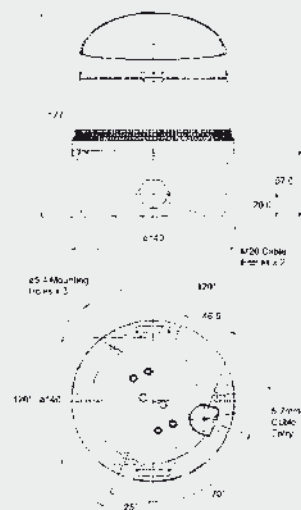

Dimensions in mm

Mounting Bracket

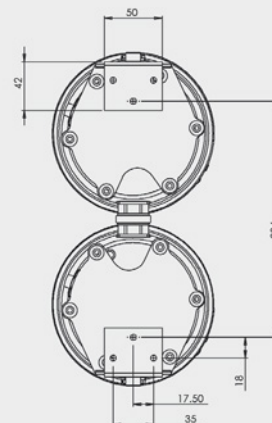
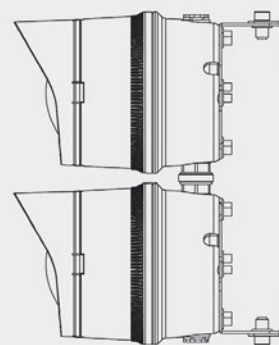

Accessories and Spare Parts

| Order Code | Description |
|-----------------|-------------------------------------|
| ESS9BMB450TS | Mounting bracket for single units |
| ESS9BMB450TM | Mounting bracket for multiple units |
| ESS9BGS***25C27 | E27 Bulb 25W |
| ESS9B1015*** | E14 Bulb 15W |

*Specify voltage 024 = 24V, 110 = 110V, 240 = 240V

100mm Traffic Lights



- 100mm LED traffic light modules and housings
- Modules with 31 High output LED's
- 80,000 hour life (approximate)
- 1, 2 and 3 aspect housing
- 24VDC and 85-265VAC power supply options
- IP65
- Meets EN12368
- Customised control options available

| Order Code | Aspect/Colour | Voltage | Weight (kg) |
|------------|---------------|---------|-------------|
|------------|---------------|---------|-------------|

2 and 3 aspect traffic light

| | | | |
|------------------|---------------------------|------------|------|
| 25JD1003251DCRG | 2 aspect Red/Green | 24VDC | 3.14 |
| 25JD1003251ACRG | 2 aspect Red/Green | 85-265 VAC | 3.14 |
| 25JD1003351DCRGY | 3 aspect Red/Yellow/Green | 24VDC | 4.2 |
| 25JD1003351ACRGY | 3 aspect Red/Yellow/Green | 85-265 VAC | 4.2 |

100mm LED module only

| | | | |
|-----------------|-------------------|------------|------|
| 25DXJD100554DCR | Red LED module | 24VDC | 0.08 |
| 25DXJD100554DCA | Yellow LED module | 24VDC | 0.08 |
| 25DXJD100554DCG | Green LED module | 24VDC | 0.08 |
| 25DXJD100554ACR | Red LED module | 85-265 VAC | 0.08 |
| 25DXJD100554ACA | Yellow LED module | 85-265 VAC | 0.08 |
| 25DXJD100554ACG | Green LED module | 85-265 VAC | 0.08 |

Blue and White LED modules are available on request subject to minimum order quantities

Specifications:

| | |
|--------------------|--|
| Light source: | 31 x 5mm LED |
| Light output: | Red/Yellow >150Cd(e) Green >220Cd(e) |
| Wave length: | Red- 620-630 nm Yellow – 590-594 nm Green – 503-508 nm |
| Power consumption: | <5W |
| Protection: | IP65 |
| Duty: | Continuous |
| Temp rating (°C): | -40 to +80 |
| Cable entry: | Trough housing bracket |
| Construction: | UV resistant polycarbonate |

Compliance and standards:

Compliance with CE, EN12368, RoHS

2 Aspect

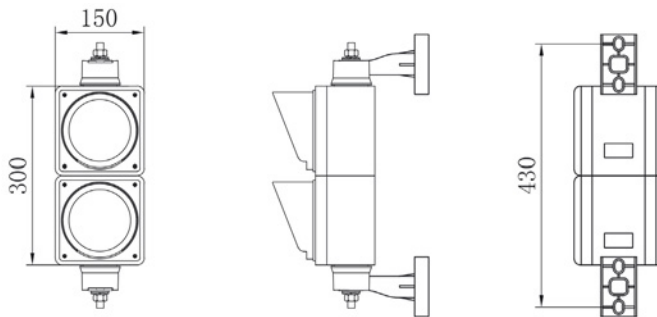

Dimensions in mm

3 Aspect

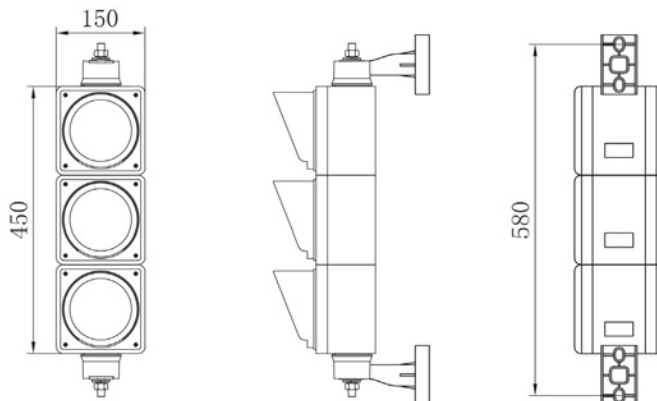

200mm Traffic Lights



- 200mm LED traffic light modules and housings
- Modules with 31 High output LED's
- 80,000 hour life (approximate)
- 1, 2 and 3 aspect housing
- 24VDC and 85-265VAC power supply options
- IP65
- Meets EN12368
- Customised control options available

| Order Code | Aspect/Colour | Voltage | No. LED's | Weight (kg) |
|------------|---------------|---------|-----------|-------------|
|------------|---------------|---------|-----------|-------------|

2 and 3 aspect traffic light

| | | | | |
|------------------|---------------------------|------------|----------|-----|
| 25JD2003251DCRG | 2 aspect Red/Green | 24VDC | 90/90 | 5.5 |
| 25JD2003251ACRG | 2 aspect Red/Green | 85-265 VAC | 90/90 | 5.5 |
| 25JD2003351DCRGY | 3 aspect Red/Yellow/Green | 24VDC | 90/90/90 | 8.0 |
| 25JD2003351ACRGY | 3 aspect Red/Yellow/Green | 85-265 VAC | 90/90/90 | 8.0 |

200mm LED module only

| | | | | |
|-----------------|------------------------------|------------|-------|------|
| 25DXJD200552DCR | Red LED module | 24VDC | 90 | 0.75 |
| 25DXJD200552DCY | Yellow LED module | 24VDC | 90 | 0.75 |
| 25DXJD200552DCG | Green LED module | 24VDC | 90 | 0.75 |
| 25DXJD200552ACR | Red LED module | 85-265 VAC | 90 | 0.75 |
| 25DXJD200552ACY | Yellow LED module | 85-265 VAC | 90 | 0.75 |
| 25DXJD200552ACG | Green LED module | 85-265 VAC | 90 | 0.75 |
| 25DXCD200552ADC | Red X LED module | 24VDC | 45 | 0.75 |
| 25DXFX200552DCR | Red LED module | 24VDC | 36 | 0.75 |
| 25DXFX200552DCY | Yellow LED module | 24VDC | 36 | 0.75 |
| 25DXFX200552DCG | Green LED module | 24VDC | 36 | 0.75 |
| 25DXFX200552ACR | Red LED module | 85-265 VAC | 36 | 0.75 |
| 25DXFX200552ACY | Yellow LED module | 85-265 VAC | 36 | 0.75 |
| 25DXFX200552ACG | Green LED module | 85-265 VAC | 36 | 0.75 |
| 25DXCD200552DC | Red X/Green arrow LED module | 24VDC | 45/36 | 0.75 |
| 25DXCD200552AC | Red X/Green arrow LED module | 85-265 VAC | 45/36 | 0.75 |
| 25DXRX200552DCG | Walking green man module | 24VDC | 96 | 0.75 |
| 25DXRX200552ACG | Walking green man module | 85-265 VAC | 96 | 0.75 |
| 25DXRX200552DCR | Red man module | 24VDC | 66 | 0.75 |
| 25DXRX200552ACR | Red man module | 85-265 VAC | 66 | 0.75 |

Polycarbonate empty housing

| | | |
|------------|--|------|
| 25PCH200 | 1 aspect housing with mounting accessories | 2.2 |
| 25PCH200X2 | 2 aspect housing with mounting accessories | 4.0 |
| 25PCH200X3 | 3 aspect housing with mounting accessories | 5.75 |

To order non-standard combinations or arrows, crosses, and pedestrian symbols, order the modules and housings separately. Blue, White, bicycle and countdown modules are available on request subject to minimum order quantities.

Specifications:

| | |
|--------------------|--|
| Light source: | 6.5mm LEDs |
| Light output: | Red >400Cd(e) Green/Yellow >600Cd(e) |
| Wave length: | Red- 620-630 nm Yellow – 590-594 nm Green – 503-508 nm |
| Power consumption: | <9W |
| Protection: | Housing - IP54 (modules IP65) |
| Duty: | Continuous |
| Temp rating (°C): | -40 to +80 |
| Cable entry: | Trough housing bracket |
| Construction: | UV resistant polycarbonate |

Compliance and standards:

Compliance with CE, EN12368, RoHS

2 Aspect

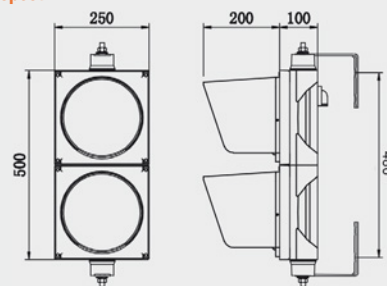

Dimensions in mm

3 Aspect

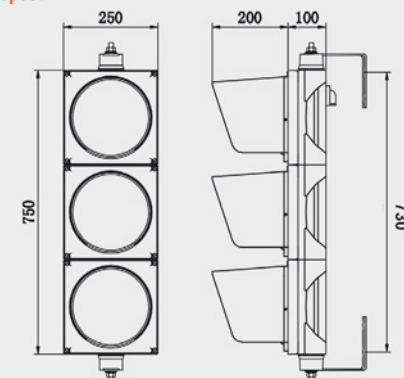

LEDEO Low Intensity Type B



29LBIB11..C

- Steady light red LED beacon for aircraft obstruction warning on obstacles up to 45m height
- Type B > 32Cd meets ICAO and CASA standards for low intensity obstacle lights (note where lighting is a mandatory requirement by CASA a twin fitting must be used)
- Life time > 10 years
- Low current consumption < 6W
- Integrated photocell and alarm contact
- Integrated lightning protection
- Box mounting version allows light position adjustment
- IP68
- Options include, battery backup, solar and control options.



29LBIB11..Z



29LBIBTW..

| Order Code | Description | Voltage | Current | Weight (kg) |
|------------|------------------------------------|-------------|---------|-------------|
| 29LBIB11AC | Single light type B | 24VDC | 200mA | 1.5 |
| 29LBIB11MC | Single light type B | 110-230 VAC | 23mA | 1.5 |
| 29LBIB11AZ | Single light type B box mount | 24VDC | 210mA | 7 |
| 29LBIB11MZ | Single light type B box mount | 240VAC | 23mA | 7 |
| 29LBIBTWB | Twin light type B box mount (CASA) | 48VDC | 120mA | 8 |
| 29LBIBTWMB | Twin light type B box mount (CASA) | 110-230 VAC | 280mA | 8 |

Specifications:

Light source: Red LEDs
 ≥ 32Cd(p)
 Light intensity: 360° horizontal, 10° vertical
 IP68
 Protection: 240km/h
 Wind rating: Continuous
 Duty: -55 to +55
 Temp rating (°C): 2m cable provided
 Cable entry: (2 x M20 entries on box version)
 Mounting: M6 bolts (M8 screw for box version)
 Mounting box dimensions: 325 x 246 x 160mm
 Construction: Aluminium body, polycarbonate lens with bird spike, zamak box.

Compliance and standards:

Compliance with CE, EN60947-1, ICAO, FAA, CASA

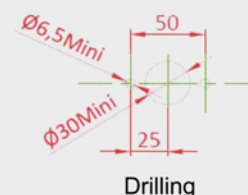
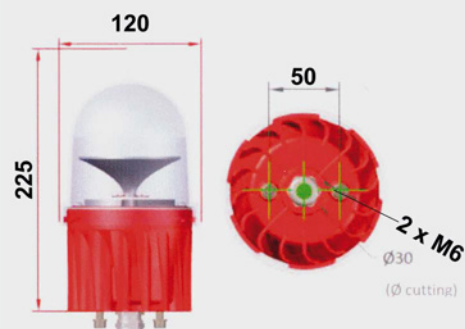

Dimensions in mm

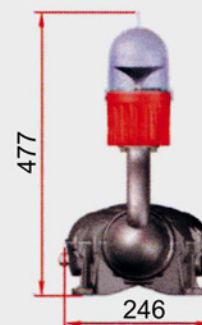
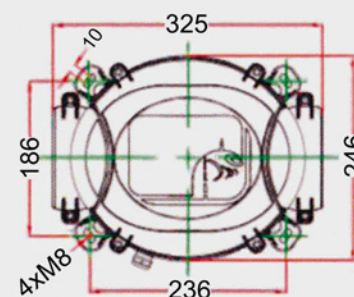

Accessories and Spare Parts

| Order Code | Description |
|------------|---|
| 29LBIBPOT | Support bracket for single light 316 SS |

LEDEO Medium Intensity Type A/B/C

- Type A –flashing white
Type B - flashing red
Type C- steady red
- For aircraft obstruction warning on obstacles between 45m and 150m height
- Meets ICAO and CASA standards for medium intensity obstacle lights
- Life time > 10 years
- Low current consumption < 90W (average 45W)
- Integrated photocell and alarm contact
- Wired synchronisation with adjacent beacons.
- Integrated lightning protection
- Box mounting version allows light position adjustment.
- IP68
- Options include, battery backup, solar and control options.



Type A



Type B and C

| Order Code | Description | Voltage | Current | Weight (kg) |
|------------|------------------------------------|-------------|---------|-------------|
| 29LMIA11BB | Type A white flashing 2000/20000Cd | 48VDC | 4.2A | 17 |
| 29LMIA11MB | Type A white flashing 2000/20000Cd | 110-230 VAC | 0.9A | 17 |
| 29LMIB11BB | Type B red flashing 2000Cd (night) | 48VDC | 1.3A | 16 |
| 29LMIB11MB | Type B red flashing 2000Cd (night) | 110-230 VAC | 300mA | 16 |
| 29LMIC11BB | Type C red steady 2000Cd (night) | 48VDC | 350mA | 16 |
| 29LMIC11MB | Type C red steady 2000Cd (night) | 110-230 VAC | 300mA | 16 |

Specifications:

Light source: White or Red LEDs
 Light intensity: Type A – Flashing 20,000Cd day/2,000Cd night (white LED)
 Flash rate- 20-60fpm
 Type B – Flashing 2,000Cd night (red LED) Flash rate- 20-60fpm
 Type C – Steady 2,000Cd night (red LED)
 360° horizontal, 3° vertical
 IP68
 Protection: IP68
 Wind rating: 240km/h
 Duty: Continuous
 Temp rating (°C): -55 to +55
 Cable entry: 2 x M20
 Mounting: M6 bolts (M8 screw for box version)
 Mounting box dimensions: 325 x 246 x 160mm
 Construction: Aluminium body, polycarbonate lens, zamak box.

Compliance and standards:

Compliance with CE, EN60947-1, ICAO, FAA, CASA

